

QUICK TIPS FOR THE CORRECT USE OF THE SAFETY ARM SYSTEM™

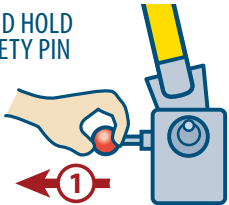

LOWERING THE SAFETY ARM

PULL AND HOLD THE SAFETY PIN



LIFT THE ARM IN ITS ANGLE

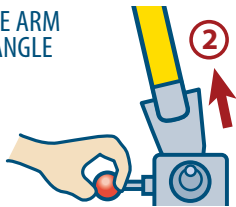

LOWER THE ARM INTO ITS HORIZONTAL POSITION

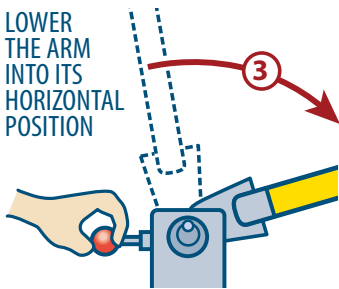

RELEASE THE SAFETY PIN

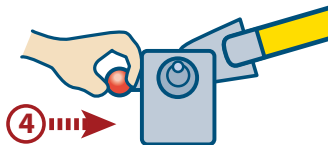

RAISING THE SAFETY ARM

PULL AND HOLD THE SAFETY PIN

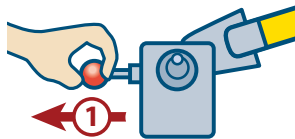

RAISE THE ARM INTO VERTICAL POSITION

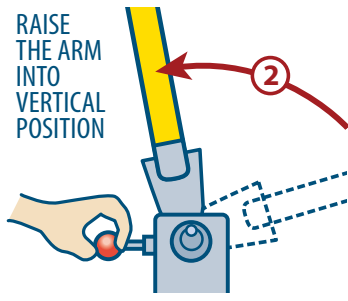

LOWER THE ARM INTO ITS ORIGINAL POSITION

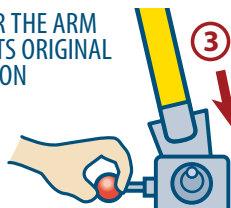

RELEASE THE SAFETY PIN

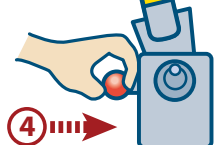

REMOVING THE SAFETY ARM

WITH THE ARM IN VERTICAL POSITION, REMOVE THE LOCK PIN

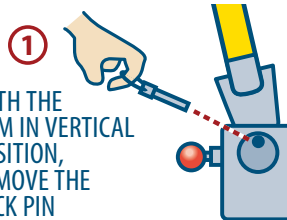

PULL AND HOLD THE SAFETY PIN

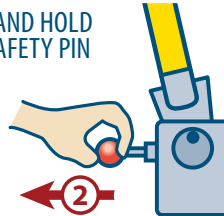

REMOVE THE ARM

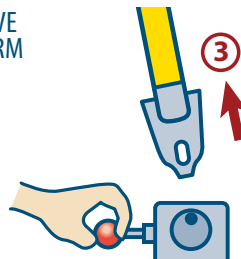

RELEASE THE SAFETY PIN

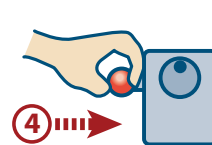

TECHNIMOUNT

EMS™

Always refer to the product user guide for the correct installation and use of the equipment.

© 2021, Technimount EMS Inc. — All Rights Reserved.

Find it here:



info@technimount.com

technimount.com

SAFETY ARM SYSTEM™ CONFIGURATION OPTIONS

INCREASED FLEXIBILITY FOR SPACE MAXIMIZATION AND

MULTIPLE DEVICE USE FOR 911 AND CRITICAL CARE TRANSPORT

Safety Arm Right Side
and IV Pro Adapter™



Safety Arm Right Side
and Safety Arm Angular Left Side



Safety Arm Angular



The **Safety Arm System™** is a secure stretcher mounting system designed to transport various types of medical devices, such as monitors, defibrillators and ventilators, which enables equipment to follow the patient during care.

With multiple configuration options available on the left and right side of the stretcher, the **Safety Arm System™** improves medical device management while increasing safety for EMS providers and patients during EMS and Critical Care Transport.



TECHIMOUNT
EMS™

info@technimount.com
technimount.com