

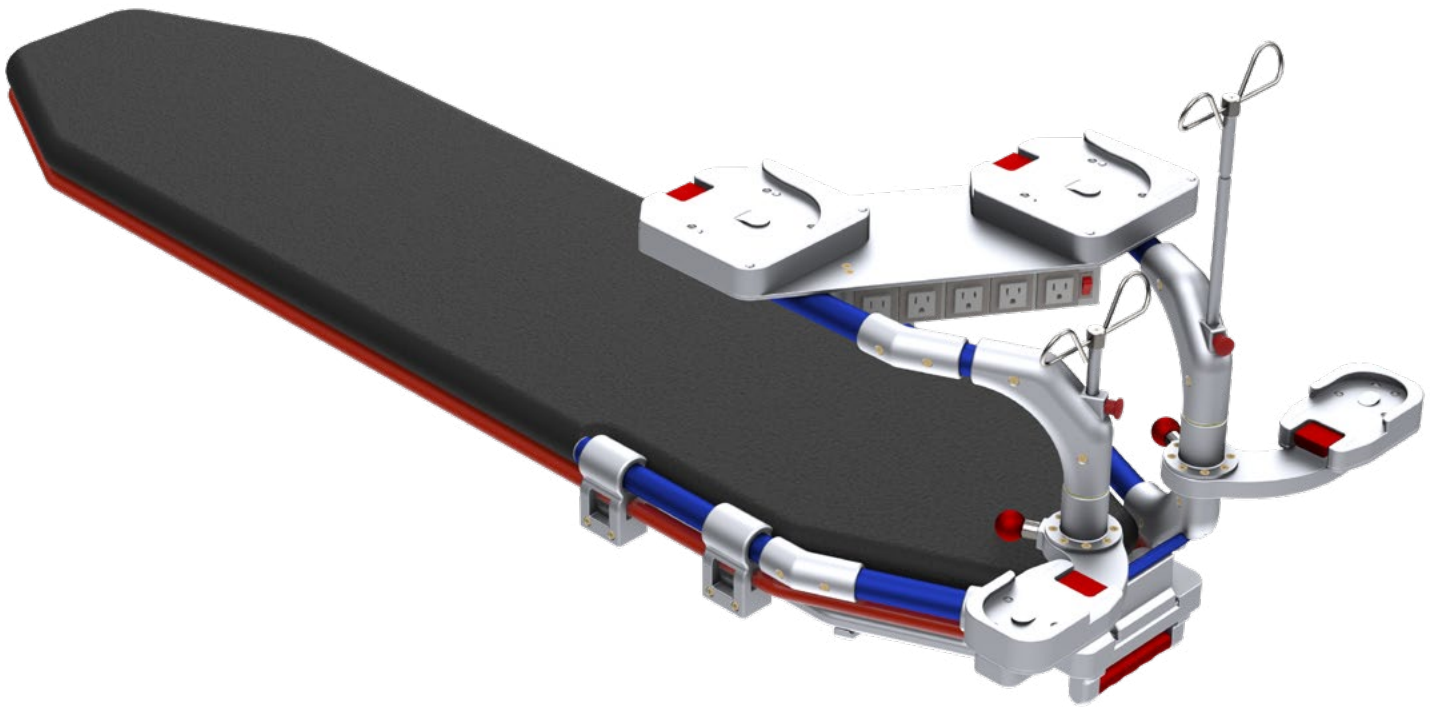

TECHNIMOUNT
EMS™

XTENSION PRO™ ASSISTANT - LP

USER GUIDE



COPYRIGHT

Copyright 2022 Technimount E.M.S. Holding Inc. (Technimount EMS), an affiliated company of Technologies CGC Inc. All Rights Reserved. No part of this publication may be reproduced, transmitted, transcribed, stored in a retrieval system, or translated into any language in any form or by any means without the written permission of Technimount or its affiliate companies.

Trademark Attributions

Xtension Pro™ and Technimount EMS™ are trademarks of Technologies CGC Inc.

ZOLL X Series® is a registered trademark of ZOLL Medical Corporation.

Hamilton T1® is a registered trademark of Hamilton Medical.

LifePort® is a registered trademark of LifePort.

In order to ensure continuous improvements to our products and services, we invite you to communicate your comments to our Customer Service Department at customerservice@technimount.com. See Contact Information.

CONTACT INFORMATION

OFFICE ADDRESS

TECHNIMOUNT E.M.S. HOLDING INC.
3770 Jean Marchand Street, Suite 100-C
Quebec (QC) G2C 1Y6
Canada

info@technimount.com

www.technimount.com

T + 1 581.700.6613

TF + 1 888.639.2758

NOTE:

For any issues with your Technimount product, its components, or for any technical questions during the installation or maintenance, please send an E-mail to techsupport@technimount.com.

Please have the serial number of your Technimount product available (as shown in the figure below) when calling Technimount Customer Service or Technical Support. Include the serial number in all written communications.

SERIAL NUMBER LOCATION

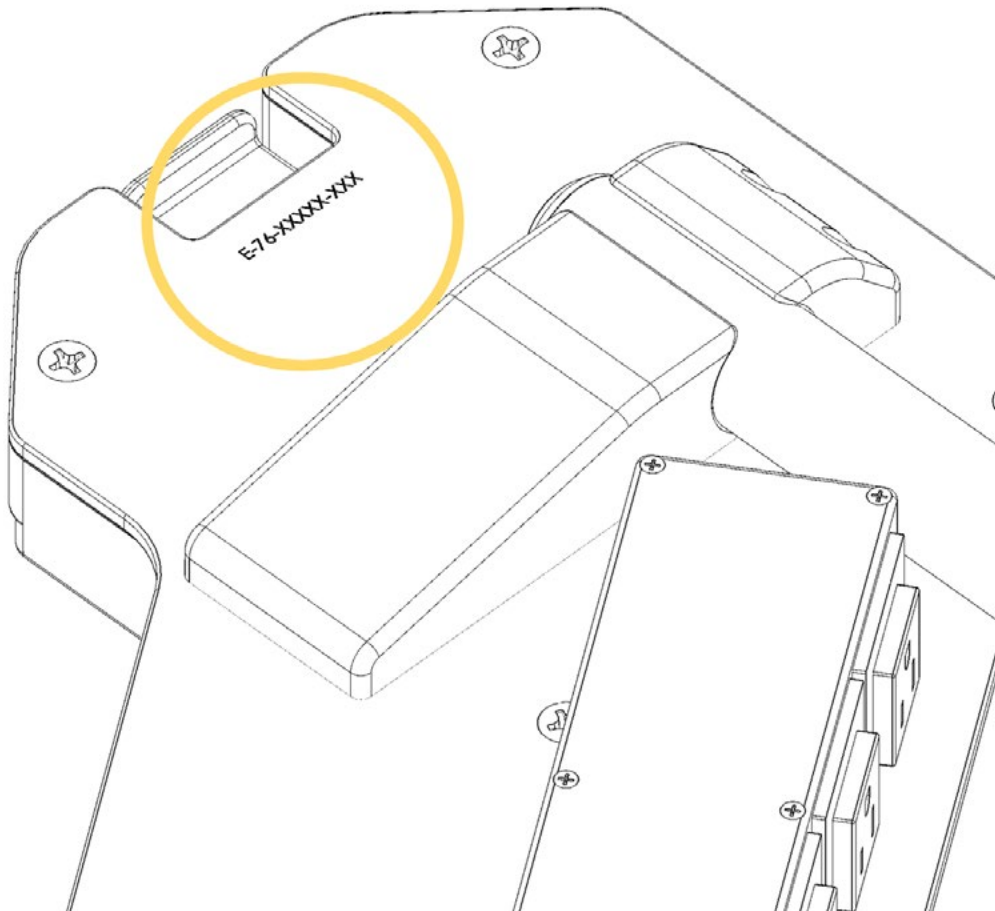

[Return To Table of Contents](#)

TABLE OF CONTENTS

COPYRIGHT	2
CONTACT INFORMATION.....	3
INTRODUCTION	6
PURPOSE OF THE DOCUMENT	6
PRODUCT DESCRIPTION	6
INTENDED USE OF THE PRODUCT	6
EXAMPLE CONFIGURATION FOR THE XTENSION PRO ASSISTANT- LP.....	7
SYMBOLS AND DEFINITIONS	8
WARNING / CAUTION / NOTE.....	9
GRAPHIC ILLUSTRATION & IDENTIFICATION OF COMPONENTS	10
<i>LOCKING HANDLE ASSEMBLY.....</i>	<i>10</i>
<i>CLAMP BLOCK ASSEMBLY.....</i>	<i>11</i>
<i>COT SUPPORT STRUCTURE</i>	<i>12</i>
<i>MOBILE EQUIPMENT SUPPORT STRUCTURE</i>	<i>13</i>
<i>COMPLETE INSTALLATION.....</i>	<i>14</i>
SUMMARY OF SAFETY PRECAUTIONS	17
WARNING/CAUTION/NOTE	17
REMOVING THE PACKAGING FOR INSTALLATION	20
TOOLS REQUIRED FOR INSTALLATION.....	20
INSTALLATION GUIDE	21
IDENTIFICATION OF KITS REQUIRED FOR INSTALLATION	21
INSTALLATION OF THE HANDLE ONTO THE COT	22
INSTALLATION OF THE CLAMP BLOCKS ONTO THE COT.....	23
INSTALLATION OF THE COT SUPPORT STRUCTURE.....	28
INSTALLATION OF THE MOBILE EQUIPMENT SUPPORT STRUCTURE INTO CLAMP BLOCKS LOCATED ON THE COT	29
REMOVING THE MOBILE EQUIPMENT SUPPORT STRUCTURE FROM THE COT.....	31
OPERATION GUIDE	32
INSTALLING A MEDICAL DEVICE WITH A TECHNIMOUNT BRACKET ONTO THE STANDARD SURFACE BASE	32
ROTATING THE BRACKET ON THE STANDARD SURFACE BASE	34
REMOVING A MEDICAL DEVICE FROM THE STANDARD SURFACE BASE	34
INSTALLING A MEDICAL DEVICE ONTO THE SWIVEL MICRO SHELF	35
ROTATING THE BRACKET ON THE SWIVEL MICRO SHELF	35
VIEW OF THE COMPLETE INSTALLATION.....	37
MOUNTING SYSTEM PART NUMBERS.....	38
KITS AND OTHER OPTIONS	38
MAINTENANCE GUIDE.....	39
CLEANING THE XTENSION PRO ASSISTANT- LP.....	39
<i>CLEANING PROCESS.....</i>	<i>39</i>
<i>CLEANING SOLUTIONS.....</i>	<i>39</i>
<i>REMOVAL OF IODINE COMPOUNDS</i>	<i>40</i>
PREVENTIVE MAINTENANCE.....	40
<i>LUBRICATION</i>	<i>40</i>
INSPECTION PROCESS AND SCHEDULE.....	41
<i>MAINTENANCE PROGRAM.....</i>	<i>41</i>

TABLE OF CONTENTS

INSPECTION AND MAINTENANCE RECORD	43
TRAINING RECORD	44
REPLACEMENT PARTS	45
WARRANTY	46
WARRANTY POLICY	46
LIMITED RESPONSIBILITY AND WARRANTY	46
INTERNATIONAL WARRANTY CLAUSE	46
RETURN POLICY	47
RETURN POLICY	47
<i>PRIOR TO 30 DAYS</i>	47
<i>PRIOR 45 DAYS</i>	47
<i>PRIOR 60 DAYS</i>	47
RETURN AUTHORIZATION	47
DAMAGED MERCHANDISE	48
CLAIM PROCESS	48
<i>REQUIRED INFORMATION</i>	48
<i>FINDINGS AND CONCLUSION</i>	48
QUESTIONS ABOUT OUR POLICY	48
FAA /TCCA CERTIFICATION	49

INTRODUCTION

PURPOSE OF THE DOCUMENT

This user guide is designed to assist you with the installation, operation and maintenance of the Xtension Pro Assistant - LP.

PRODUCT DESCRIPTION

The Xtension Pro Assistant - LP is designed for air critical care transport. It facilitates the handling and transport of multiple medical devices and accessories on the LifePort Cot. It facilitates lateral patient transfer from bed to cot and improved accessibility to patients during transport. Its free-standing and anti-stress structure is robust and durable, and complies with FAA, 14 CFR § 23 (applicable sections).

The Xtension Pro Assistant - LP provides a stable and flexible support solution to help the medical team effectively manage equipment during transport. It reduces installation time and effort, and configuration of devices can be adjusted according to the equipment, the air ambulance and desired position.

The Xtension Pro Assistant - LP is compatible with all of Technimount's Bracket Pro Serie® mounting systems with a Standard Bottom Disc and Bottom Micro Disc.

INTENDED USE OF THE PRODUCT

The Xtension Pro Assistant - LP is a mounting solution to securely transport different types of medical devices during air transport. It is designed to be installed as described in this user guide. This equipment is for crews who have received the appropriate training necessary to operate the equipment in the field according to its intended use as outlined in this user guide. Please read this user guide thoroughly before using this equipment. To ensure the safe operation of this equipment, it is recommended to train staff prior to use.

INTRODUCTION

EXAMPLE CONFIGURATION FOR THE XTENSION PRO ASSISTANT - LP

Monitor / Defibrillator

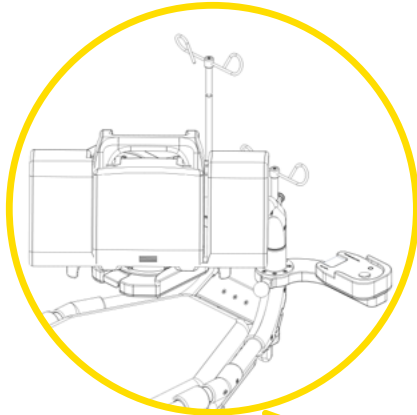

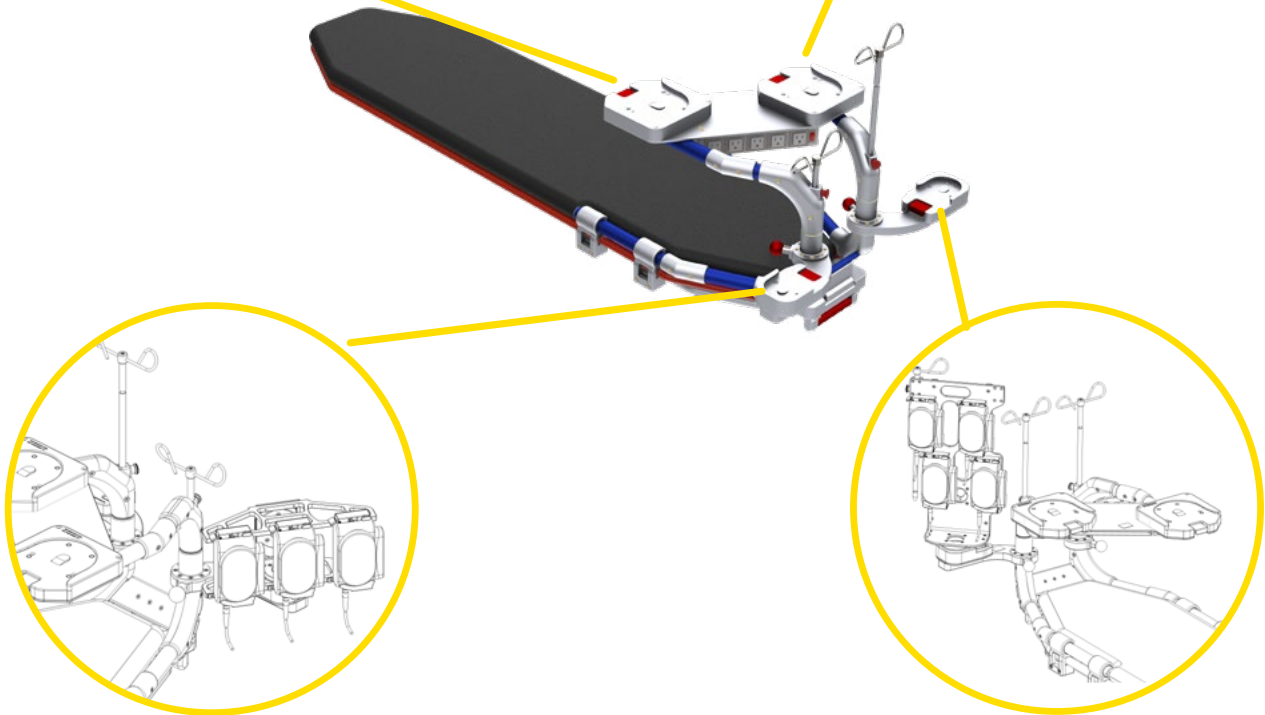
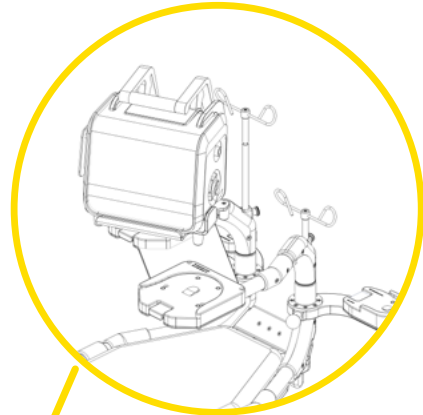

Ventilator



Pumps



Pumps

SYMBOLS AND DEFINITIONS

SYMBOL	DESCRIPTION
	Warning and Caution, special attention is required. Consult accompanying documents
	Safe working load symbol and Load Balance Symbol
	Pinch Point

WARNING / CAUTION / NOTE

The word warning, caution, or note carry special meaning and should be carefully reviewed.

<u>SYMBOL</u>	<u>DESCRIPTION</u>
	<p>WARNING</p> <p>Alerts the reader about a situation which, if not avoided, could result in death or serious injury. It may also describe potential serious adverse reactions and safety hazards.</p>
	<p>CAUTION</p> <p>Alerts the reader of a potentially hazardous situation, which, if not avoided, may result in minor or moderate injury to the user or patient or damage to the equipment or other property. This includes special care necessary for the safe and effective use of the device to avoid damage that may occur as a result of use or misuse.</p>
<p>NOTE</p>	<p>Provides special information about the product.</p>

INTRODUCTION

GRAPHIC ILLUSTRATION & IDENTIFICATION OF COMPONENTS

LOCKING HANDLE ASSEMBLY

Part Number: TCM-121-003

ARTICLE #	DESCRIPTION	QUANTITY
A	Top Handle	1
B	Stainless Steel Flat-Head Screw 10-32 x 1 in	4
C	Bottom Handle	1

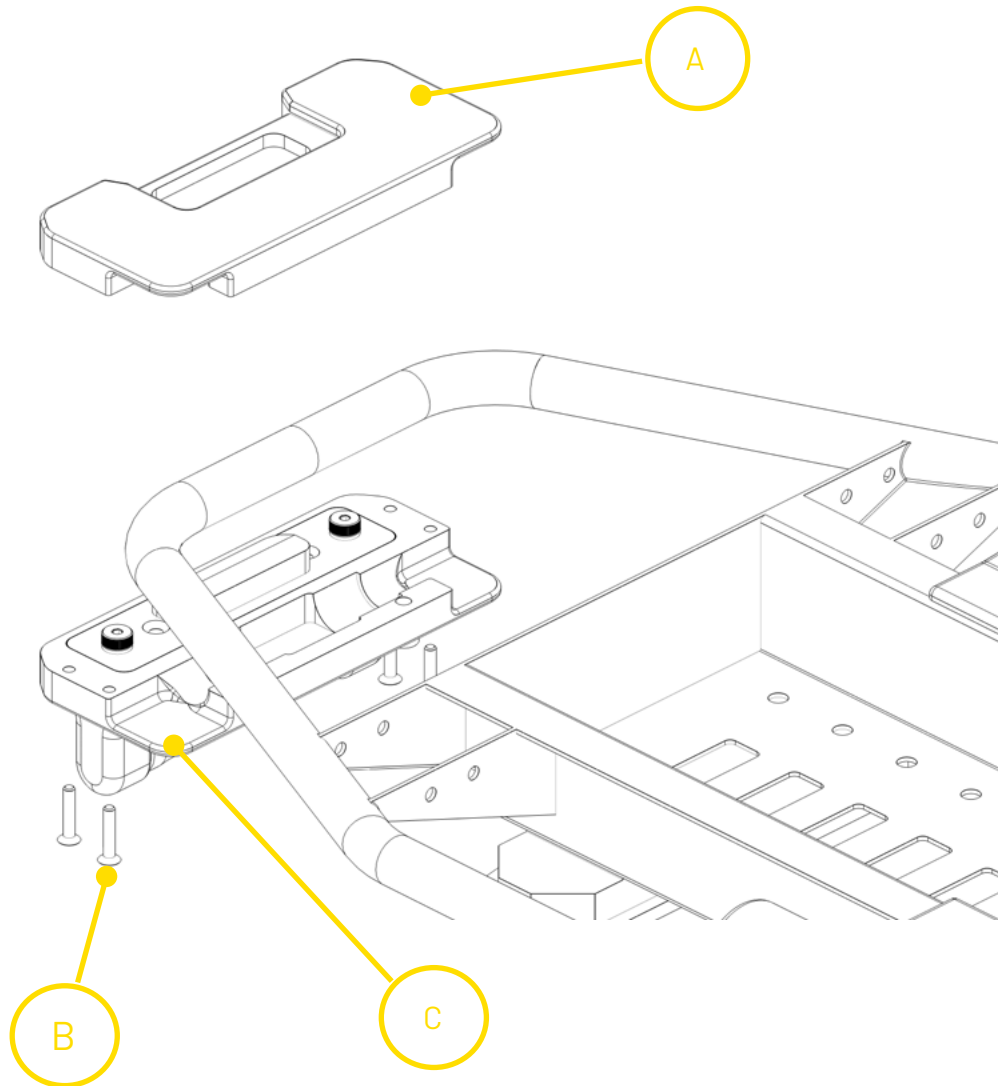

[Return To Table of Contents](#)

INTRODUCTION

GRAPHIC ILLUSTRATION & IDENTIFICATION OF COMPONENTS

CLAMP BLOCK ASSEMBLY

Part Number: TCM-121-004

ARTICLE #	DESCRIPTION	QUANTITY
D	Top Clamp Block Section	4
E	Bottom Clamp Block Section	4
F	8 Cadmium Plated Socket Screws 1/4-20 x 1.25 in (CBA-3)	8

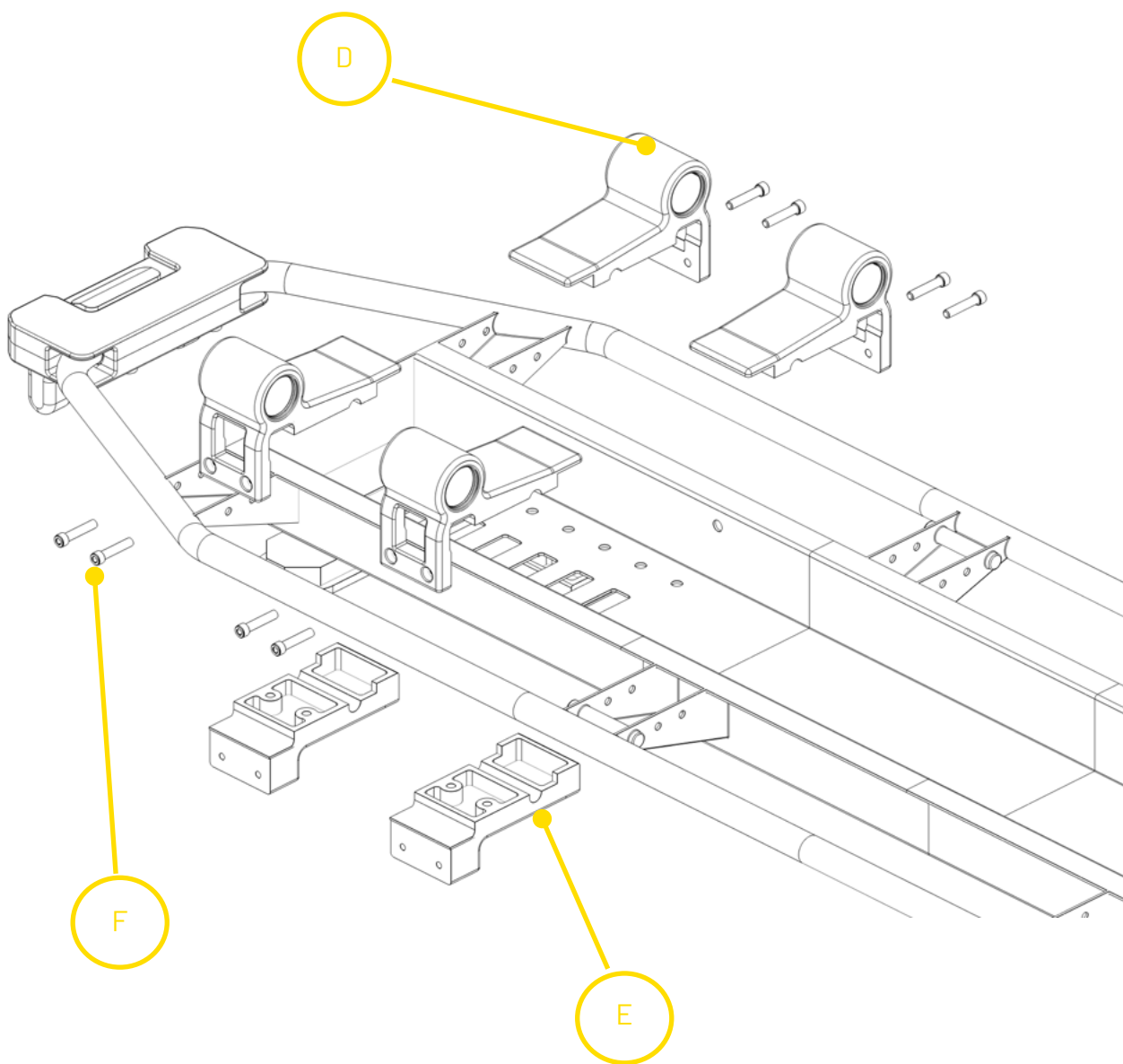

[Return To Table of Contents](#)

INTRODUCTION

GRAPHIC ILLUSTRATION & IDENTIFICATION OF COMPONENTS

COT SUPPORT STRUCTURE

ARTICLE #	DESCRIPTION	QUANTITY
G	Cot Support Structure	1
H	Stainless Steel Socket Head Cap Screw 1/4-20 x 1.5 in	10
I	Spacer	2

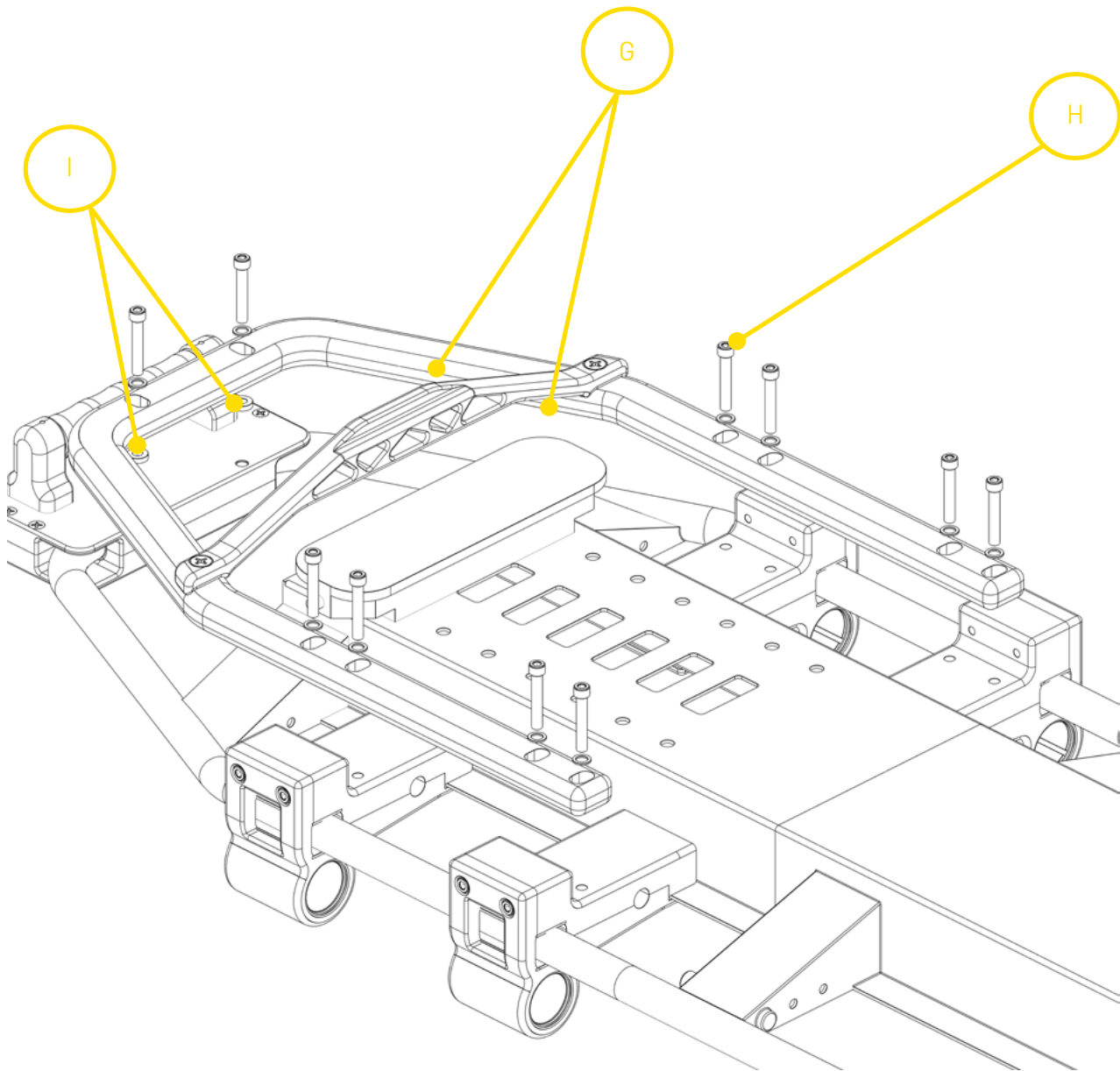

INTRODUCTION

GRAPHIC ILLUSTRATION & IDENTIFICATION OF COMPONENTS

MOBILE EQUIPMENT SUPPORT STRUCTURE

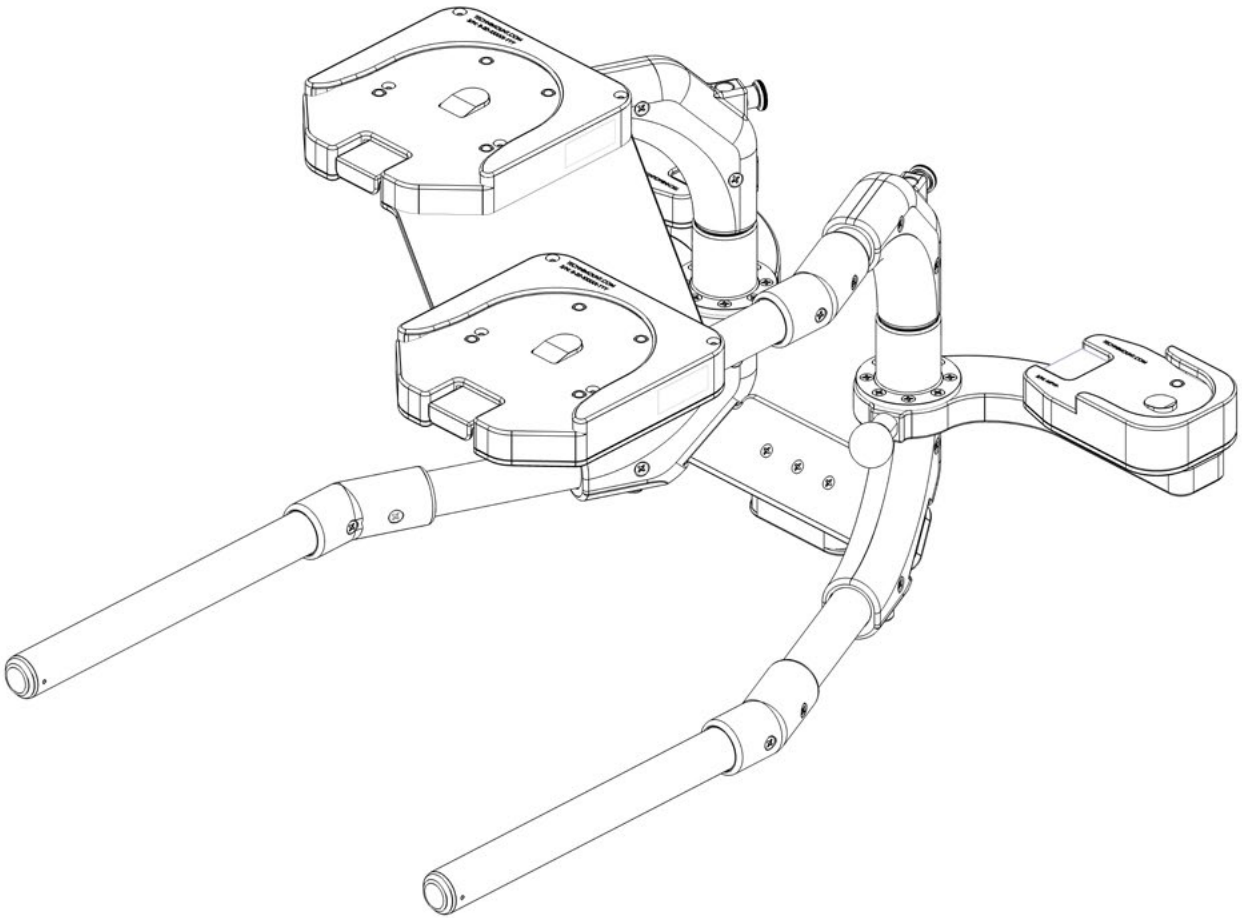

INTRODUCTION

PRODUCT ILLUSTRATION (CONTINUED)

COMPLETE INSTALLATION

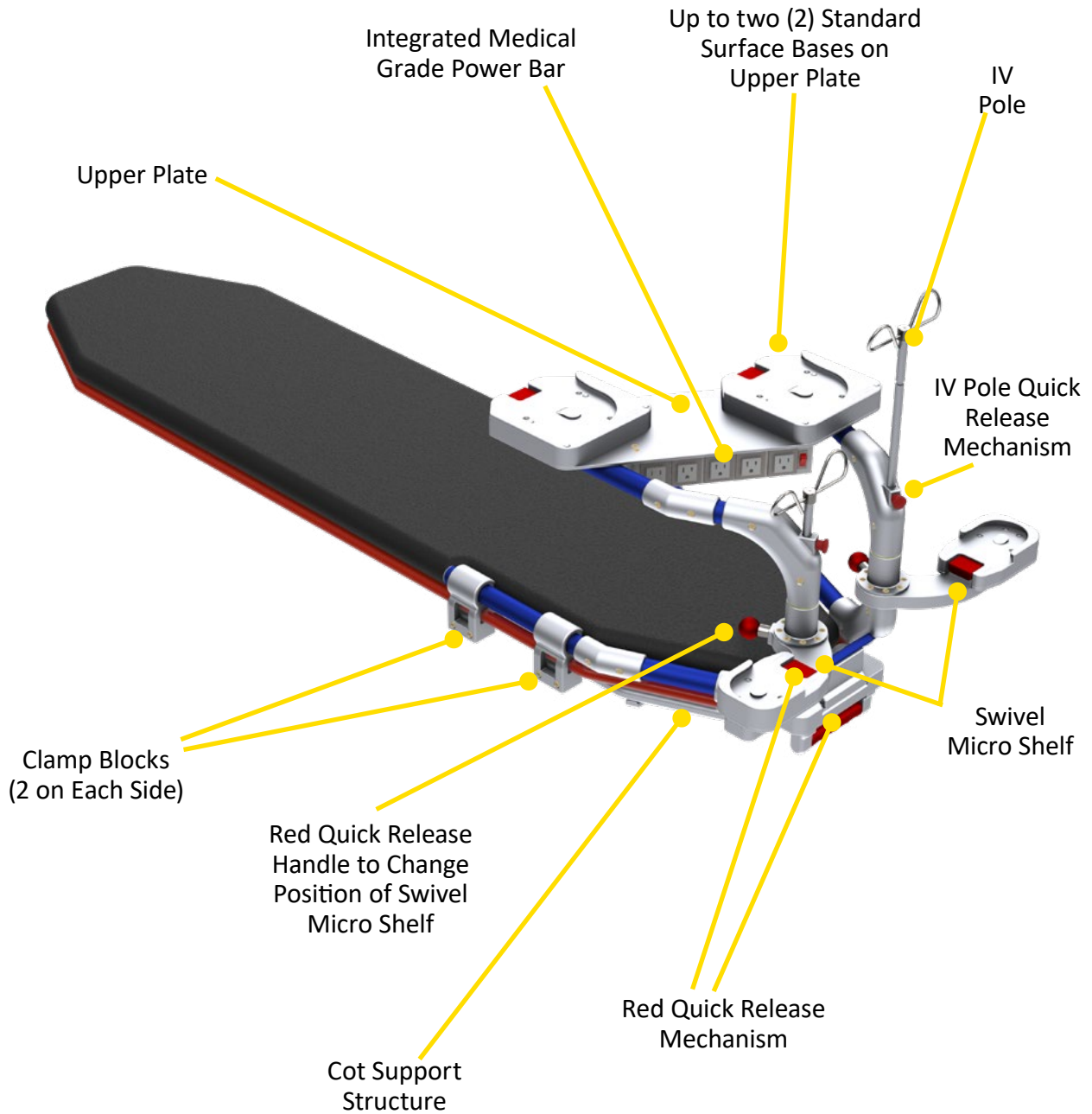

INTRODUCTION

SPECIFICATIONS

Product Name	Xtension Pro™ Assistant - LP
Product Description	Mounting System for Air Critical Care Transport of Multiple Medical Devices on the LifePort Cot.
Compatibility of Stretcher	LifePort Cot
Compatibility of Mounting Systems	Compatible with Technimount's: <ul style="list-style-type: none">• Bracket Pro Serie® Mounting Systems with Standard Bottom Disc and Bottom Micro Disc
Environment of Usage	CCT (Flight)
Product Section Material	<ul style="list-style-type: none">• Main Assembly and Clamp Blocks and Locking Handle: Aluminum 6061-T6• Cot Support Structure: Aluminum 5052-H32
Product Finish	<ul style="list-style-type: none">• Main Assembly: Blue-Anodized Finish• Cot Support Structure, Equipment Support Structure and Clamp Blocks: Silver-Anodized Finish
Temperature of Usage	-31°F to 113°F (-35°C to 45°C)
Certification	Tested in Compliance with: <ul style="list-style-type: none">• FAA, 14 CFR § 23 (applicable sections)
Installation	Locking System - Main Assembly Slides into 4 Clamp Blocks Installed on the Cot Locking Handle located at the Foot End of the Cot is used to Easily Remove the System from the Cot
Features	<ul style="list-style-type: none">• 2 Standard Surface Bases with 360° Rotation• 2 Swivel Micro Shelf with 4 Different Positions• Mobile Equipment Support Structure• 2 integrated IV poles
Positioning Configuration	Optional Mirror Positioning for the Upper Tray - Available Upon Request
System Physical Overall Dimensions	Width 19.0 in (48.3 cm), Depth 28.835 (73.3 cm), Height 20.577 (52.3 cm)
Mobile Equipment Support Structure	Width 19.0 in (48.3 cm), Depth 25.4 in (72.1 cm), Height 18.6 in (47.3 cm)
Mobile Equipment Support Structure Complete System Weight (With brackets, Without Medical Devices)	<ul style="list-style-type: none">• 52.43 lb (132.08 kg)• 68.02 lb (172.72 kg)
Maximum Estimated Loading Capacity	66.0 lb (29.94 kg)
Part Number	<ul style="list-style-type: none">• 1610-00-LPT01 - Xtension Pro Assistant - LP
Other Models and Configuration Options	Contact Technimount for more information or for other options at customerservice@technimount.com

* Product and medical equipment manufacturers names are trademarks™ or registered trademarks® of their respective holders. Technimount does not have a commercial relationship with these medical equipment manufacturers.

[Return To Table of Contents](#)

NOTICE

The Xtension Pro Assistant - LP is tested in compliance with FAA, 14 CFR § 23 (applicable sections). For more information, please contact Technimount Customer Service (customerservice@technimount.com).

Technimount E.M.S. Holding Inc.

C/O: Regulatory Affairs

3770 Jean Marchand Street, Suite 100-C

Quebec (QC) G2C 1Y6

Canada

T + 1 581.700.6613

TF + 1 888.639.2758

technimount.com

info@technimount.com



WARNING

The end user and administrator are responsible to validate regulations and standards for safety in their region, in order to comply with applicable safety regulations. Technimount is not responsible to inform the end user or the administrator of applicable legislation for safety in their area.

SUMMARY OF SAFETY PRECAUTIONS

WARNING/CAUTION/NOTE

Carefully read and strictly follow all Warnings and Cautions listed in this manual. Servicing and maintenance should only be done by qualified personnel.

WARNING

- ✓ Two trained users are needed to manipulate the Xtension Pro Assistant - LP.
- ✓ To avoid injury, hands should be clear of side clamp blocks while inserting the Mobile Equipment Support Structure into the side clamp blocks.
- ✓ Once the Mobile Equipment Support Structure is installed inside the side clamp blocks, ensure the system is securely locked with the handle prior to manipulating or lifting the cot with medical devices and patient on it.
- ✓ Improper usage of the Xtension Pro Assistant - LP system can cause serious injury to the patient or operator. Operate only as described in this user guide.
- ✓ Do not modify the Xtension Pro Assistant - LP, or any of its components. Modifying the product can cause unpredictable operation resulting in injury to the patient or operator.
- ✓ It is the responsibility of the operator of the Xtension Pro Assistant - LP to ensure equipment being used with Technimount products meets the installation specifications. Injury may result if non-compatible products are used with Technimount products.
- ✓ Do not attempt to operate, install or remove the equipment while mobile. Ensure that installation and removal of equipment is done while vehicle or aircraft is immobilized.
- ✓ Failure to properly install and lock medical devices properly within the brackets and bases can cause them to fall during transport and may cause injury to the patient or operator and may damage the product. Always secure each medical device within their respective brackets and mounting system during transport.
- ✓ Practice loading and unloading the medical device (Locked during transportation and unlocking to unload and load medical equipment until operation of the product is fully understood. Improper use may cause injury to the operator.
- ✓ Do not allow untrained staff to assist in the operation of the Xtension Pro Assistant - LP. Untrained technicians/staff can cause injury to the patient or themselves or damage the equipment.
- ✓ Do not sit on the Xtension Pro Assistant - LP during transport, damage to the product could occur, and may result in injury to the patient or operator.
- ✓ Two (2) Operators are required to safely lift the total weight of the Xtension Pro Assistant - LP. Do not remove the system from the cot until all devices have been removed.
- ✓ Do not place any additional equipment or objects on the Xtension Pro Assistant - LP other than approved Technimount systems or components.

SUMMARY OF SAFETY PRECAUTIONS

WARNING/CAUTION/NOTE (CONTINUED)

WARNING (CONTINUED)

- ✓ Always reposition the equipment with care, avoid any improper pushing or violent manipulation, as it may result in unbalanced equipment and may cause injury to the patient or operator and/or damage to the product.
- ✓ To avoid the risk of patient injury or equipment damage, ensure that you properly mount and secure correctly the Xtension Pro Assistant - LP Support Section within the clamp blocks and ensure it is properly locked for transport.
- ✓ Improper maintenance can cause damage to the product. Maintain the Xtension Pro Assistant - LP as described in this user guide. Use only Technimount approved parts and maintenance procedures. Using unapproved parts and procedures could cause unpredictable operation and/or injury and will void the product warranty.
- ✓ Failure to properly clean or dispose of corrosive products will increase the risk of premature damage.

WARNING - PINCH POINT

- ✓ Do not put fingers or hands near the clamp blocks while inserting the Mobile Equipment Support Structure Section as this can be a potential pinch point and may cause injury to the operator.
- ✓ Do not put hands or fingers in between the handle and system while pulling to release as this may cause injury to your fingers or hands.

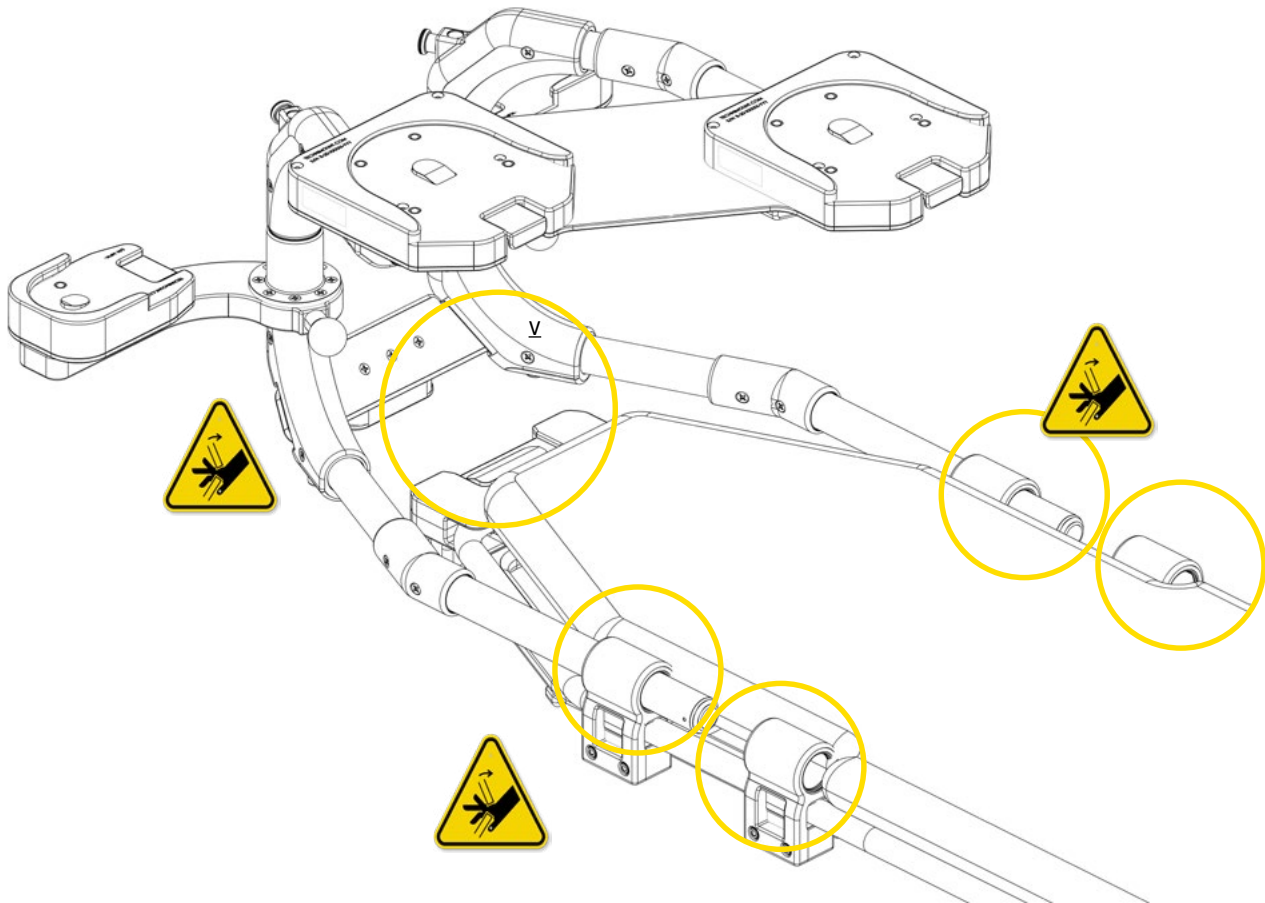

SUMMARY OF SAFETY PRECAUTIONS

WARNING/CAUTION/NOTE (CONTINUED)

CAUTION

- ✓ Only certified technical personnel familiar with the installation and use, should manipulate it. Refer to the Xtension Pro Assistant - LP user guide for all instructions for installing and using the System.
- ✓ Inspect regularly all components on the equipment for any issue and loose screws.
- ✓ Never install other similar mounting systems or brackets without written confirmation by Technimount EMS as these different systems may be from other brands or models and may not be compatible with Technimount systems.

NOTE

- ✓ Some cleaning products are corrosive in nature and may cause damage to the product if used improperly. If such products are used to clean Technimount equipment, the equipment must be rinsed with clean water and thoroughly dried following the cleaning. Failure to properly rinse and dry the mounting systems will leave a corrosive residue on the surface, possibly causing premature corrosion of critical components.
- ✓ When ordering, it is important to identify on which mounting system you need to mount the medical devices.
- ✓ A maintenance program should be established for all Technimount equipment. Preventive maintenance may need to be performed more frequently, based on the level of use of the product. Close attention should be given to safety features (i.e.: screws, quick release mechanisms, and attachment points).
- ✓ Failure to use authorized parts, and lubricants, etc., could cause damage to the equipment and will void the warranty of the product.
- ✓ This user guide should be considered a permanent part of the system and should remain with the product even if the equipment is subsequently sold.
- ✓ Technimount continually seeks advancements in product design and quality. Therefore, while this user guide contains the most current product information available at the time of printing, there may contain minor differences between your mounting system and this user guide. If you have any questions, please contact Technimount Customer Service or Technical Support at + 1 888.639.2758.

REMOVING THE PACKAGING FOR INSTALLATION

1. Unpack boxes and check all items are included for installation.
2. Ensure that all shipping and packaging materials have been properly removed from the product(s) prior to installation.
3. Identify all of the product components and hardware prior to starting the installation.
4. The Mounting Systems must work properly before they are put into service.
5. Refer to the identification of components at the beginning of this user guide if needed.

TOOLS REQUIRED FOR INSTALLATION

Below are the basic tools required for installation. If you have any questions regarding the installation, or need assistance, please contact our Technical Support team at techsupport@technimount.com

- ✓ Allen key 3/16
- ✓ Philips screw driver #2 & #3

NOTE

- ✓ Electrical tools are not recommended, as there is a potential risk of damage to the threads.
- ✓ Technimount provides screws with Nylon Patch for the installation of the locking assembly block.

INSTALLATION GUIDE

IDENTIFICATION OF KITS REQUIRED FOR INSTALLATION

HANDLE ASSEMBLY KIT
TCM-121-003

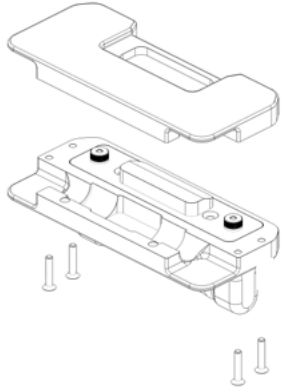

CLAMP BLOCK ASSEMBLY KIT
(4 CLAMP BLOCKS PER COT)
TCM-121-004

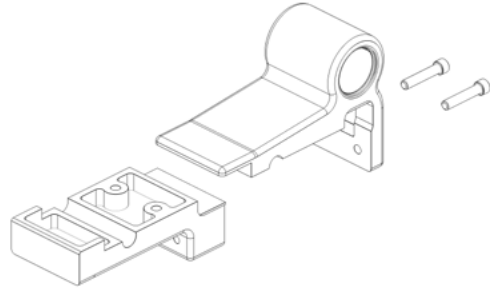

COT SUPPORT STRUCTURE
REF -TCM-121-002

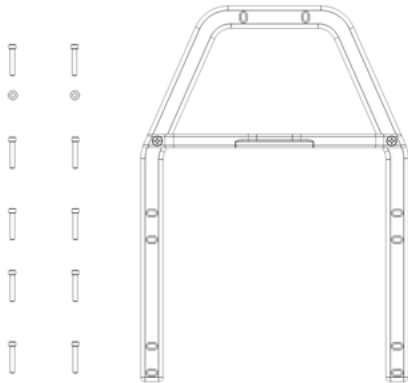

MOBILE EQUIPMENT SUPPORT STRUCTURE
TCM-121-001

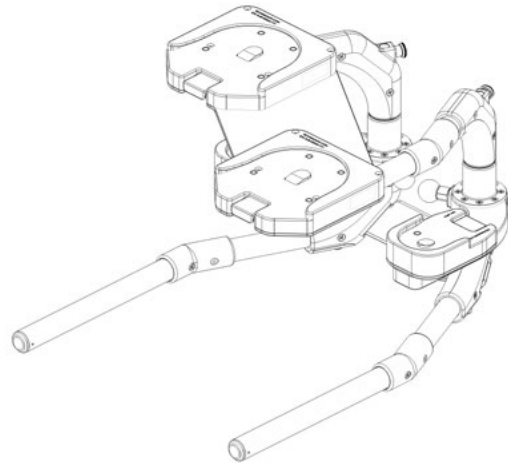

[Return To Table of Contents](#)

INSTALLATION GUIDE

INSTALLATION OF THE HANDLE ONTO THE COT

1. Identify handle components.
2. Identify all 4 Philips Alloy Steel Flat-Head Screws 10-32 x 1 in, needed for the assembly of the handle onto the cot.

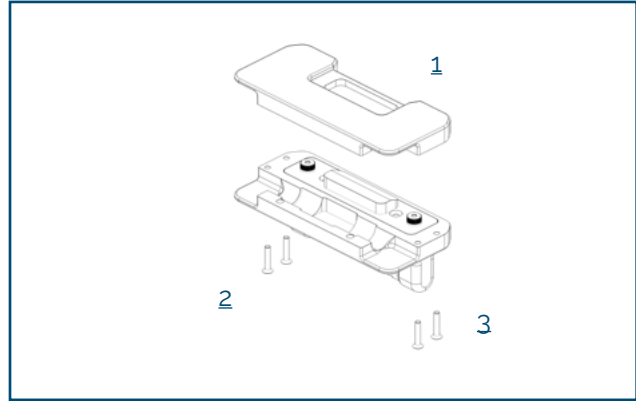

3. Turn the cot on its front to facilitate installation of handle.
4. Place top handle component A on top of the cot and bottom handle component C to fit together.
5. Install all 4 screws B and tighten to hold the handle together.

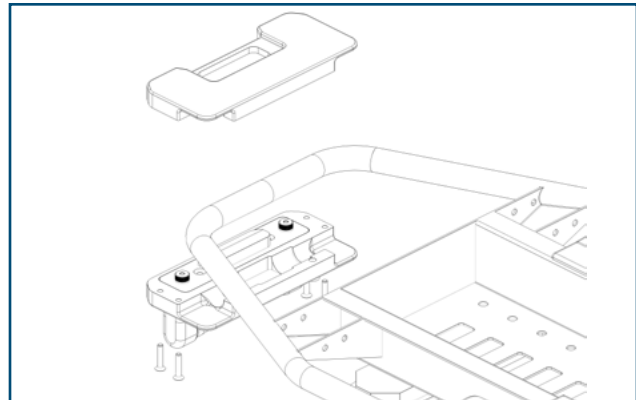

6. Handle assembly is complete.

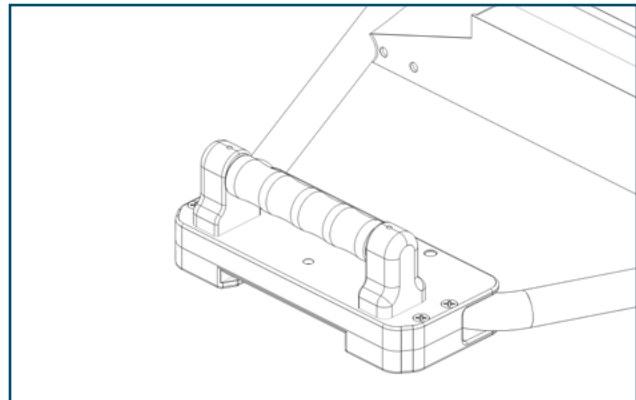

INSTALLATION GUIDE

INSTALLATION OF THE CLAMP BLOCKS ONTO THE COT

1. Prepare for installation of the clamp blocks.
2. Identify all components prior to installation.

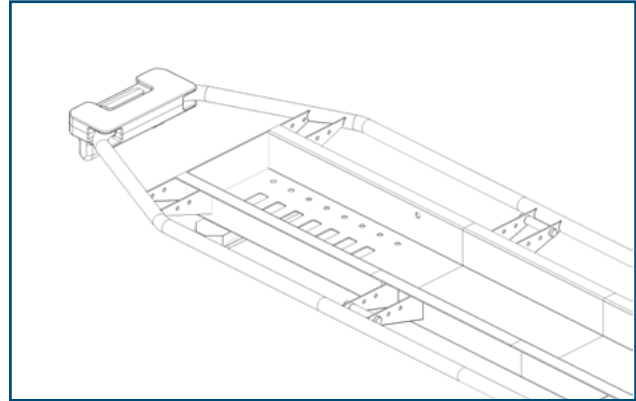

3. Identify all four (4) Clamp Block sets (4 x D and 4 x E)
4. Identify all 8 Cadmium Plated Socket Screws 1/4-20 x 1.25 in (F).

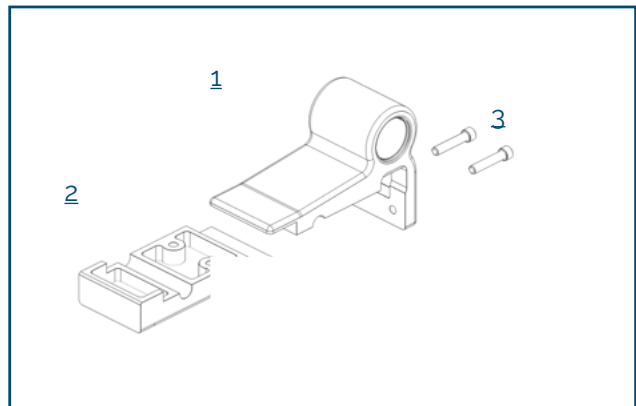

5. All Clamp Block sets are identical.
6. View of clamp block installation points on the cot.

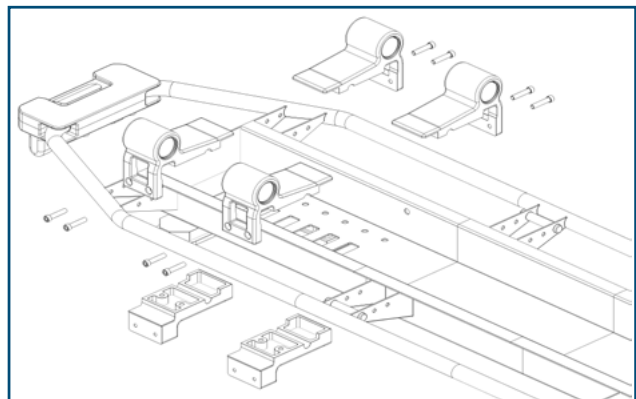

INSTALLATION GUIDE

INSTALLATION OF THE CLAMP BLOCKS ONTO THE COT (CONTINUED)

7. Position a bottom clamp block (E) near the hole located on the cot.

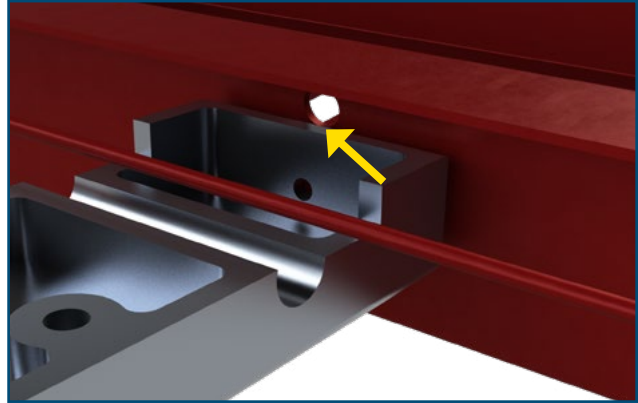

8. Properly place the brake cable inside the clamp block as shown in the picture.



9. Place the top clamp block component (D) on top of the other.
10. Hold together tightly while preparing to put in the screws.

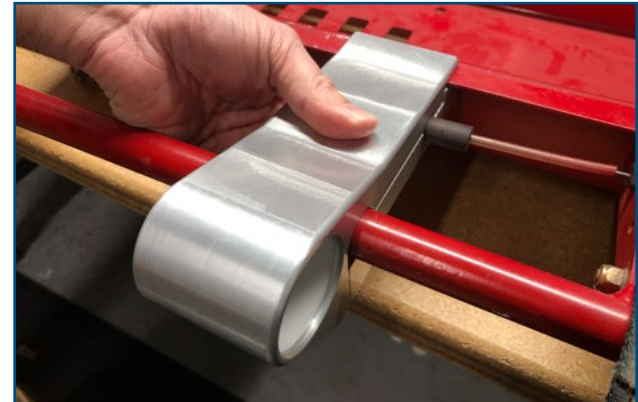

INSTALLATION GUIDE

INSTALLATION OF THE CLAMP BLOCKS ONTO THE COT (CONTINUED)

11. Insert socket head screws 1/4-20 x 1.25 in, (F) first and tighten slightly to hold the clamp block components together.

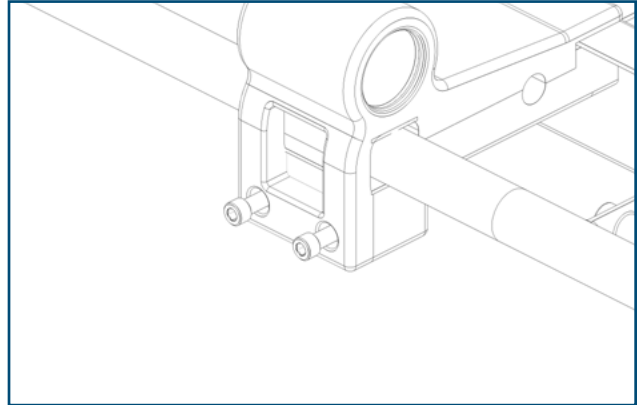

12. Leave screws loose.

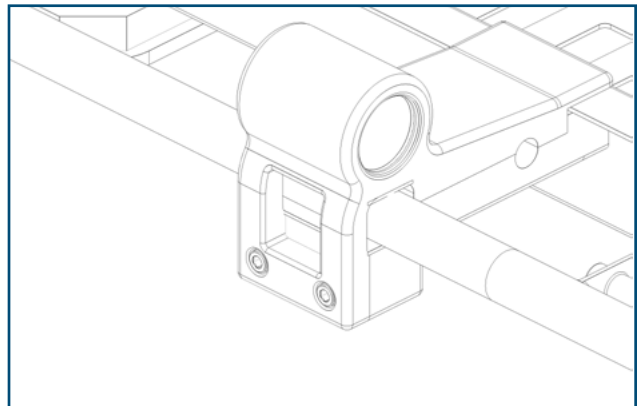

13. Prepare to install second set of clamp blocks near the foot end of the cot.
14. Locate installation points near the foot end of the cot.

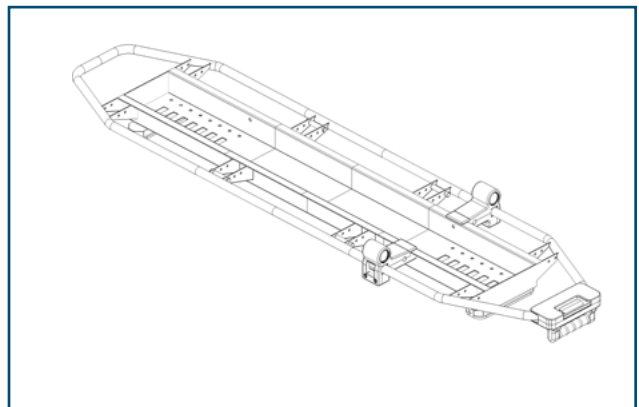

INSTALLATION GUIDE

INSTALLATION OF THE CLAMP BLOCKS ONTO THE COT (CONTINUED)

15. Position bottom clamp block (E) as close as possible to the end metal plate.

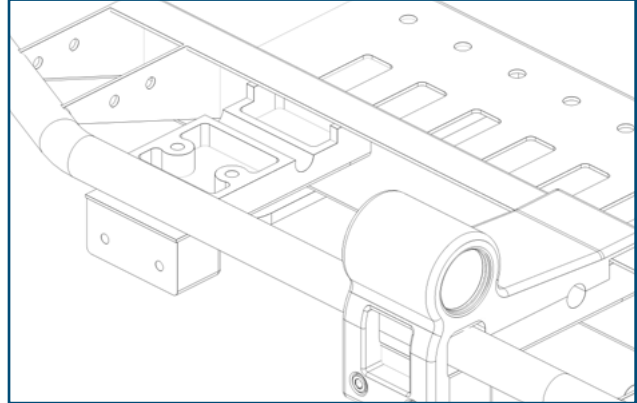

16. Clamp block is positioned correctly with the brake cable tightly positioned inside.

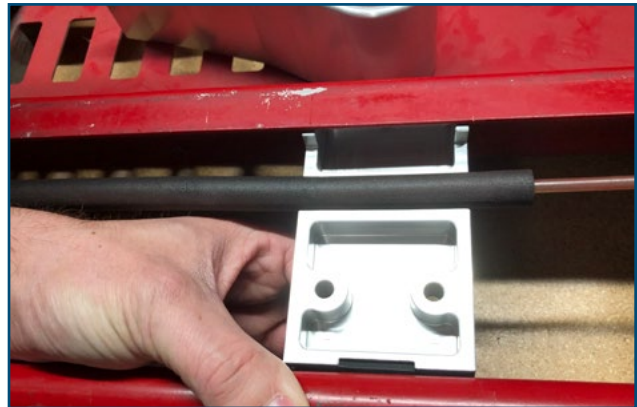

17. Place the top clamp block component (D) on top of the other.
18. Hold together tightly while preparing to put in the screws.

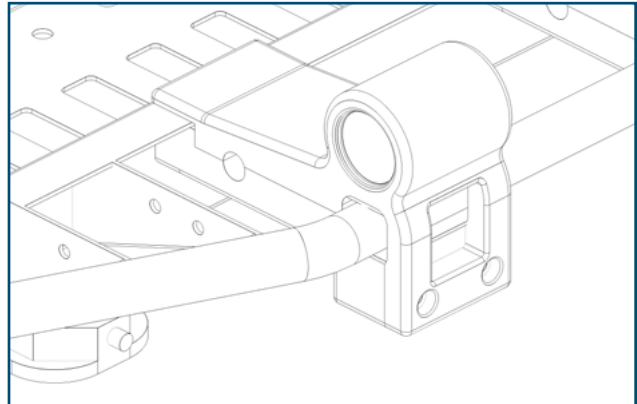

INSTALLATION GUIDE

INSTALLATION OF THE CLAMP BLOCKS ONTO THE COT (CONTINUED)

19. Insert socket head screws 1/4-20 x 1.25 in, first (F) and turn slightly to hold the clamp block components together.

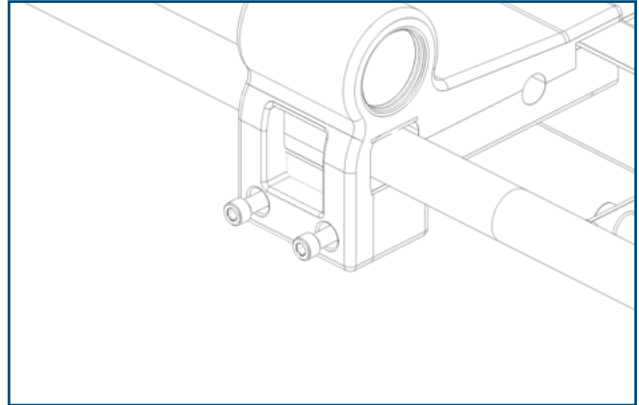

20. Leave the screws loose. Tighten the socket head screws in a later step.

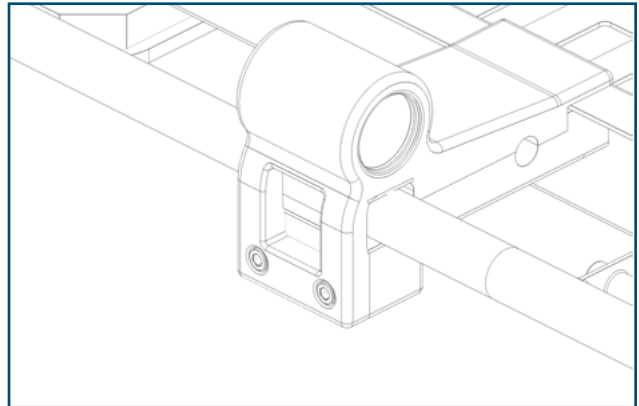

INSTALLATION GUIDE

INSTALLATION OF THE COT SUPPORT STRUCTURE

1. Once the 4 clamp blocks have been installed, locate the Cot Support Structure.
2. Install the Cot Support Structure (G) onto the cot.
3. Install spacers (I) between the Cot Support Structure and the Handle before inserting the screws to ensure a tighter fit.
4. Install the structure onto the clamp blocks using the 10 Stainless Steel Socket Head Cap Screws 1/4-20 x 1.5 in (H) and flat Washers.

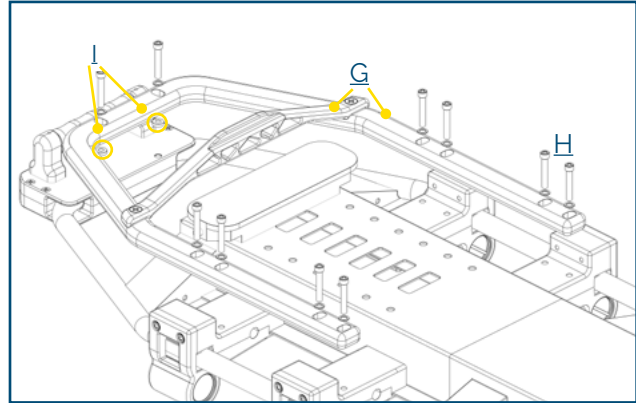

5. Leave screws loose.

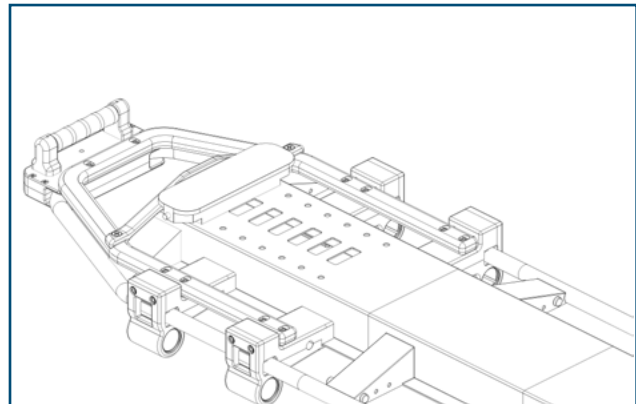

INSTALLATION GUIDE

INSTALLATION OF THE MOBILE EQUIPMENT SUPPORT STRUCTURE INTO CLAMP BLOCKS LOCATED ON THE COT

1. Align both side tubular arms with the clamp blocks openings on either side of the cot at the same time.
2. Ensure to align the center part into the handle properly. This is your locking mechanism.

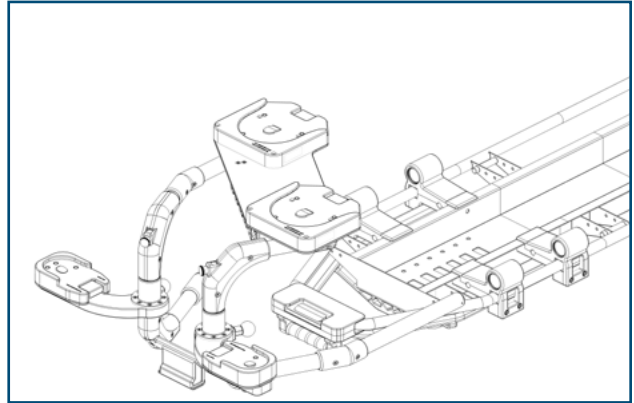

3. Insert all the way into both clamp blocks on either side of the cot.

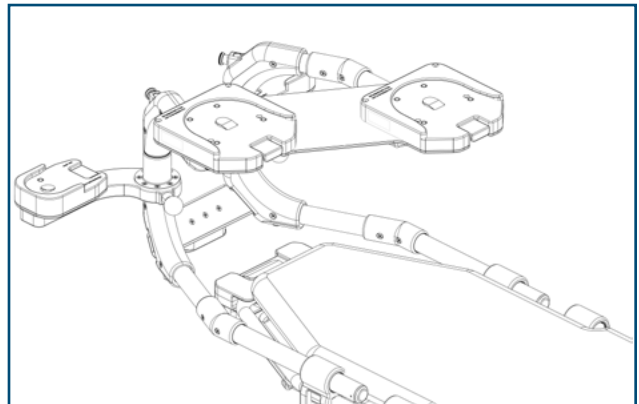

4. Ensure you hear the locking sound when the center piece locks into the handle part on the cot.

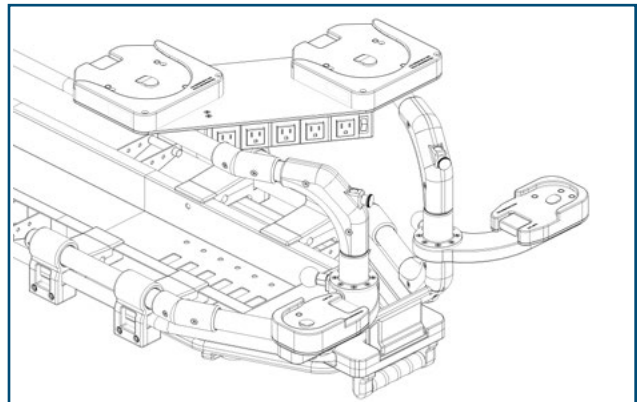

INSTALLATION GUIDE

INSTALLATION OF THE MOBILE EQUIPMENT SUPPORT STRUCTURE INTO CLAMP BLOCKS LOCATED ON THE COT (CONTINUED)

5. The Mobile Equipment Support Structure is locked on the cot.

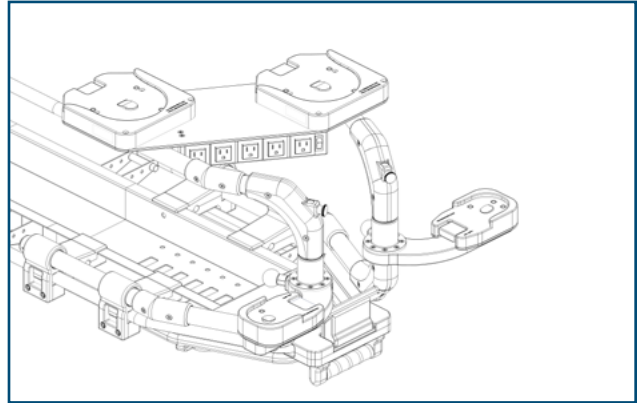

6. Tighten the 2 socket head screws on each of the 4 clamp blocks (all 8 screws). Required torque: 50 in-lbs.

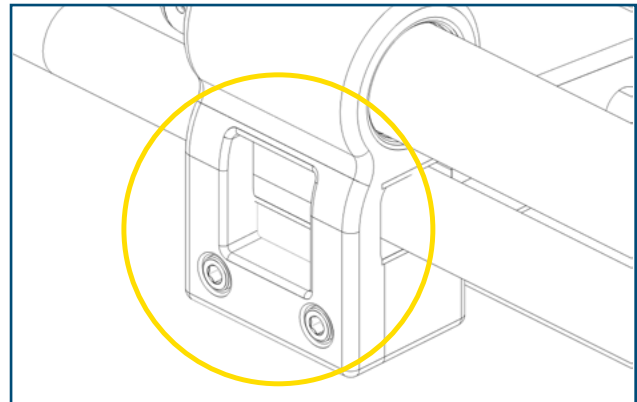

7. Tighten all 10 screws of the Cot Support Structure to finalize installation.

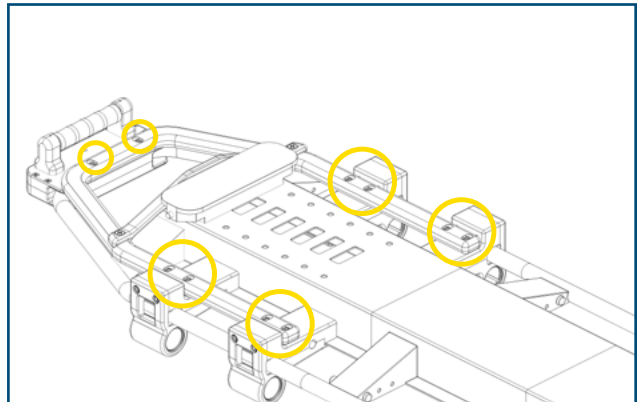

INSTALLATION GUIDE

REMOVING THE MOBILE EQUIPMENT SUPPORT STRUCTURE FROM THE COT

1. Pull the handle downward to remove the Mobile Equipment Support Structure from the cot.
2. While holding down the handle, pull to disengage from the cot Locking Handle system.

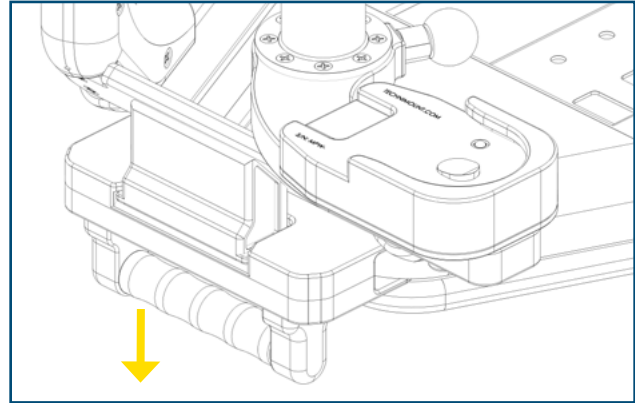

3. Once disengaged, pull with both hands to slide both tubes out of side clamp blocks.

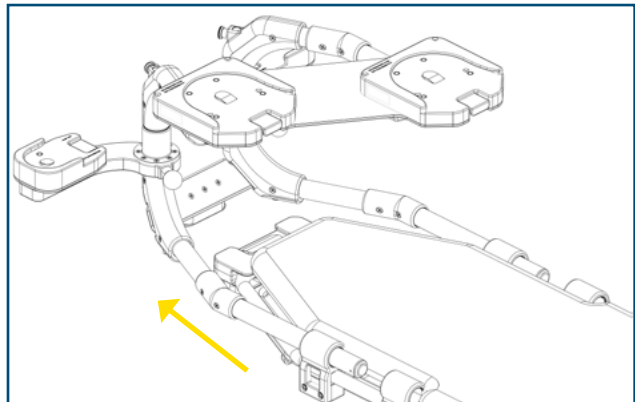

4. Once free of the clamp blocks on either side, place the Mobile Equipment Support Structure on a stable surface.
5. Store the Mobile Equipment Support Structure in a safe location when not in use.

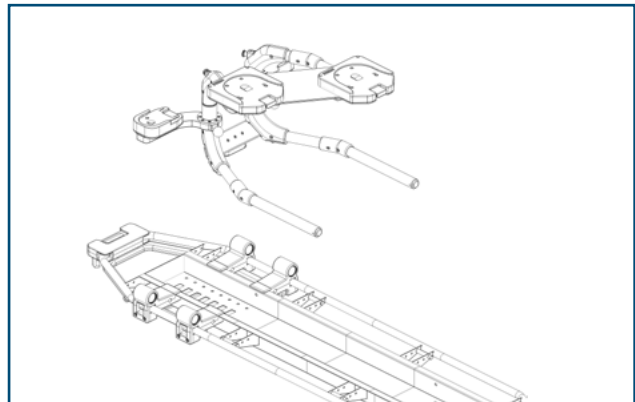

INSTALLING A MEDICAL DEVICE WITH A TECHNIMOUNT BRACKET ONTO THE STANDARD SURFACE BASE

1. Only Technimount brackets with a Standard Bottom Disc can be inserted into the Standard Surface Bases located on the top shelf.

 **WARNING**

Please refer to the appropriate Bracket Pro Serie user guide to follow the appropriate instructions for installation and use.

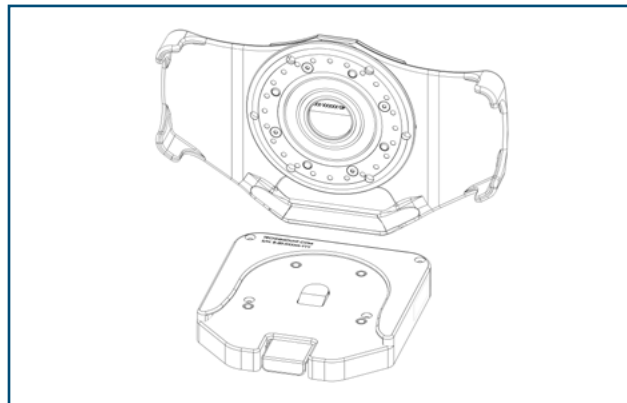

2. To insert the bracket into the Standard Surface Base, slide into the base horizontally from the front of the base towards the back.

 **WARNING**

Ensure the bracket is locked securely in the Standard Surface Base before manipulating the device or transporting the cot.

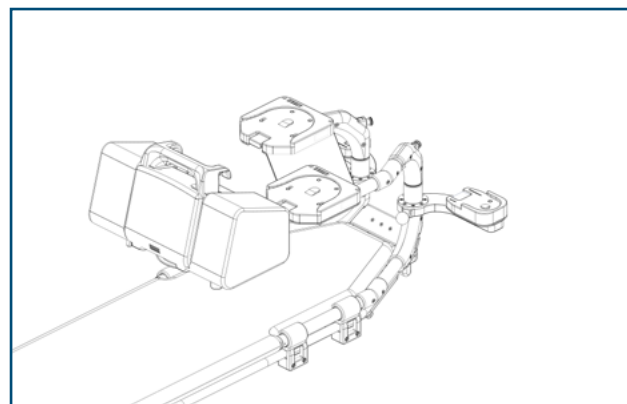

3. Insert the ZOLL monitor/defibrillator before the Hamilton ventilator.
4. If the ZOLL monitor/defibrillator has bags installed on both sides, turn the ZOLL monitor sideways to insert the Hamilton ventilator into the other base.

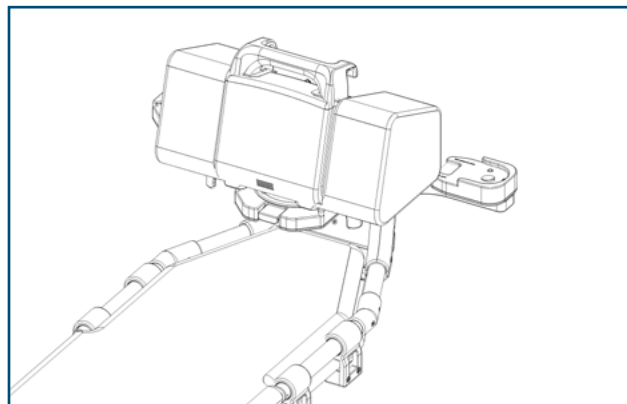

INSTALLING A MEDICAL DEVICE WITH A TECHNIMOUNT BRACKET ONTO THE STANDARD SURFACE BASE (CONTINUED)

5. Swivel medical device to allow installation of the other medical device.
6. To insert the bracket into the Standard Surface Base, slide into the base horizontally from the front of the base towards the back.

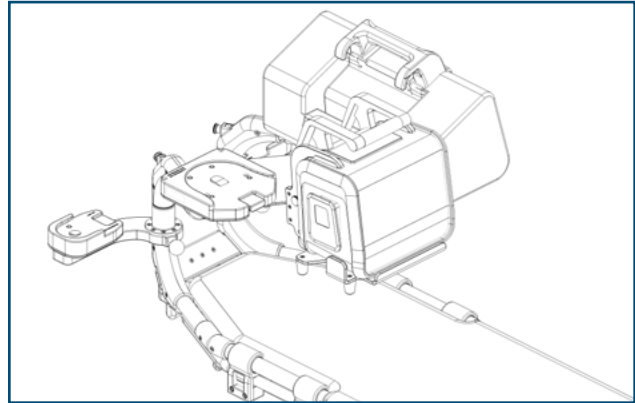

7. Ensure the bracket is locked securely in the Standard Surface Base before manipulating the device or transporting the cot.

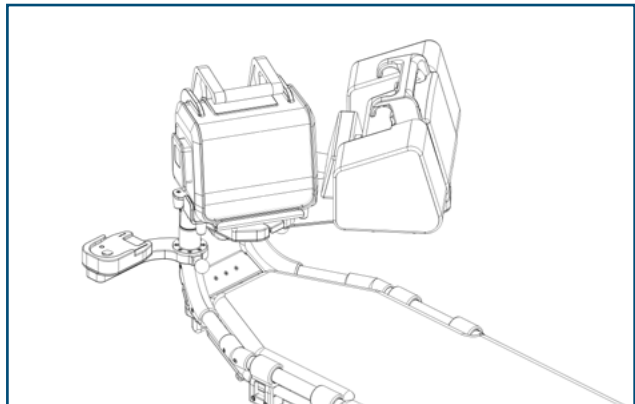

ROTATING THE BRACKET ON THE STANDARD SURFACE BASE

1. To rotate the medical device 360°, turn the bracket inside the Standard Surface Base clockwise or counter clockwise to use the device in the desired position.

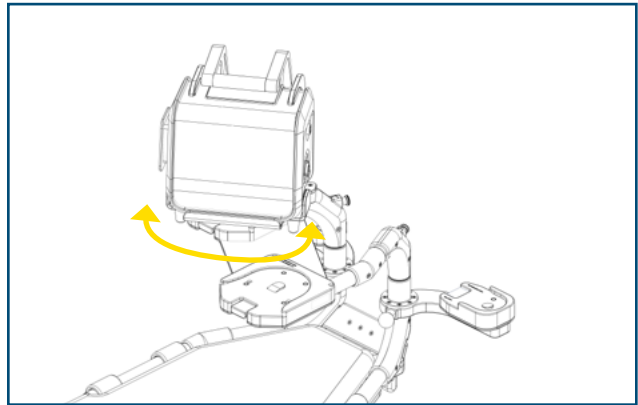

REMOVING A MEDICAL DEVICE FROM THE STANDARD SURFACE BASE

1. To remove the bracket from the Standard Surface Base, press the Red Quick Release Mechanism located on the front of the Standard Surface Base.
2. While holding the Red Quick Release Mechanism, slide outwards horizontally to remove from the base.

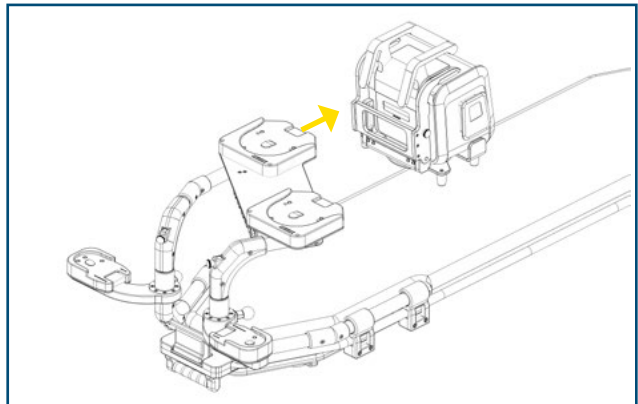
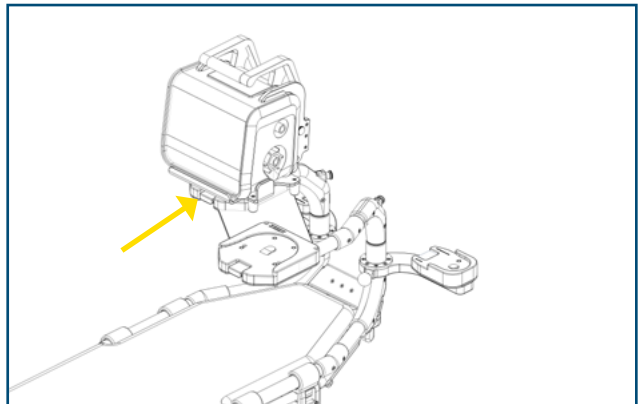

INSTALLING A MEDICAL DEVICE ONTO THE SWIVEL MICRO SHELF

1. Only Technimount brackets with a Bottom Micro Disc can be inserted into the Micro Base located on the Xtension Pro Assistant - LP.
2. To insert the bracket into the Swivel Micro Shelf, slide into the base horizontally from the front of the base.

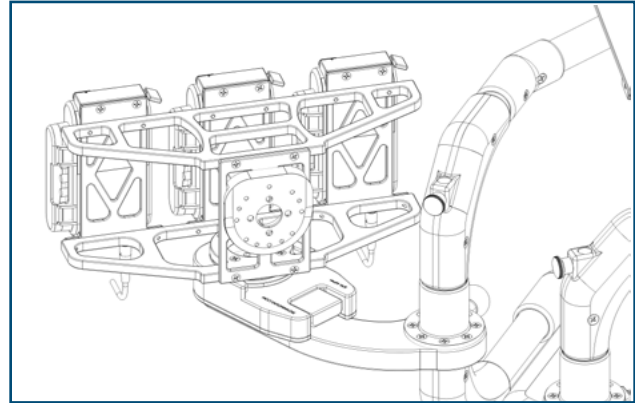

3. Ensure the bracket is locked securely in the Swivel Micro Shelf before manipulating the device or transporting the cot.

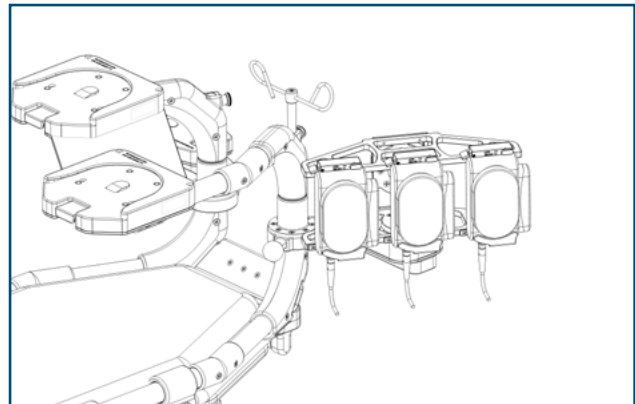

ROTATING THE BRACKET ON THE SWIVEL MICRO SHELF

1. To rotate the medical device 360°, turn the bracket inside the Swivel Micro Shelf clockwise or counter clockwise to use the device in the desired position.

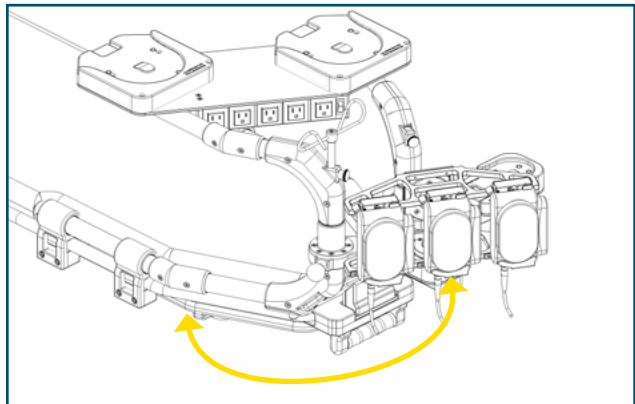

INSTALLING A MEDICAL DEVICE ONTO THE SWIVEL MICRO SHELF (CONTINUED)

1. To remove the bracket from the Swivel Micro Shelf, press the Red Quick Release Mechanism located on the front of the Swivel Micro Shelf.
2. While holding the Red Quick Release Mechanism, slide outwards horizontally to remove from the base.
3. Remove from the Micro Base.

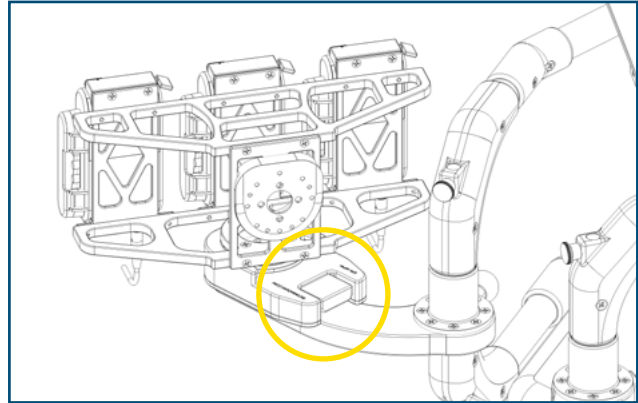

VIEW OF THE COMPLETE INSTALLATION

1. Front View

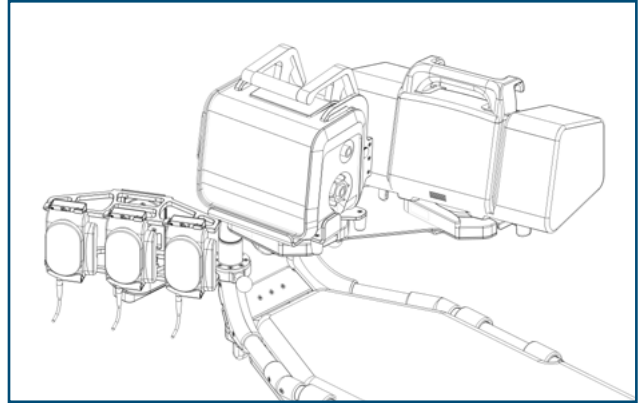

2. Back View - Patient Right

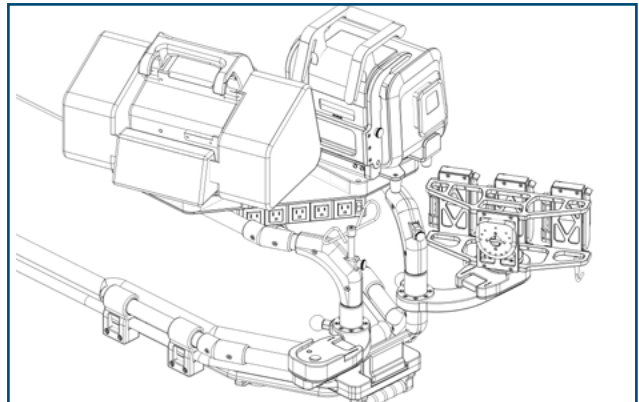

3. Back View patient Left

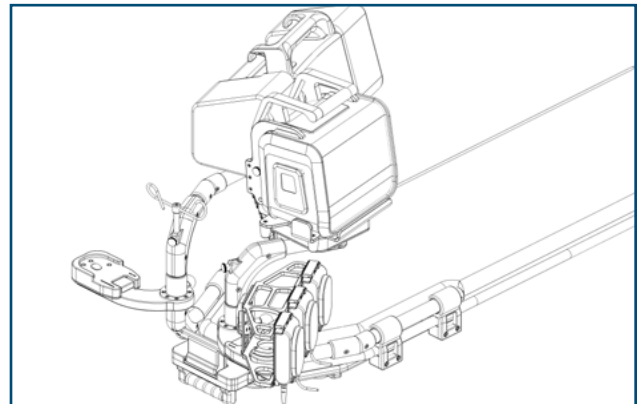

MOUNTING SYSTEM PART NUMBERS

KITS AND OTHER OPTIONS

<u>DESCRIPTION</u>	<u>PART NUMBER</u>
Cot Clamp Block (4 Clamp Blocks), Cot Support Structure, and locking Handle Assembly Kit	TCM-121-004
Clamp Block Assembly Kit (4 Clamp Blocks) and Cot Support Structure	Contact Customer Service
Locking Handle Assembly Kit only for installation on LifePort cot foot End	TCM-121-003
Mobile Equipment Support Structure Section Kit only	TCM-121-001
Bracket Pro Serie Family of Products	Contact Customer Service
Power Bar	Contact Customer Service



WARNING

Do not modify any components of these system. Modifying the products can cause unpredictable operation resulting in injury to the patient or operator.

NOTE

Technimount reserves the right to change Part Numbers and Products without notice. Please contact Customer Service to ensure product options and availability.

For any replacement parts or for repair, please contact Technical Support at techsupport@technimount.com

CLEANING THE XTENSION PRO ASSISTANT - LP

CLEANING PROCESS

The Xtension Pro Assistant - LP and components can be cleaned by using a pressure washer. The mounting system may show some signs of oxidation or discoloration from continuous washing, however, degradation of the cot performance or functionality will not be affected due to power washing if cleaning instructions are properly followed.

The material used to manufacture the system is high-grade aluminum, it is very durable and resistant to corrosion, however high levels of sodium or a high concentration of sodium or acid may prematurely corrode the product. Always rinse with soft soap and water if exposed.

- ✓ Use of a power washer can accelerate removal of contaminants collected during the use of the product.
- ✓ Rinse with clean water.
- ✓ Towel dry all components, and leave to air dry
- ✓ Avoid over saturation and ensure that the product does not stay wet longer than the cleaner manufacturer's guidelines for proper disinfecting.



WARNING

- ✓ When cleaning, always use appropriate personal protection equipment (PPE) based on established protocols (e.g., gloves, eyewear, etc.).



CAUTION

- ✓ Do not steam clean or use ultrasonic cleaners on the system or any of its components.
- ✓ Do not immerse the metal parts/components in water.
- ✓ Maximum water temperature should not exceed 180°F/82°C
- ✓ Maximum water pressure should not exceed 1500 psi/103.5 BAR . If a pressure washer is being used to clean the unit, the pressure nozzle must be kept a minimum of 24 inches (61 cm) from the unit.

CLEANING SOLUTIONS

Phenolic type or quaternary type disinfectants can be used (excluding Virex® TB). Iodophor type disinfectants, Peracetic Acid, Chlorine, and especially Peroxide Oxygen are not recommended for use because staining and corrosion may result.

Suggested cleaners for the System (B):

- ✓ Quaternary Cleaners (active ingredient - ammonium chloride)
- ✓ Phenolic Cleaners (active ingredient - o-phenyl phenol)
- ✓ Chlorinated Bleach Solution (3.25% - less than 1-part bleach to 100 parts water)

CLEANING THE XTENSION PRO ASSISTANT - LP SYSTEM (CONTINUED)

CLEANING SOLUTIONS CONTINUED

WARNING

- ✓ Some cleaning products are corrosive in nature and may cause damage to the product if used improperly.
- ✓ If the products described are used to clean the equipment, the System and components must be rinsed with clean water and thoroughly dried following cleaning. Failure to properly rinse and dry the system will leave a corrosive residue on the surface of the product, possibly causing premature corrosion of critical components.

REMOVAL OF IODINE COMPOUNDS

Use a solution of 0.13 oz/3.70ml of Sodium Thiosulfate in 1 pint / .5 litre of warm water to clean the stained area. Clean as soon as possible after staining occurs. If stains are not immediately removed, allow solution to soak or stand on the surface. Thoroughly rinse surfaces with clean water and allow to air dry before returning unit to service.

WARNING

- ✓ Failure to properly clean contaminated parts or components will increase the risk of exposure to blood borne pathogens and may cause injury to the patient or the operator.

PREVENTIVE MAINTENANCE

A preventive and regular maintenance program should be established for all Technimount equipment. Preventive maintenance may be required more frequently based on the usage level of the product. The System requires regular preventative maintenance. Establish and follow a preventive maintenance schedule and keep records of preventive maintenance activities (see maintenance form in this user guide).

CAUTION

- ✓ Close attention should be given to safety features including, but not limited to the handle and locking mechanisms and Discs.
- ✓ Improper maintenance can cause injury or damage to the product. Maintain the product as described in this user guide.

LUBRICATION

The System has been designed to operate without the need for lubrication. Due to an anodization of the metallic parts, using a silicone-base lubricant can be used but it is not necessary. If you are not sure what to use, please contact Technical Support at techsupport@technimount.com.

CAUTION

- ✓ Failure to use authorized parts, lubricants, etc. could cause damage to the cot and will void the warranty of the product.

MAINTENANCE GUIDE

INSPECTION PROCESS AND SCHEDULE

MAINTENANCE PROGRAM

The following inspection routine and schedule is intended as a general guide for preventive maintenance of the Xtension Pro Assistant - LP. Factors such as weather, environment, geographical location, and individual usage will necessitate different maintenance. If you are unsure as to how to perform these maintenance inspections or at what interval to perform these inspections, please contact your Technical Support Team at techsupport@technimount.com. Check each routine and replace damaged or worn out parts if necessary.

Follow timetable below for maintenance (either in months (M) or hours (H)), in accordance with your Service’s current maintenance practices and protocols.

<u>ITEM</u>	<u>ROUTINE</u>	<u>1 M</u> <u>OR</u> <u>2 H</u>	<u>3 M</u> <u>OR</u> <u>6 H</u>	<u>6 M</u> <u>OR</u> <u>12 H</u>	<u>12 M</u> <u>OR</u> <u>24 H</u>
System	<ul style="list-style-type: none"> ✓ Inspect Xtension Pro Assistant - LP <ul style="list-style-type: none"> ▪ Inspect all screws ▪ Inspect Handle and ensure it locks properly ▪ Inspect Red Quick Release Mechanism is working properly ▪ Ensure system is working properly and there are no particles, obstacles, or debris ✓ Inspect the Standard Surface Bases <ul style="list-style-type: none"> ▪ If loose, or unscrewed, tighten screws ▪ Ensure they work properly to install and remove the medical device on and from the bases ✓ Inspect Swivel Micro Shelf <ul style="list-style-type: none"> ▪ Ensure the handle works properly to change position ▪ Verify Red Quick Release Mechanism is working properly - by pulling and releasing ▪ Verify Red Quick Release Handle returns to its position once released ✓ Verify Integrated Suction Pump Bracket <ul style="list-style-type: none"> ▪ Verify that the Red Quick Release Mechanism is working properly ▪ Verify the handle can release the device from the shelf ✓ Do a visual inspection of all components to ensure there is no damage or chemical attack 	X			

[Return To Table of Contents](#)

REPLACEMENT PARTS

The parts and accessories listed are all currently available for purchase. Some of the parts identified on the assembly drawing parts in this user guide may not be individually available for purchase. Please call Technimount Customer Service or Technical Support : + 1 888.639.2758 or at customerservice@technimount.com for availability and pricing.

<u>DESCRIPTION</u>	<u>PART NUMBER</u>
Locking Handle Assembly Kit	TCM-121-003
One Clamp Block	TCM-121-004
Mobile Equipment Support Structure	TCM-121-001
Cot Support Structure	REF-TCM-121-002
Standard Surface Base for Flight	100-20-UN-FL
Micro Base for Flight (horizontal installation)	120-20-UN-510-FL
Micro Base for Flight	120-20-UN-FL
IV Poles	TCM-052-051

WARRANTY POLICY

This statement constitutes TECHNIMOUNT's entire warranty policy with regards to the TECHNIMOUNT Products. TECHNIMOUNT MAKES NO OTHER WARRANTY OR REPRESENTATION NEITHER EXPRESSED NOR IMPLIED, EXCEPT AS SET FORTH HEREIN. THERE IS NO WARRANTY OF MERCHANTABILITY AND THERE ARE NO WARRANTIES OF FITNESS FOR ANY PARTICULAR PURPOSE. IN NO EVENT SHALL TECHNIMOUNT BE LIABLE HEREUNDER FOR INCIDENTAL OR CONSEQUENTIAL DAMAGES ARISING FROM OR IN ANY MANNER RELATED TO SALES OR USE OF ANY SUCH EQUIPMENT.

TECHNIMOUNT E.M.S. Holding Inc. (Technimount) guarantees to the original "Purchaser" of the "Hardware" with which this "Limited Warranty" is included that the Hardware will be free from "Defects" in workmanship and materials under normal use for a "Warranty Period", one (1) year from the date that the Hardware was first purchased by the Purchaser. During the Warranty Period, the Hardware will be repaired or replaced according to the "Limited Warranty" without charge to the Purchaser for either parts or labor. The parts may be repaired or replaced with either new or refurbished parts. The product may be replaced for a new or refurbished product. For this Limited Warranty "refurbished" means parts and products, which have been returned to factory specifications. If the Hardware is repaired or replaced within the Warranty Period, the greater of the remaining warranty period will apply or three (3) months from the date of repair/replacement. If the Hardware is repaired or replaced after the Warranty Period has expired, the Warranty Period for the repair or replacement will expire three (3) months after the date of repair or replacement.

LIMITED RESPONSIBILITY AND WARRANTY

The Limited Warranty does not apply to normal wear that should result from normal use. It does not apply when the Hardware or any component is opened, disassembled, or repaired by someone not authorized by "TECHNIMOUNT" and does not cover repair or replacement of any Hardware or part thereof damaged by neglect, misuse, moisture, liquids, exposure to heat, accidents, abuse, and non-compliance with the instructions for installation and use provided with the Hardware. The Limited Warranty does not cover physical damage to the surface of the Hardware, and the decision to repair, replace or refuse the coverage is final and its sole discretion of TECHNIMOUNT, and is made without any compensation or obligation from TECHNIMOUNT.

The hardware, or product defined as a mounting or bracket system for clipping and attaching medical equipment is specifically designed to fill this requirement. Any other use will void the warranty and TECHNIMOUNT will not be held liable on any claim if the product is modified or adapted for use.

Technimount products are intended to retain a medical device in place in the case of a single crash impact. A Technimount product must NOT be used again if it was involved in a crash. The product MUST be replaced. If the Purchaser uses a Technimount product following a crash, it is at the Purchaser's own risk and Technimount will not be held liable.

INTERNATIONAL WARRANTY CLAUSE

This warranty reflects Canadian domestic policy. Warranty outside Canada may vary by country. Please contact TECHNIMOUNT Customer Service for more information.

RETURN POLICY

RETURN POLICY

Mounting systems and bracket systems for portable medical devices may be returned up to 60 days of receipt if:

- The product is not what was originally ordered
- The product does not meet specifications with TECHNIMOUNT's technical sheets according to the customer
- The product is not compatible with the equipment on which it was to be installed

For any manufacturing defect, refer to the conditions of the Warranty Policy.

PRIOR TO 30 DAYS

- Product must be undamaged and in its original packaging
- The product return request must be provided in writing and it must be approved by TECHNIMOUNT prior to returning the product
- Returns will not be approved on a modified or damaged item
- Charges may apply if damaged or missing items
- Customer is responsible for a 10% restocking fee

PRIOR 45 DAYS

- Product must be unused, undamaged and in its original packaging
- The product return request must be provided in writing and it must be approved by TECHNIMOUNT prior to returning the product
- Returns will not be approved on modified or damaged item
- Charges may apply if damaged or missing items
- Customer is responsible for a 25% restocking fee

PRIOR 60 DAYS

- Product must be unused, undamaged and in its original packaging
- The product return request must be provided in writing and it must be approved by TECHNIMOUNT prior to returning the product
- Returns will not be approved on a modified or damaged item
- Charges may apply if damaged or missing items
- Customer is responsible for a 30% restocking fee

RETURN AUTHORIZATION

TECHNIMOUNT's customer service department is responsible for approving any merchandise return and will provide a Return Merchandise Authorization (RMA) number to be printed on any returned merchandise. TECHNIMOUNT reserves the right to charge shipping and restocking fees on returned items. SPECIAL, MODIFIED, OR DISCONTINUED ITEMS NOT SUBJECT TO RETURN.

RETURN POLICY

DAMAGED MERCHANDISE

ICC Regulations require that claims for damaged merchandise must be made with the carrier within fifteen (15) days of receiving merchandise. DO NOT ACCEPT DAMAGED SHIPMENTS UNLESS SUCH DAMAGE IS NOTED ON THE DELIVERY RECEIPT AT THE TIME OF RECEIPT. Upon prompt notification, TECHNIMOUNT will file a freight claim with the appropriate carrier for damages incurred. Claim will be limited in amount to the actual replacement cost. In the event that this information is not received by TECHNIMOUNT within the fifteen (15) day period following the delivery of the merchandise, or the damage was not noted on the delivery receipt at the time of receipt, the customer will be responsible for payment of the original invoice in full.

Note: Claims for any short or broken shipment must be made within thirty (30) days of invoice.

CLAIM PROCESS

Please follow the claim procedure below to return a defective product:

Fill in the RMA form online at <https://www.technimount.com/service-support/service-support-overview/>

REQUIRED INFORMATION

- Serial number
- Invoice number
- Identification of the issue
- Upload the pictures of the issue
- Submit the form

A confirmation of the receipt of the claim will be sent to you within 2 business days. If you have not received a confirmation email by then, please contact .

If the RMA request is approved, TECHNIMOUNT will provide you with an RMA number for your claim. We will also include instructions for the replacement of your product. No product return will be accepted without the RMA number labeled on the outside of the box being returned.

FINDINGS AND CONCLUSION

- If following an investigation, we find that our product is defective, TECHNIMOUNT will take corrective actions and close the claim
- If following an investigation, we find that our product is NOT defective (misuse or abuse of the product) the product will not be covered by the warranty. Details of our findings and conclusions will be provided to you

QUESTIONS ABOUT OUR POLICY

If you have any questions regarding our return policy, please contact our Customer Service department at customerservice@technimount.com.

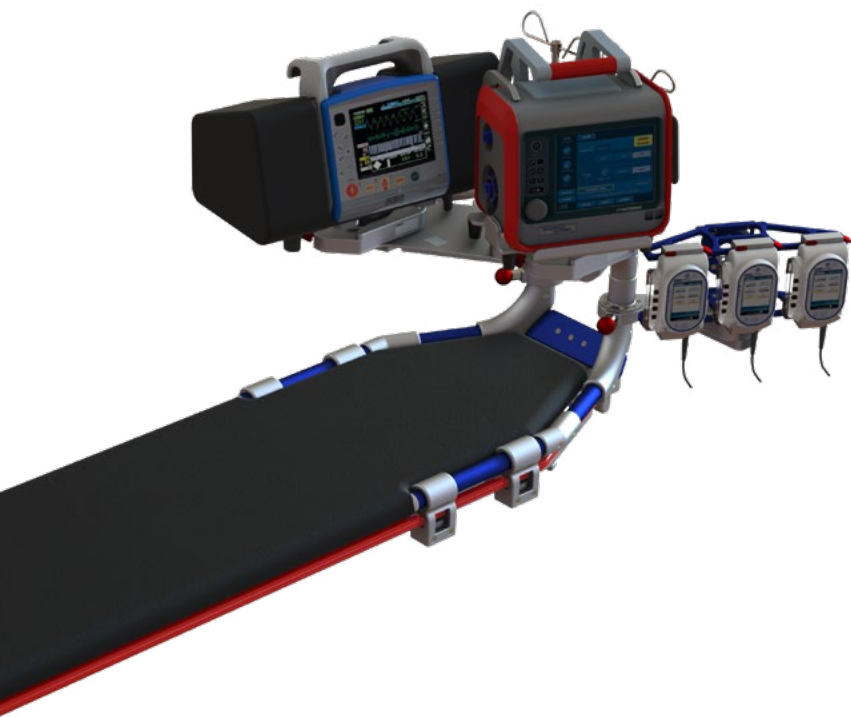

SAFETY AND FLEXIBILITY WHERE IT MATTERS MOST

TECHNIMOUNT E.M.S. HOLDING INC.
3770 Jean Marchand Street, Suite 100-C
Quebec (QC) G2C 1Y6
Canada
T + 1 581.700.6613
TF + 1 888.639.2758
technimount.com
info@technimount.com

© 2022 Technimount E.M.S. Holding Inc. All Rights Reserved.
Printed in Canada



XTPA-LP UG 202207-02