



TECHNIMOUNT
EMS™

BRACKET PRO SERIE® 280

OPERATING GUIDE

**SAFETY AND FLEXIBILITY
WHERE IT MATTERS MOST**



Copyrights

Copyright 2023 Technimount E.M.S. Holding Inc. (Technimount EMS) is an affiliated company of Technologies CGC Inc. All Rights Reserved. No part of this publication may be reproduced, transmitted, transcribed, stored in a retrieval system, translated in any language, modified in any form or by any means, without the written permission of Technimount or its affiliate companies.

Trademarks

- Safety Arm System™ and Technimount EMS™ are trademarks of Technologies CGC Inc.
- Bracket Pro Serie® and Safety MD-Transporter® are registered trademarks of Technologies CGC Inc.
- VOCSN® is a registered trademark of Ventec Life Systems.

Product and medical equipment manufacturer names are Trademarks™ or Registered Trademarks® of their respective holders. Technimount does not have a commercial relationship with these medical equipment manufacturers.

For any issues with your Technimount product, its components, or for any technical questions during the installation, operation, or maintenance, please contact Technical Support at techsupport@technimount.com.

Contact Information

Technimount E.M.S. Holding Inc.

C/O: Regulatory Affairs

3770 Jean Marchand Street, Suite 100-C

Quebec (QC) G2C 1Y6

Canada

customerservice@technimount.com

techsupport@technimount.com

legal@technimount.com

www.technimount.com

T + 1 581.700.6613

TF + 1 888.639.2758

Table of Contents

Copyrights	ii
Trademarks	ii
Contact Information	ii
1. Safety Guidelines.....	4
2. Operate the Bracket Pro Serie 280	5
..... 2.1. Install the VOCSN in the Bracket Pro Serie 280	5
..... 2.2. Remove the VOCSN from the Bracket Pro Serie 280.....	7
3. Perform the Daily Safety Checks	9
..... 3.1. Required Tools.....	9
..... 3.2. Daily Safety Checks	9
..... 3.3. Illustrated Inspections Points	12

1. Safety Guidelines



WARNING - General warning

- **Do not** perform safety checks on Technimount products, before receiving proper training.
- Perform the safety checks, as prescribed in this operating guide. Failing to follow the recommended guidelines could cause premature damage to the product.



CAUTION - Safe handling and operation

Improper use of the Technimount product may damage the equipment or cause injury to the patients or EMS personnel.



CAUTION - Safe practice

- Always pay close attention to the condition of the safety mechanisms and fixation points, to prevent undue risk to the equipment, patients and EMS personnel. Follow the recommended guidelines prescribed in this document.
- Always ensure that the medical equipment is secured in the bracket and that the locking mechanism is functional before use.
- Keep this document with the product at all times.



CAUTION - Working load/Load balance

The Safe Working Load (SWL) is 18 lbs (8.2 kg). Do not overload the system.



CAUTION - Follow instructions for use

- Always read and abide by all the safety guidelines identified, as well as follow the instructions provided within this document.
- Refer to the medical device's user manual for safety precautions and user instructions for the safe use of the Ventec VOC SN ventilator.

2. Operate the Bracket Pro Serie 280

This Operating Guide is used to help EMS personnel effectively secure the Ventec VOCSN Multi-Function ventilator in the Bracket Pro Serie 280 during critical care transport. For detailed product information that is not user related, refer to your supervisor or the user manual when required.

NOTE: Always perform the Safety checks BEFORE using the Bracket Pro Serie 280. Refer to the "Daily Safety Checks" on page 9 for before each use.

NOTE: Technimount continually seeks advancements in product design and quality. While this operating guide contains the most updated product information available at the time of printing, it may contain minor differences with the current version. For more information, please contact Customer Service at customerservice@technimount.com.

2.1. Install the VOCSN in the Bracket Pro Serie 280

1. If the bracket is closed (locked), pull the 2 quick release knobs to disengage the pull-down bar and lift the pull-down bar upwards until it has run its course (Figure 1).

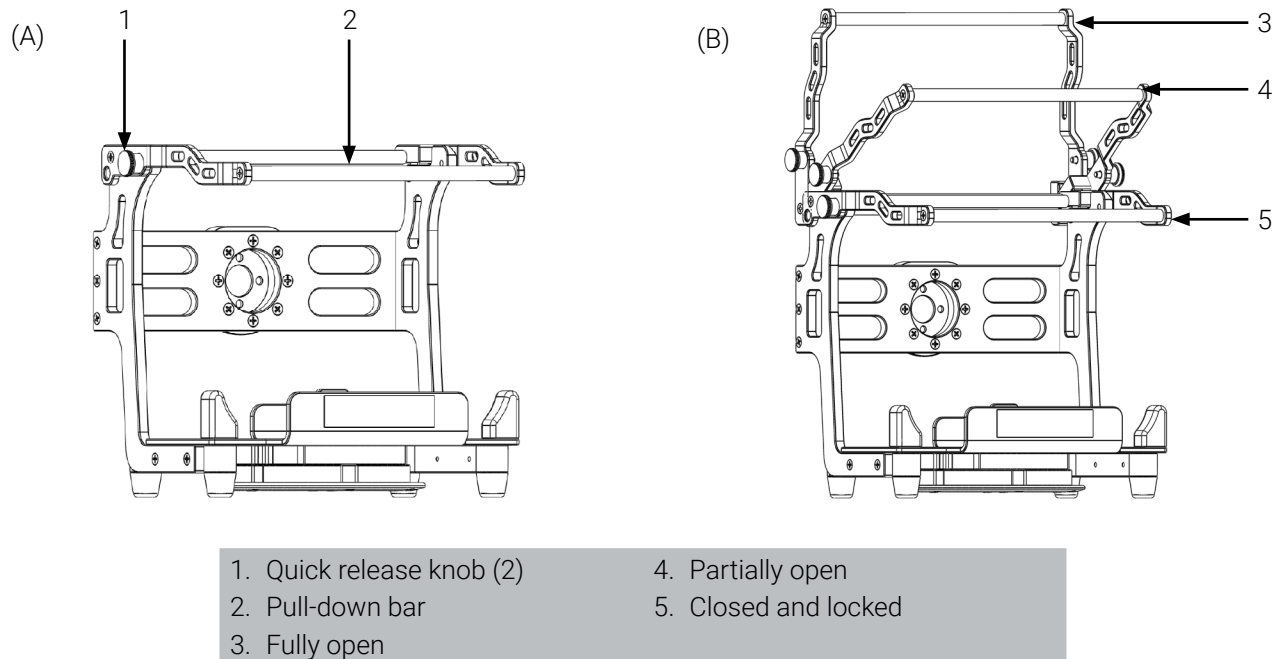

Figure 1: Unlock/open the Bracket Pro Serie 280

2. Lift the VOCSN ventilator using the handle (Figure 2 A).
3. Angle the ventilator forward and lean it against the front fold of the bracket to insert it in the mounting system (Figure 2 A).
4. Lean the ventilator backwards to place the ventilator in an upright position, between the 2 folds and centered between the 2 bumpers. Once installed, leave the ventilator handle up (Figure 2 B).

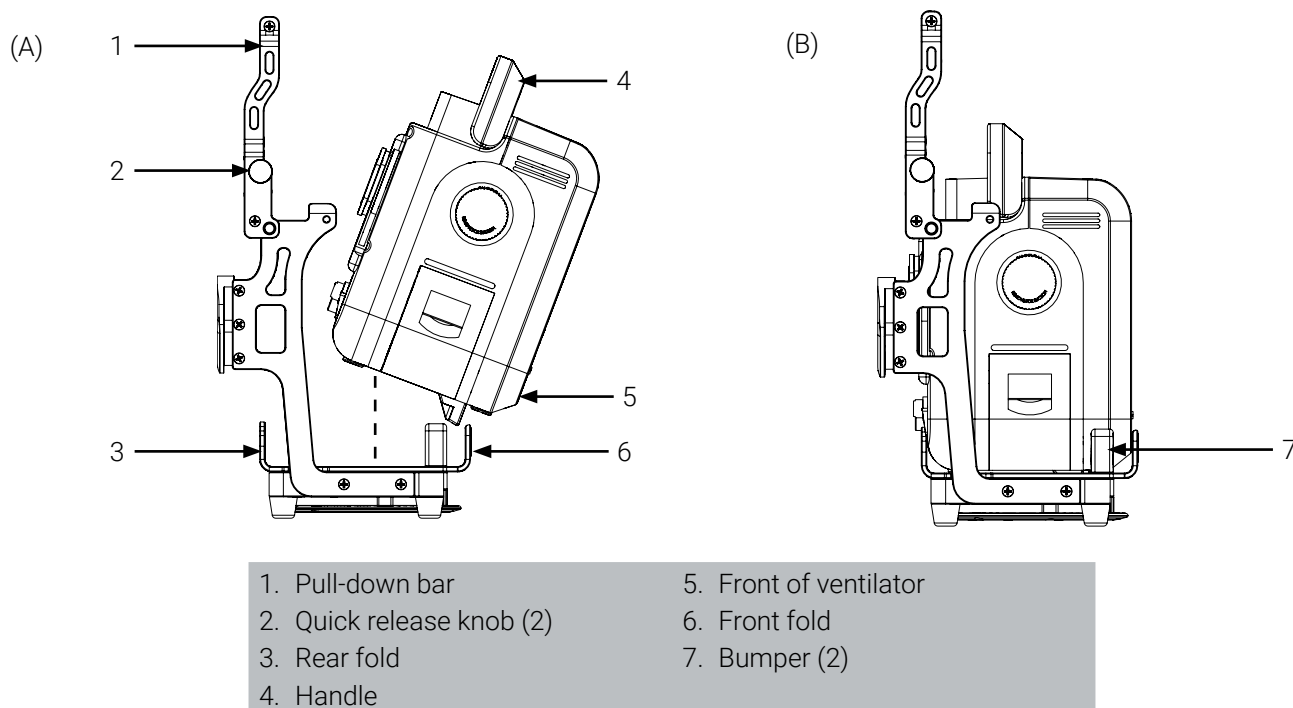

Figure 2: VOCSN ventilator installation in Bracket Pro Serie 280

5. Lower the pull-down bar over the ventilator to lock it (Figure 3 A).
6. Press down on the bar until you hear the click sound of the quick release knobs inserting in the bracket.
7. Lift / press the pull-down bar up and down a few times to make sure it is locked.

NOTE: The pull-down bar will not lower enough to securely lock if the VOCSN ventilator handle is not up. Lift the handle (Figure 3 B), then lower the pull-down bar to lock it.

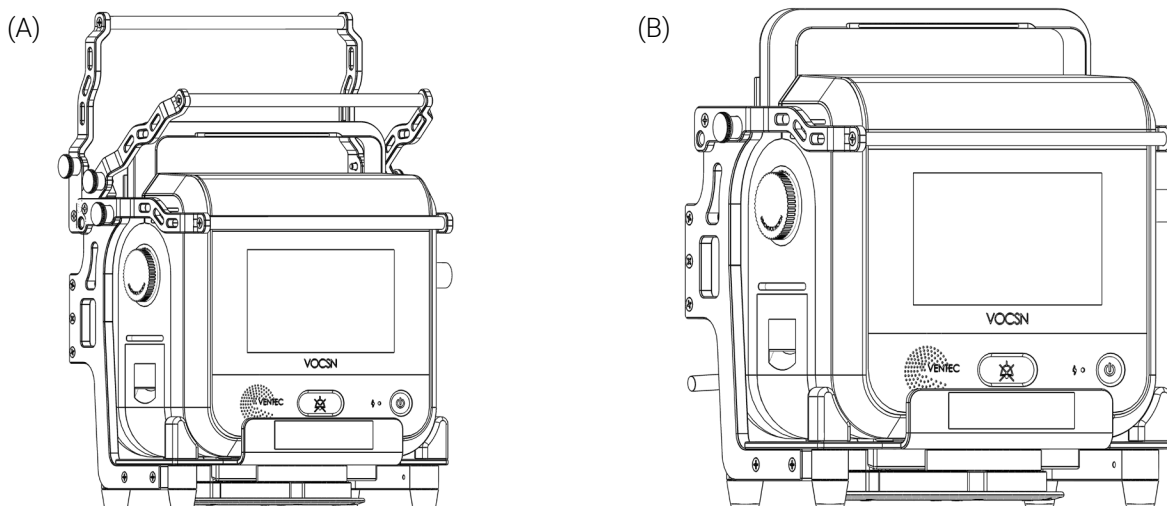

Figure 3: VOCSN ventilator installed in Bracket Pro Serie 280

2.2. Remove the VOCSN from the Bracket Pro Serie 280

1. Pull the 2 quick release knobs to disengage the pull-down bar and lift the pull-down bar upwards until it has run its course (Figure 4).

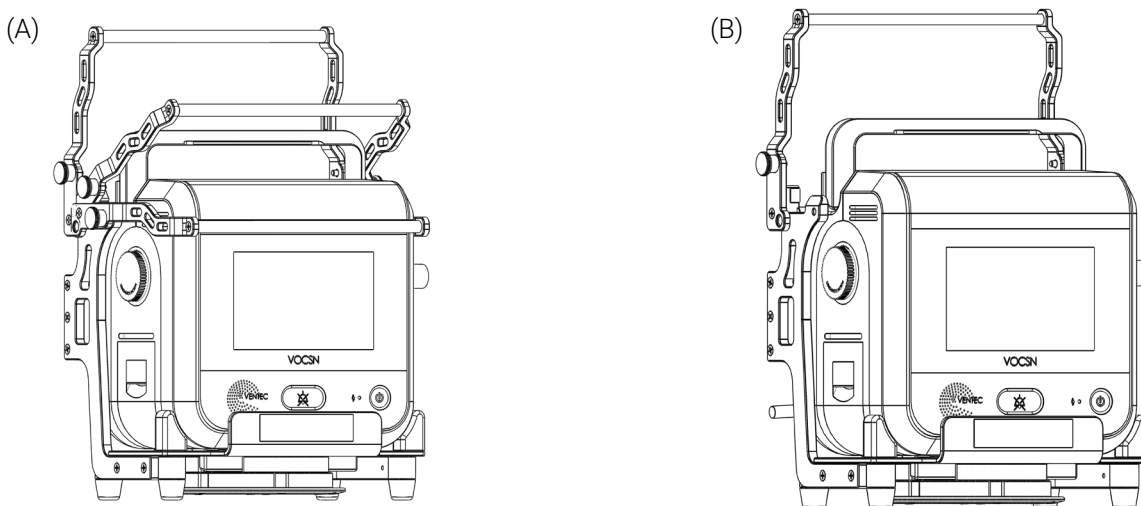

Figure 4: VOCSN ventilator removal from Bracket Pro Serie 280

2. Grab the ventilator handle and tilt the ventilator forward, leaning it on the front fold of the bracket (Figure 5).
3. Lift and pull out the ventilator, then set it aside on a flat surface.

NOTE: Pulling the ventilator upwards to remove it can cause friction which over time may cause premature damage to the product.

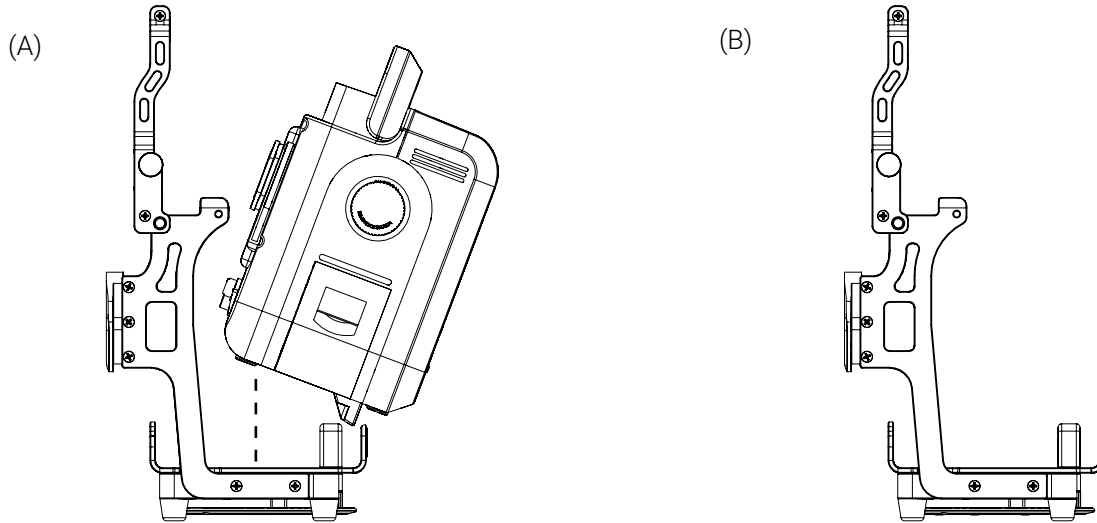

Figure 5: VOCSN ventilator removed from Bracket Pro Serie 280

3. Perform the Daily Safety Checks

Daily safety checks on Technimount products are recommended to keep them in good condition and avoid failure or injury to the patient or EMS personnel. EMS personnel should perform the daily safety checks at the beginning of each work shift.

NOTE: Always keep records of your all maintenance activities and immediately remove defective or expired products from your inventory.

Please contact Technical Support at techsupport@technimount.com for replacement parts or repair related issues.

3.1. Required Tools

- Clean dry cloth

3.2. Daily Safety Checks

Refer to the illustrated inspection points (Figure 6, Figure 7 and Figure 8), if needed.

NOTE: In case of a non-conformity, alert the maintenance supervisor of all non-compliances and immediately cease use.

DAILY SAFETY CHECKS		COMPLIANT	
INSPECTIONS		YES	NO
Bracket Pro Serie 280 (Figure 6)			
- Visually inspect all the components of the bracket to ensure there is no damage or chemical attack, that the hardware is in good condition and there are no loose screws.		<input type="checkbox"/>	<input type="checkbox"/>
- Visually inspect the bracket and make sure there are no lodged particles. If so, immediately remove using a clean dry cloth.		<input type="checkbox"/>	<input type="checkbox"/>
Pull-down bar (Figure 6)			
- Visually inspect all the components of the pull-down bar to ensure there is no damage or chemical attack and that the hardware is in good condition.		<input type="checkbox"/>	<input type="checkbox"/>
- Pull and release the quick release knobs and make sure of proper functioning (lock/unlock). The knobs should spring in and out without resistance.		<input type="checkbox"/>	<input type="checkbox"/>
- Once unlocked, lift and lower the pull-down bar to make sure there is no interference or lodged particles. If so, immediately remove using a clean dry cloth.		<input type="checkbox"/>	<input type="checkbox"/>
- Lower the pull-down bar to lock it, then pull upwards to make sure the locking mechanism is functional. If not, immediately cease use and alert the maintenance supervisor.		<input type="checkbox"/>	<input type="checkbox"/>
Anti-rotation micro disc (Figure 7)			
- Visually inspect all the components of the anti-rotation micro disc to ensure there is no damage or chemical attack and that the hardware is in good condition.		<input type="checkbox"/>	<input type="checkbox"/>
- Visually inspect the rim of the anti-rotation micro disc and make sure there are no lodged particles. If so, immediately remove using a clean dry cloth.		<input type="checkbox"/>	<input type="checkbox"/>

DAILY SAFETY CHECKS		COMPLIANT	
INSPECTIONS		YES	NO
<ul style="list-style-type: none"> - Insert / remove the anti-rotation micro disc on the Safety MD-Transporter base a few times to ensure proper functioning. The Bracket Pro Serie 280 should be easily inserted and locked in position after the click sound, and easily removed when using the quick release mechanism. 		<input type="checkbox"/>	<input type="checkbox"/>
Standard bottom disc (Figure 8)			
<ul style="list-style-type: none"> - Visually inspect all the components of the Standard bottom disc to ensure there is no damage or chemical attack and that the hardware is in good condition. 		<input type="checkbox"/>	<input type="checkbox"/>
<ul style="list-style-type: none"> - Visually inspect the rim of the Standard bottom disc and make sure there are no lodged particles. If so, immediately remove using a clean dry cloth. 		<input type="checkbox"/>	<input type="checkbox"/>
<ul style="list-style-type: none"> - Insert / remove the Standard bottom disc on the base a few times to ensure proper functioning. The Bracket Pro Serie 280 should be easily inserted and locked in position after the click sound, and easily removed when using the quick release mechanism. 		<input type="checkbox"/>	<input type="checkbox"/>
Acetal feet (Figure 6)			
<ul style="list-style-type: none"> - Visually inspect the (4) feet to ensure there is no damage or chemical attack, loose parts and that the hardware is in good condition. 		<input type="checkbox"/>	<input type="checkbox"/>

Daily Safety Checks completed on (dd/mm/yyyy)

, by

Comments and observations:



BRACKET PRO SERIE® 280

Operating Guide

[illegible]

3.3. Illustrated Inspections Points

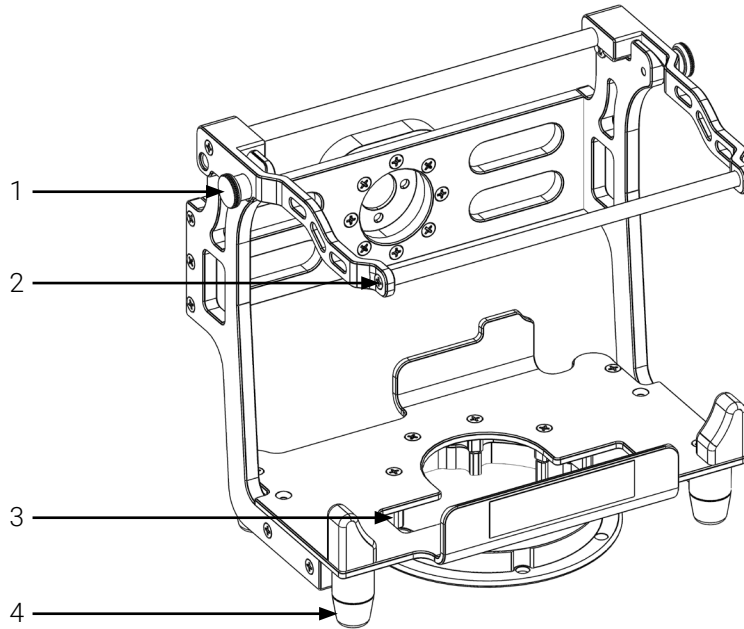

- | | |
|-----------------------|-----------------------------------|
| 1. Quick release knob | 3. Gap for VOCSN ventilator stand |
| 2. Pull-down bar | 4. Foot (2 shown) |

Figure 6: Bracket Pro Serie 280 inspection points (1 of 3)

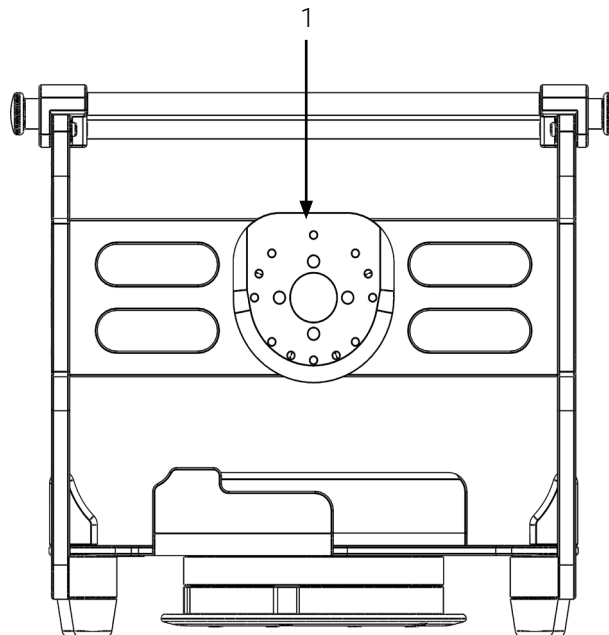

- | |
|---|
| 1. Anti-rotation micro disc (back of bracket) |
|---|

Figure 7: Bracket Pro Serie 280 inspection points (2 of 3)

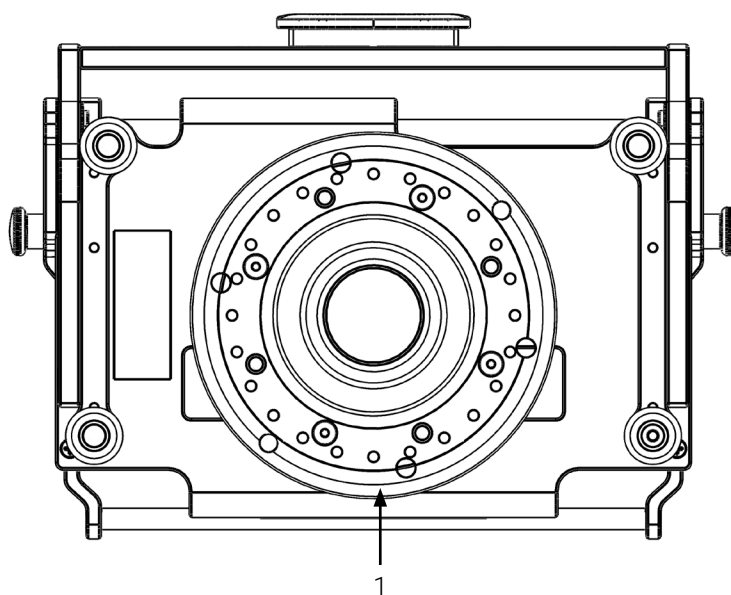

1. Standard bottom disc (under bracket)

Figure 8: Bracket Pro Serie 280 inspection points (3 of 3)



TECHNIMOUNT EMS™

Technimount EMS offers mounting solutions that can be installed on ambulance counters, walls and stretchers which allows for the equipment to follow the patient throughout the continuum of care. Our unparalleled level of flexibility allows for maximum operativity in EMS, hospital and military environments.

Technimount EMS is driven to offer innovative solutions that respond to the unique device management needs of emergency and Critical Care Transport (CCT) teams for ground and air ambulances. Safety is at the core of our values, all Technimount systems are tested in compliance with the highest industry standards for impact resistance. Technimount EMS is committed to evolving its solutions as healthcare practices evolve.

TECHNIMOUNT E.M.S. HOLDING INC.

3770 Jean Marchand Street, Suite 100-C
Quebec (QC) G2C 1Y6
Canada
T + 1 581.700.6613
TF + 1 888.639.2758

technimount.com