



**TECHNIMOUNT**  
EMS™

# XTENSION PRO™ ASSISTANT – CCT/ECMO

## USER MANUAL

SAFETY AND FLEXIBILITY  
WHERE IT MATTERS MOST



## Copyrights

Copyright 2023 Technimount E.M.S. Holding Inc. (Technimount EMS) is an affiliated company of Technologies CGC Inc. All Rights Reserved. No part of this publication may be reproduced, transmitted, transcribed, stored in a retrieval system, translated in any language, modified in any form or by any means, without the written permission of Technimount or its affiliate companies.

## Trademarks

Product and medical device manufacturer names are Trademarks™ or Registered Trademarks® of their respective holders. Technimount does not have a commercial relationship with these medical device manufacturers.

- Xtension Pro™ and Technimount EMS™ are trademarks of Technologies CGC Inc.
- Power-PRO™ is a trademark of Stryker Corporation.
- Infusomat® Space® and Perfusor® Space® are registered trademarks of B. Braun.
- Spectrum® is a registered trademark of Baxter.
- ZOLL X Series® is a registered trademark of ZOLL Medical Corporation.
- Hamilton-T1™ is a trademark of Hamilton Medical.
- Cardiohelp™ System is a trademark of Getinge/Maquet.

For any issues with your Technimount product, its components, or for any technical questions during the installation, operation, or maintenance, please contact Technical Support at [techsupport@technimount.com](mailto:techsupport@technimount.com).

## Contact Information

### Technimount E.M.S. Holding Inc.

C/O: Regulatory Affairs

3770 Jean Marchand Street, Suite 100-C

Quebec (QC) G2C 1Y6

Canada

[customerservice@technimount.com](mailto:customerservice@technimount.com)

[techsupport@technimount.com](mailto:techsupport@technimount.com)

[legal@technimount.com](mailto:legal@technimount.com)

[www.technimount.com](http://www.technimount.com)

T + 1 581.700.6613

TF + 1 888.639.2758 (North America)

## Table of Contents

<b>Copyrights .....</b>	<b>ii</b>
<b>Trademarks .....</b>	<b>ii</b>
<b>Contact Information .....</b>	<b>ii</b>
<b>1. General Mentions and Considerations .....</b>	<b>5</b>
..... 1.1. Intended Use .....	5
..... 1.2. User Competency .....	5
..... 1.3. Warranties .....	5
..... 1.3.1. Warranty Policy .....	5
..... 1.3.2. Limited Warranty .....	6
..... 1.3.3. International Warranty Clause .....	6
..... 1.3.4. User Liability .....	6
..... 1.4. Claims .....	6
..... 1.4.1. Damaged or Defective Merchandise .....	6
..... 1.4.2. Return Policy .....	7
..... 1.4.3. Return of Material Authorization (RMA) .....	7
..... 1.4.4. Claim Process .....	7
<b>2. General Safety Guidelines .....</b>	<b>8</b>
..... 2.1. Symbols and Definitions .....	8
..... 2.2. Labels .....	9
..... 2.2.1. Safety Labels .....	9
..... 2.2.2. Manufacturing Label .....	9
..... 2.3. Safety Measures .....	10
<b>3. Technical Specifications .....</b>	<b>12</b>
<b>4. Unpack the Mounting System .....</b>	<b>13</b>
<b>5. Xtension Pro Assistant - CCT/ECMO Illustrated Parts .....</b>	<b>14</b>
<b>6. Assemble the Mounting System .....</b>	<b>15</b>
..... 6.1. Required Assembly Parts .....	16
..... 6.2. Optional Assembly Parts .....	17
..... 6.3. Required Tools .....	18
..... 6.4. Stretcher Orientation .....	18
..... 6.5. Prepare the Stretcher .....	19
..... 6.6. Install the Clamp Blocks on the Stretcher Siderail .....	20

..... 6.7. Install the Rail Systems.....	24
..... 6.8. Install the Mobile Structure .....	26
..... 6.9. Install the Push Bars Into the Clamp Blocks at the Patient Head End (optional) .....	30
..... 6.10. Install the Push Bars on the Mobile Structure (optional) .....	31
..... 6.11. Install the Power Bar (optional).....	32
..... 6.12. Install the Techni-IV Pole (optional) .....	33
<b>7. Maintenance.....</b>	<b>35</b>
..... 7.1. Required Tools.....	36
..... 7.2. Condition-Based Maintenance Plan .....	36
<b>8. Spare Parts.....</b>	<b>38</b>

## 1. General Mentions and Considerations

Intended for the purchaser/supervisor, this user manual contains detailed product information and was designed to assist with the unpacking, assembling (when indicated) and maintenance of the Xtension Pro Assistant - CCT/ECMO mounting system. Its content should be relayed to EMS personnel during training. This document should be used with the operating guide, which contains specific user related information such as the operating procedures and the daily safety checks.

**NOTE:** Technimount continually seeks advancements in product design and quality. While this user manual contains the most updated product information available at the time of printing, it may contain minor differences with the current version. For more information, please contact Customer Service at [customerservice@technimount.com](mailto:customerservice@technimount.com).

### 1.1. Intended Use

Mounting system for ECMO and ground critical care transport on a Stryker® Power-PRO™ XT stretcher.

### 1.2. User Competency

The Xtension Pro Assistant - CCT/ECMO is intended for EMS personnel who have received the appropriate training, necessary to operate the device in the field, according to its intended use, as outlined in this user manual and operating guide. Please read all provided documentation thoroughly before using this device to ensure the safe operation of the device and provide a safe environment for patients and EMS personnel.

### 1.3. Warranties

#### 1.3.1. Warranty Policy

This statement constitutes Technimount's entire warranty policy with regards to the Technimount products. Technimount makes no other warranty or representation, neither expressed nor implied, except as stated herein. There is no warranty of merchantability or warranties of fitness for any particular purpose. Under no circumstances will Technimount be held liable hereunder for incidental or consequential damages, arising from or in any manner, related to sales or use of any such device.

Technimount E.M.S. Holding Inc. (Technimount) guarantees to the original "Purchaser" of the "Product" with which this "Limited warranty" is included, that the product will be free from "Defects" in workmanship and materials under normal use for a "Warranty period" of one (1) year from the product purchase date by the purchaser. During the warranty period, the product will be repaired or replaced according to the "Limited warranty" without charge to the purchaser for parts or labor. The parts and product may be repaired or replaced with new or refurbished parts or products. Herein this Limited Warranty, "Refurbished" means parts and products which have been returned to the factory, specifically. If the product is repaired or replaced within the warranty period, the greater of the remaining warranty period will apply, or three (3) months from the date of repair or replacement. If the product is repaired or replaced after the warranty period has expired, the warranty period for the repair or replacement will expire three (3) months after the repair or replacement date.

### **1.3.2. Limited Warranty**

Technimount products are intended to retain medical devices in place in the case of a single crash impact. Technimount products must not be reused if involved in a crash and must thereafter be replaced. If the end user uses a Technimount product following a crash, it is at the end user's own risk and Technimount will not be held liable.

The limited warranty does not apply to normal wear that could result from normal use. It does not apply when the product or any of its components have been disassembled or repaired by someone not authorized by "Technimount". It does not cover repair or the replacement of any product or part thereof damaged by neglect, misuse, moisture, liquids, exposure to heat, accidents, abuse and non-compliance with the instructions for installation and use provided with the product.

The limited warranty does not cover physical damage to the surface of the product. The decision to repair, replace or refuse the coverage is final and at the sole discretion of Technimount, without any compensation or obligation from Technimount. The product defined as a "Mounting system" or "Bracket system" used for clipping and attaching medical devices is specifically designed to fill this requirement. Any other use will void the warranty and Technimount shall not be held liable on any claim if the product has been modified or adapted for use.

### **1.3.3. International Warranty Clause**

This warranty abides by the Canadian domestic policy. Warranty outside Canada may vary by country. Please contact Customer Service at [customerservice@technimount.com](mailto:customerservice@technimount.com) for more information.

### **1.3.4. User Liability**

The purchaser and administrator are responsible to validate regulations and standards for safety in their region, to comply with applicable safety regulations. Technimount is not responsible to inform the purchaser or the administrator of any applicable legislation for safety in their area.

The administrator is responsible for providing proper training to any personnel who will install, operate and perform maintenance on Technimount products.

## **1.4. Claims**

### **1.4.1. Damaged or Defective Merchandise**

ICC Regulations require that claims for damaged merchandise must be made with the carrier within fifteen (15) days of the reception date. Do not accept damaged merchandise unless such damage is noted on the delivery receipt at the time of reception. Upon prompt notification, Technimount will file a freight claim with the appropriate carrier for damages incurred. Claims are limited in amount to the actual replacement cost. If the claim has not been received by Technimount within the fifteen (15) day period following the date of delivery, or the damage was not noted on the delivery receipt at the time of receipt, the customer will be responsible for the full payment of the original invoice.

Claims for any short or broken merchandise must be made within thirty (30) days of invoicing. For details, refer to the claim process or contact Customer Service at [customerservice@technimount.com](mailto:customerservice@technimount.com).

### 1.4.2. Return Policy

Technimount's mounting and bracket systems for portable medical devices may be returned up to sixty (60) days from the reception date, if:

- The received product does not match what was originally ordered.
- The product does not meet the Technimount technical sheet specifications.
- The product is not compatible with the device on which it was intended to be installed onto.

To return a Technimount product,

- A Return of Merchandise Authorized (RMA) must be requested and approved by Technimount prior to returning the product.
- Products must be returned undamaged and in its original packaging, appropriately identified with the approved RMA number. Returns will not be approved on a modified or damaged item.
- Charges may apply if the package received is damaged or items are missing.
- Purchaser is responsible for a restocking fee (refer to Table 1).

**Table 1:** Restocking fees

RESTOCKING FEES	
Prior to thirty (30) days	10%
Prior to forty-five (45) days	25%
Prior to sixty (60) days	30%

For any manufacturing defect, refer to the conditions within the warranty policy or contact Customer Service at [customerservice@technimount.com](mailto:customerservice@technimount.com) for additional information.

### 1.4.3. Return of Material Authorization (RMA)

The Technimount Customer Service department is responsible for all merchandise returns and will provide a Return of Merchandise Authorization (RMA) number, upon approval. The RMA must be printed and placed on the returned merchandise. Technimount reserves the right to charge shipping and restocking fees (refer to Table 1) for the returned items. Special, modified, or discontinued items are not subject to returns.

### 1.4.4. Claim Process

Upon reception of the returned merchandise, a thorough inspection will be performed. If the merchandise is compliant with the return policy or it is found that the product is defective, Technimount will take corrective actions and close the claim. If, however, it is found that the product is not defective, but rather misused or abused, the product will not be covered by the warranty. Details of our findings and conclusions will be provided shortly thereafter. To submit a claim, contact Customer Service at [customerservice@technimount.com](mailto:customerservice@technimount.com) to obtain a Return of Material Authorization (RMA) form and return instructions.

## 2. General Safety Guidelines

Pictograms, safety symbols and labels are used to alert the user to a potentially hazardous situation, which, if not avoided, may result in minor or moderate injury to the user or patient or cause damage to the device or other property. This includes the special care necessary for the safe and effective use of the device to avoid damage that may occur from use or misuse. The terms "Warning" and "Caution" herein carry special meaning and should be carefully reviewed.

**WARNING** - Indicates a hazardous situation that, if not avoided, could result in death or serious injury.

**CAUTION** - Indicates a hazardous situation that, if not avoided, could result in minor or moderate injury.

Always read and abide by all the safety guidelines identified within this document.

### 2.1. Symbols and Definitions



**WARNING - Hand Crush/Pinch Point**

Indicates an area where mechanical components could move toward each other and might result in a potential crush/pinch hazard.



**WARNING - General Warning**

Alerts the reader of a potentially hazardous situation, which, if not avoided, may result in death or serious injury to the user or patient or cause damage to the device or other property. This includes the special care necessary for the safe and effective use of the device to avoid damage that may occur from use or misuse.



**CAUTION - Safe Working Load/Load Balance**

Indicates the total maximum charge for a safe use of device.



**CAUTION - General Mandatory Action**

Call for action. Alerts the reader to potential risk to people not following the mandatory action specified by the supplementary sign.



**CAUTION - Follow Instructions for Use**

Call for action. Reminds the reader to consult the user manual for information.



**CAUTION - Two (2) Person Lift**

Heavy load. Alerts the reader to a two (2) person lift carrying technique recommendation based on the weight and/or size of the product.



**CAUTION - Transport in a Low Position**

Call for action. Alerts the reader to a carrying technique recommended by the stretcher manufacturer.



## 2.2. Labels

Labelling on the surface of the Technimount product, quickly identify potential risks and provides information to the user. Warning labels (Figure 1) and a manufacturing label, including the serial number (Figure 2), can be seen on the Technimount product.

### 2.2.1. Safety Labels

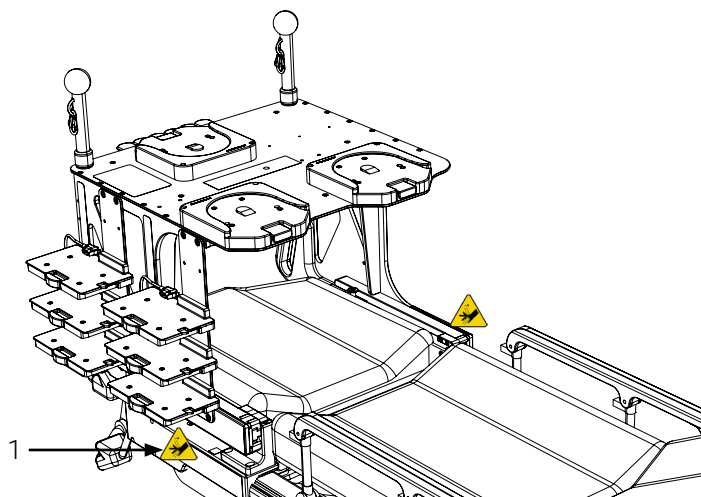

1. Hand crush/Pinch point label

**Figure 1:** Location of the warning labels

### 2.2.2. Manufacturing Label

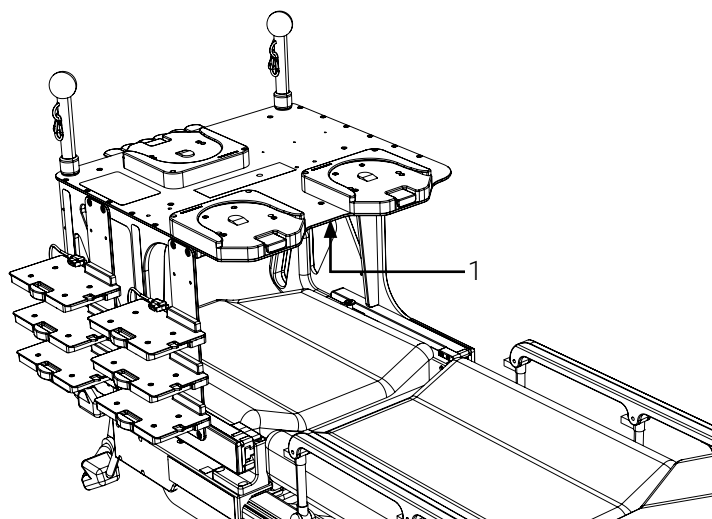

1. Manufacturing label (between the 2 bases, under the top plate)

**Figure 2:** Location of the manufacturing label

## 2.3. Safety Measures

Carefully read all the safety measures herein before installing, operating or performing the maintenance of the Technimount product.



### **WARNING - Risk of Injury**

Regulations and standards for safety are the sole responsibility of the end user. Ensure that the installation specifications meet the local and regional compliance requirements before use. Product incompatibility could cause unpredictable functioning resulting in injury to the patients or EMS personnel.



### **CAUTION - Safe Handling and Operation**

- **Do not** modify the product, or any of its components and use only as described in this user manual. Modifying the product or improper use could cause unpredictable functioning, resulting in injury to the patients or EMS personnel.
- Improper use of the Technimount product may damage the device or cause injury to the patients or EMS personnel.
- The administrator is responsible for providing proper training to any personnel who will install, operate and perform maintenance on Technimount products.
- If any serious incident occurs with the mounting solution, immediately stop using the product, report this incident to Technical Support at [technicalsupport@technimount.com](mailto:technicalsupport@technimount.com) and the applicable regulatory agency.



### **CAUTION - Safe Practice**

- **Do not** transport the stretcher when the mobile structure is in the extended position. Secure the Xtension Pro Assistant - CCT/ECMO in the clamp blocks before moving the stretcher.
- Always keep the lock pins installed during transport. The lock pins should only be removed to insert and remove the mobile structure.
- Always pay close attention to the condition of the safety mechanisms, to prevent undue risk to the device, patients and EMS personnel. Follow the recommended maintenance plan and its guidelines, as described in this user manual and operating guide.
- Always ensure that the medical devices are secured in the bracket and that the locking mechanism is functional before use.
- Always keep the user manual and operating guide within reach of the product, even if the device is subsequently sold, to prevent undue risk to the device, patients and EMS personnel. The user documentation is an integral part of the device.
- Practice installing, removing and safely operating the medical devices until the manipulations have been perfected, before use with patients. Improper use of any Technimount product may damage the device or cause injury to the patients or EMS personnel.



### **CAUTION - Working Load/Load Balance**

- **Do not** overload the system. The Safe Working Load (SWL) is 103 lbs (46.8 kg).
- **Do not** overload the push bars. The maximum weight capacity for transport is 2 L or 2 kg (67.63 fl oz or 4.4 lbs) per push bar at the head end of the stretcher and 1 L or 1 kg (33.81 fl oz or 2.2 lbs) per push bar at the foot end of the stretcher.
- The Techni-IV pole is approved for ambulance transport. The maximum weight capacity approved for transport is 1.5 L or 1.5 kg (50 fl oz or 3.3 lb).

**CAUTION - Transport in a Low Position**

The stretcher manufacturer recommends transporting the stretcher at the lowest possible height to avoid back injuries or tipping incidents. Refer to the stretcher manufacturer user manual for safety precautions and user instructions for the safe use of the stretcher.

**CAUTION - Two (2) Person Lift**

Trained EMS personnel are required to safely lift the Technimount product.

**CAUTION - Follow Instructions for Use**

- Always read and abide by all the safety guidelines identified, as well as follow instructions provided within this document.
- Refer to the stretcher user manual for safety precautions and user instructions for the safe use of the Stryker® Power-PRO™ XT stretcher.

### 3. Technical Specifications

<b>Product Name</b>	Xtension Pro™ Assistant - CCT/ECMO
<b>Description</b>	Mounting system for ECMO and ground critical care transport on a Stryker® Power-PRO™ XT stretcher.
<b>Part Number</b>	1650-00-PFXT-EC
<b>Features</b>	<ul style="list-style-type: none"> <li>- 3 Standard Surface Bases to secure the Getinge Cardiohelp™ System, HAMILTON-T1™ and ZOLL X Series® on the mobile structure</li> <li>- Medical grade power bar with surge protection</li> <li>- Gliding system</li> <li>- Installation of up to 6 Baxter Spectrum® IQ or B. Braun Infusomat® Space®/Perfusor® Space® pumps</li> </ul>
<b>Operating Environment<sup>1</sup></b>	EMS/CCT (ground)
<b>Compliance</b>	Tested in compliance with SAE J3043
<b>Compatible Stretcher<sup>2</sup></b>	Stryker® Power-PRO™ XT
<b>Compatible Mounting System</b>	Technimount Bracket Pro Serie® mounting systems with standard bottom disc
<b>Dimensions (W X D X H)</b>	25.2 in. X 28.6 in. X 22.6 in. (64 cm X 72.7 cm X 57.4 cm)
<b>Weight</b>	<ul style="list-style-type: none"> <li>- Mobile structure with 3 Standard Surface Bases: 41.2 lbs (18.7 kg)</li> <li>- Clamp blocks with rail systems: 26.9 lbs (12.3 kg)</li> <li>- B. Braun infusion pump bracket: 9.2 lbs (4.2 kg)</li> <li>- Baxter infusion pump bracket: 6.2 lbs (2.9 kg)</li> </ul>
<b>Composition</b>	<ul style="list-style-type: none"> <li>- Mobile structure: aluminum 6061-T6, black anodized finish</li> <li>- Clamp blocks: aluminum 6061-T6, black anodized finish</li> <li>- Rail system: aluminum 6061-T6 and stainless steel</li> <li>- Locking handle: aluminum 6061-T6 and acetal</li> </ul>
<b>Safe Working Load (SWL)</b>	103 lbs (46.8 kg)
<b>Operating Temperature</b>	- 31° F to 113° F (- 35° C to 45° C)
<b>Installation</b>	<ul style="list-style-type: none"> <li>- Slides onto the rail system that is held by 2 clamp blocks installed on the stretcher side rails. The system is locked in place</li> <li>- Locking handle located at the foot end of the stretcher</li> </ul>
<b>Model &amp; Configuration Options</b>	<ul style="list-style-type: none"> <li>- Techni-IV pole approved for ambulance transport - maximum weight capacity of 1.5 L or 1.5 kg (50 fl oz or 3.3 lb)</li> <li>- Up to 2 power bars (6 outlets per bar)</li> <li>- Spectrum® IQ or B. Braun Infusomat® Space®/Perfusor® Space® infusion pump brackets</li> <li>- Push bars (head end and foot end)</li> <li>- Contact Customer Service at <a href="mailto:customerservice@technimount.com">customerservice@technimount.com</a> for more options</li> </ul>

<sup>1</sup> For air transport, contact Customer Service at [customerservice@technimount.com](mailto:customerservice@technimount.com).

<sup>2</sup> Product and medical device manufacturer names are Trademarks™ or Registered Trademarks® of their respective holders. Technimount does not have a commercial relationship with these manufacturers.

#### 4. Unpack the Mounting System

1. Inspect the shipping box(es) for signs of damage, before accepting shipment. Take pictures and report them promptly if applicable.
2. Move the shipping box(es) to the location of the installation.
3. Open the shipping box(es).
4. Unpack the box(es) and ensure that all shipping and packaging materials have been properly removed, prior to installation.  
**NOTE:** Keep all packaging material for future use.
5. Identify all the components and hardware included for the installation, then set aside. Refer to Section 6.1 for the required parts.
6. Inspect the items for signs of damage. Take pictures and report them promptly if applicable.

## 5. Xtension Pro Assistant - CCT/ECMO Illustrated Parts

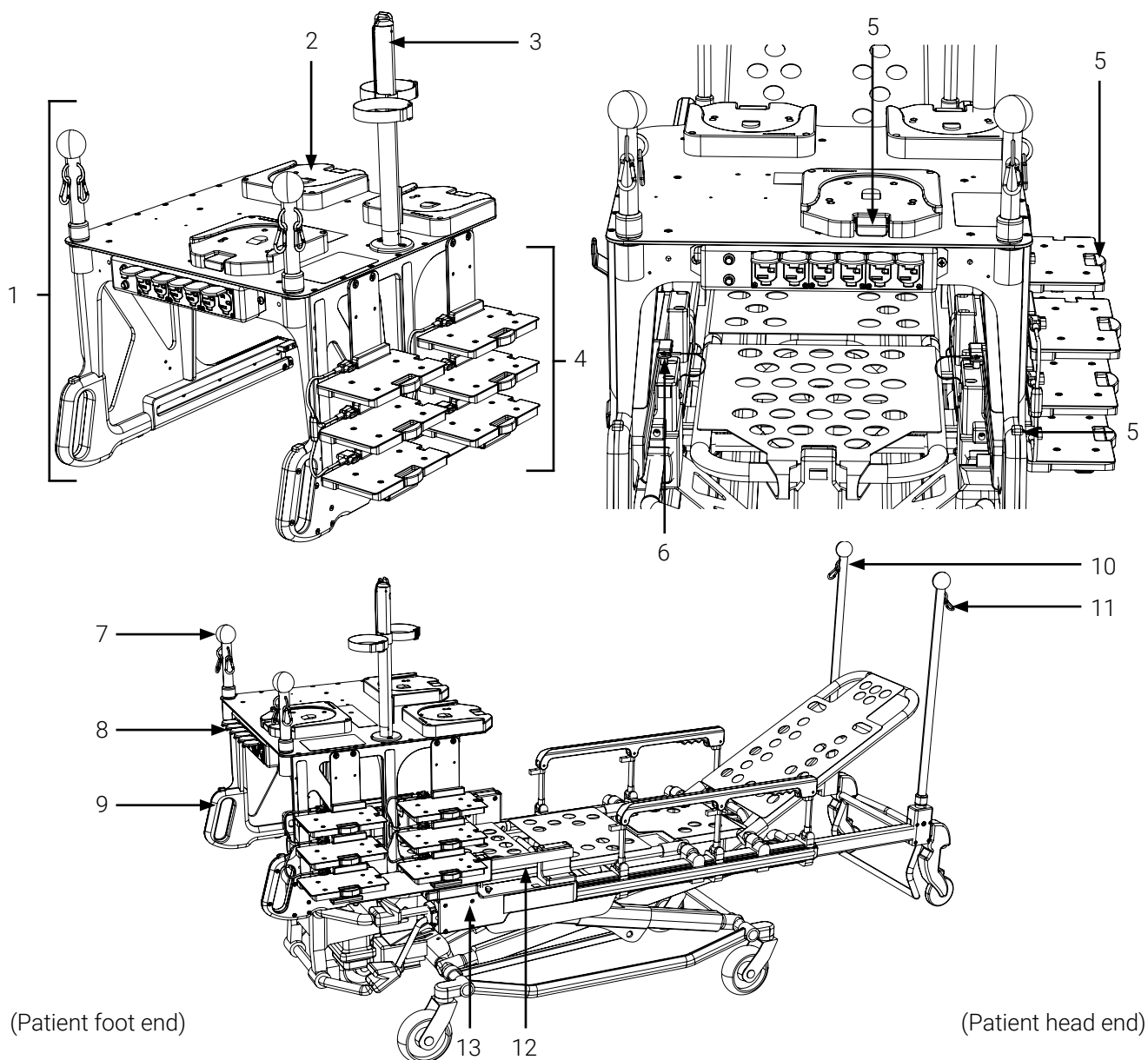

- |                                |                                 |
|--------------------------------|---------------------------------|
| 1. Mobile structure            | 8. Power bar                    |
| 2. Standard Surface Base       | 9. Handle                       |
| 3. Techni-IV pole with strap   | 10. Push bar (patient head end) |
| 4. Infusion pump bracket       | 11. Carabiner for fluid bags    |
| 5. Red quick release mechanism | 12. Rail system                 |
| 6. Lock pin                    | 13. Clamp block                 |
| 7. Push bar (patient foot end) |                                 |

**Figure 3:** Xtension Pro Assistant - CCT/ECMO Illustrated Parts

## 6. Assemble the Mounting System

Technimount reserves the right to change part numbers and products without notice. Please contact Customer Service at [customerservice@technimount.com](mailto:customerservice@technimount.com) to ensure product options and availability.



### **WARNING - Hand Crush/Pinch Point**

**Do not** put hands or fingers on or near the side clamp blocks or rail system when installing or removing the mobile structure to avoid injury.



### **WARNING - Part Breakage**

**Do not** use powered tools to screw the hardware during installation, as there is a potential risk of damage to the threads. All the provided hardware has been previously prepped with thread locking adhesive and is ready to be used as is.



### **CAUTION - Follow Instructions for Use**

**Do not** remove the mobile structure until the medical device have been removed to perform maintenance operations.

**NOTE:** Image references within this user manual may differ from actual product. For assistance, please contact Technical Support at [techsupport@technimount.com](mailto:techsupport@technimount.com).

## 6.1. Required Assembly Parts

The clamp blocks and rail systems require assembly. Refer to Figure 4, Figure 5 and Figure 6 for the required illustrated parts/kits.

**NOTE:** All the provided hardware has been previously prepped with thread locking adhesive and is ready to be used as is.

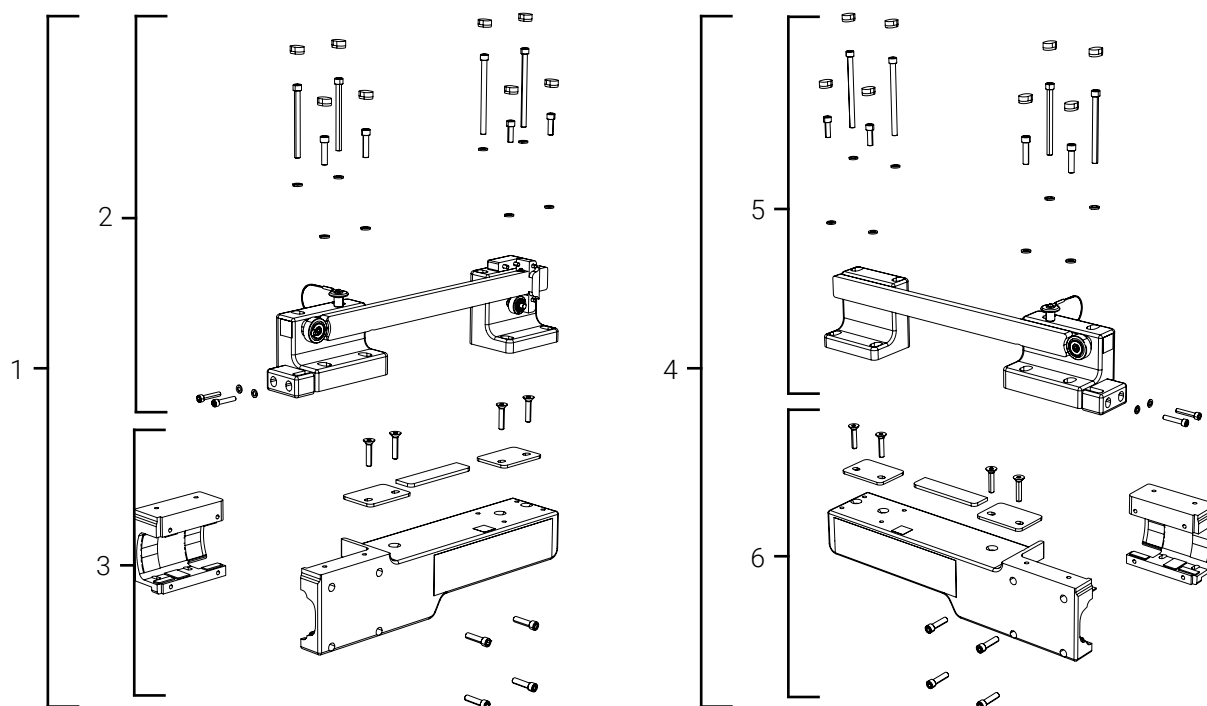

- |   |  |
|---|--|
| 1. Complete clamp block assembly (patient left) | 4. Complete clamp block assembly (patient right) |
| 2. Rail system (patient left)                   | 5. Rail system (patient right)                   |
| 3. Clamp block (patient left)                   | 6. Clamp block (patient right)                   |

**Figure 4:** Clamp block assemblies



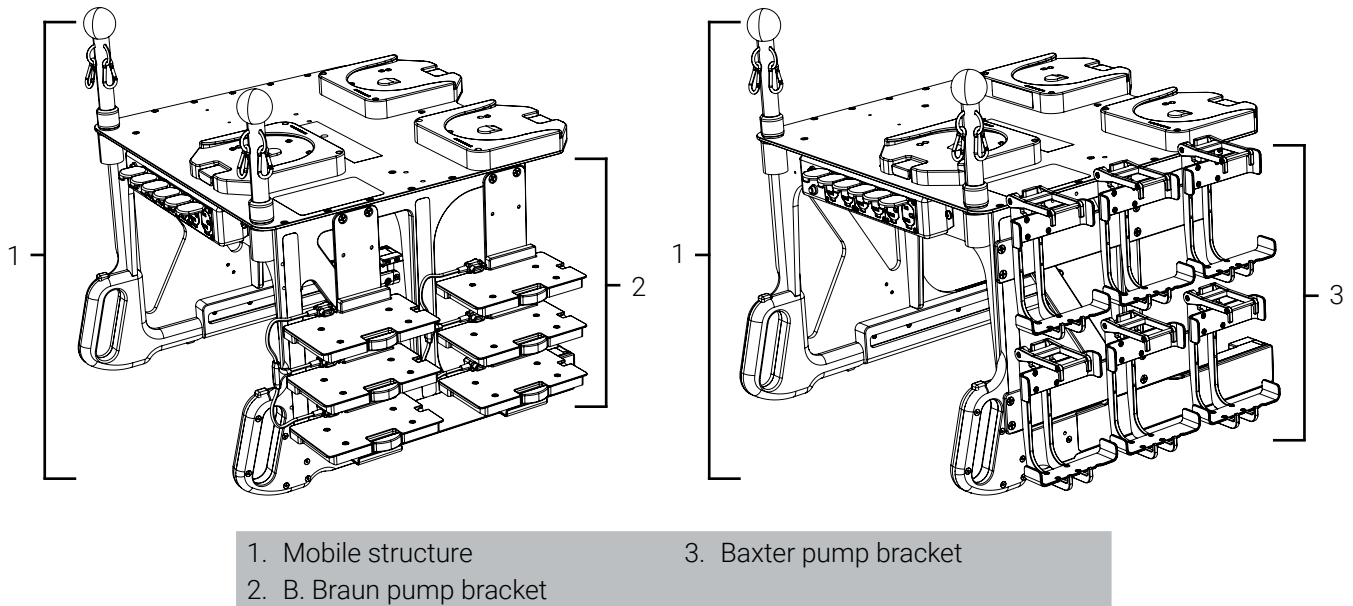

**Figure 5:** Mobile structure

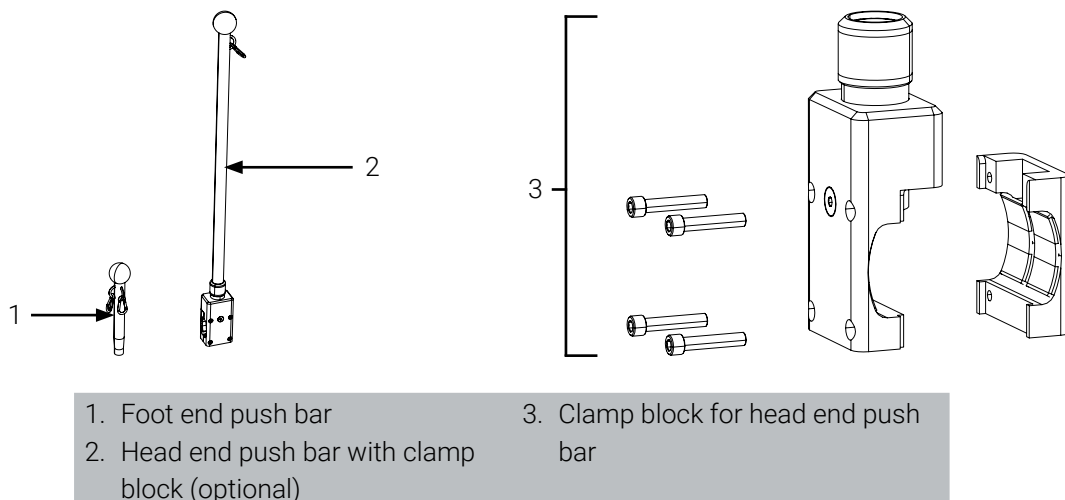

**Figure 6:** Safe Working Load (SWL) label

## 6.2. Optional Assembly Parts

If your configuration includes optional assembly parts/kits, refer to Figure 7 and Figure 8 for illustrations.

**NOTE:** All the provided hardware has been previously prepped with thread locking adhesive and is ready to be used as is.



**Figure 7:** Push bars

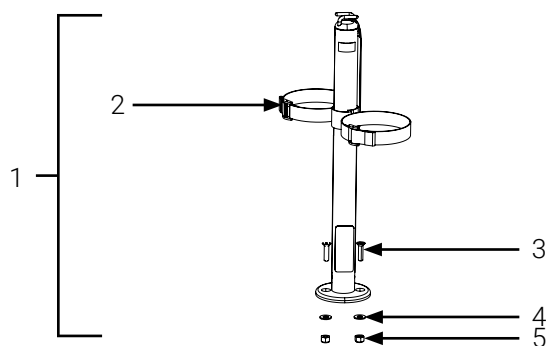

- |  |                                      |
|--|--------------------------------------|
| 1. Techni-IV Pole  | 4. Washers (2X)                      |
| 2. Strap   | 5. Nylon-insert locknuts ¼ - 20 (2X) |
| 3. Flat head Philips drive screws<br>¼ - 20 X 1 in. (2X) |                                      |

**Figure 8:** Techni-IV Pole and strap

### 6.3. Required Tools

- Allen key 3/16 in.
- Allen key 5/32 in.
- Key 7/16 in.
- Philips screwdriver #2
- Torx screwdriver T27

### 6.4. Stretcher Orientation

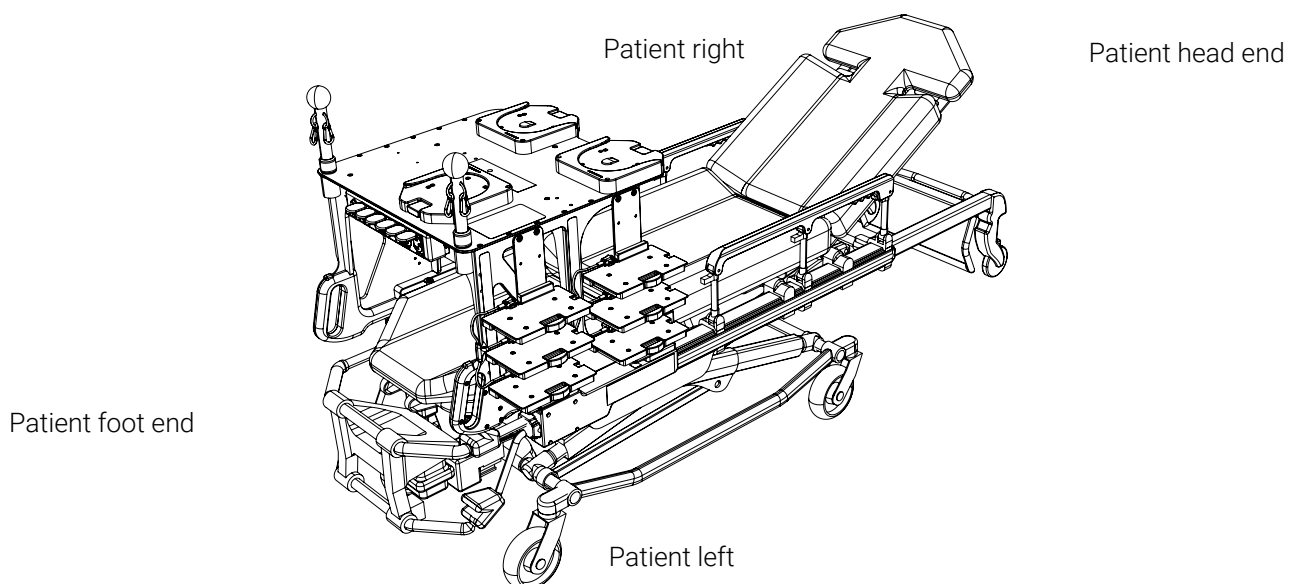
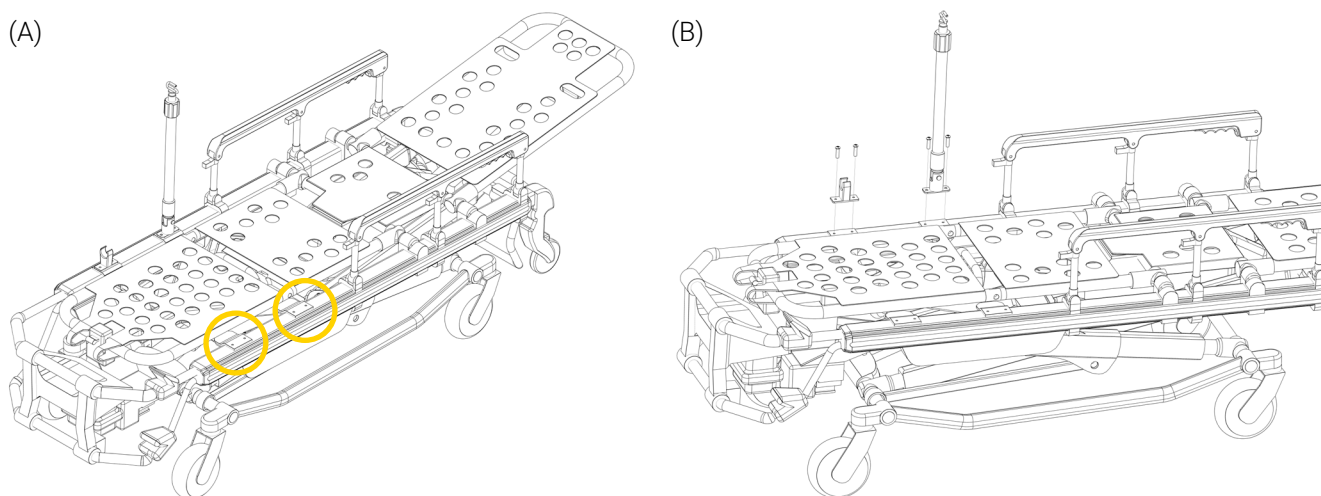

**Figure 9:** Stretcher orientation diagram

## 6.5. Prepare the Stretcher

**NOTE:** Refer to the established protocols and the stretcher operation manual for proper use and recommendations.

1. Remove all the devices from the stretcher.
2. Remove the mattress from the stretcher to facilitate the installation.
3. Remove the four (4) screws on the rail, patient left (Figure 10 A). The screw will not be reused for this specific installation.
4. Remove the IV pole and its holder (Figure 10 B). They will not be reused for this specific installation.



**Figure 10:** Stretcher preparation

5. At the patient foot end, identify the Power-LOAD foot end fastener assembly (herein after referred to as Power-LOAD system) located under the stretcher (Figure 11).
6. Remove the four (4) screws, four (4) washers and two (2) spacers to loosen the Power-LOAD system. Set aside the hardware for a later step (Figure 11).

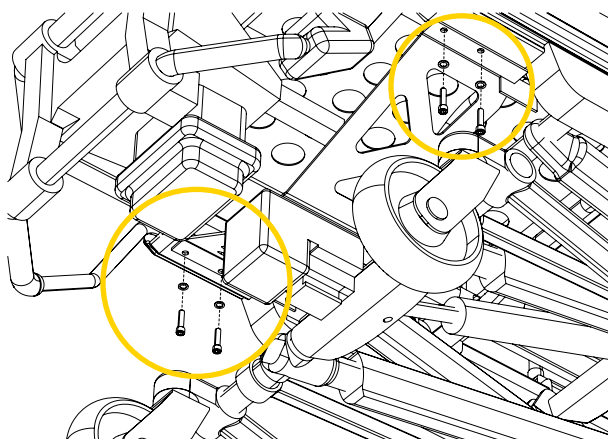

**Figure 11:** Removal of the Power-LOAD system screws

7. Loosen the nuts on either side of the Power-LOAD system (Figure 12), enough to allow space for the installation of the clamp blocks, if required.

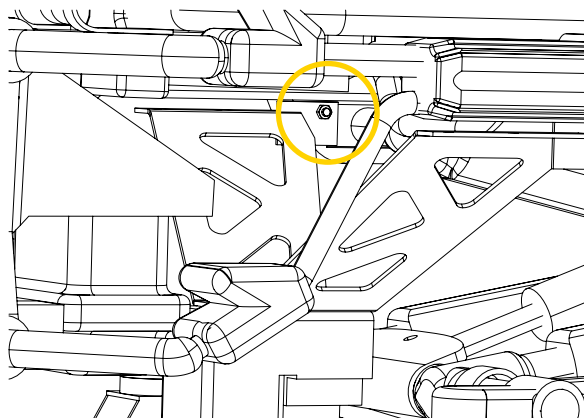
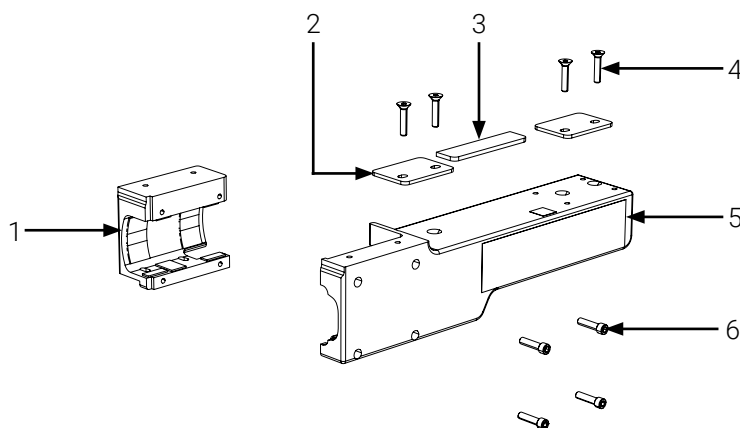

**Figure 12:** Loosening of the Power-LOAD system (1 of 2 nuts shown)

#### 6.6. Install the Clamp Blocks on the Stretcher Siderail

**NOTE:** Two (2) clamp blocks are provided for this installation. Ensure to install the clamp block included in the complete clamp block assembly 1620-11-PFXT-LFS on patient left and the clamp block included in the complete clamp block assembly 1620-11-PFXT-RHS on patient right.

1. Identify the clamp block components included in the complete clamp block assembly 1620-11-PFXT-LFS (Figure 13); the clamp block will be installed on patient left.
2. Select the type of spacer that corresponds to the type of stretcher you have, either with or without a knee gatch (Figure 13).



- |  |  |
|--|--|
| 1. Interior part of the clamp block                  | 5. Exterior part of the clamp block        |
| 2. Spacer without knee gatch (2X)                    | 6. Socket head screws, ¼ - 20 x 1 in. (4X) |
| 3. Spacer with knee gatch                            |  |
| 4. Flat head hex drive screws, ¼ - 20 x 1 ¼ in. (4X) |  |

**Figure 13:** Clamp block parts (patient left shown here)

3. Place spacers (with or without knee gatch) between the clamp block and stretcher (Figure 14):
  - If your stretcher does not have a knee gatch, place two (2) spacers without knee gatches under the clamp block and position the clamp block on the stretcher (Figure 14).

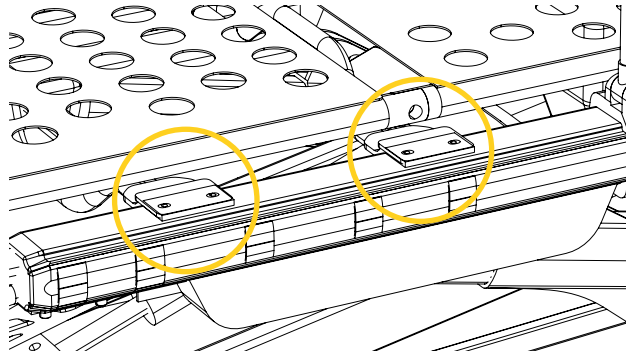

**Figure 14:** Spacers (without knee gatch shown here)

- If your stretcher has a knee gatch, place one (1) spacer with a knee gatch under the clamp block and position the clamp block on the stretcher (Figure 15).

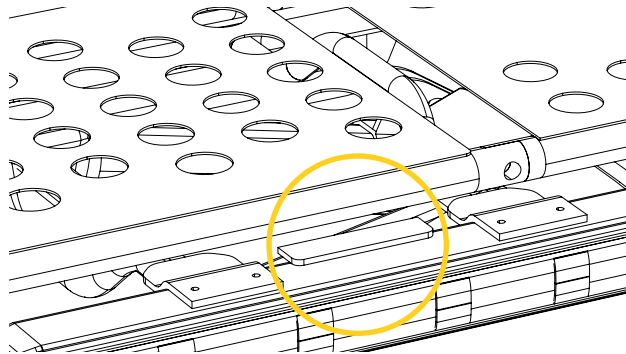

**Figure 15:** Spacer (with knee gatch shown here)

4. Position the exterior part of the clamp block on the outer frame of the stretcher (Figure 16).
5. Insert and tighten the four (4) flat head hex drive screws, ¼ - 20 x 1 ¼ in. on the top of the clamp block using an Allen key 5/32 in. (Figure 16).

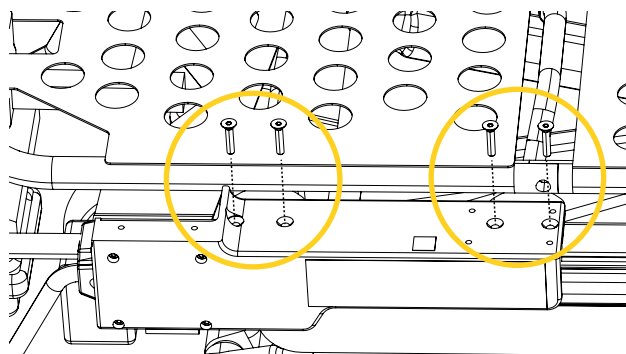

**Figure 16:** Installation of the exterior clamp block

6. Position the interior clamp block on the inner frame of the stretcher (Figure 17 A).
7. Insert and tighten all four (4) socket head screws, ¼ - 20 x 1 in., while alternating screw heads using an Allen key 3/16 in. (Figure 17 A).
8. Ensure that there are no gaps between the interior and exterior parts of the clamp block and that they are evenly pressed against each other (Figure 17 B).

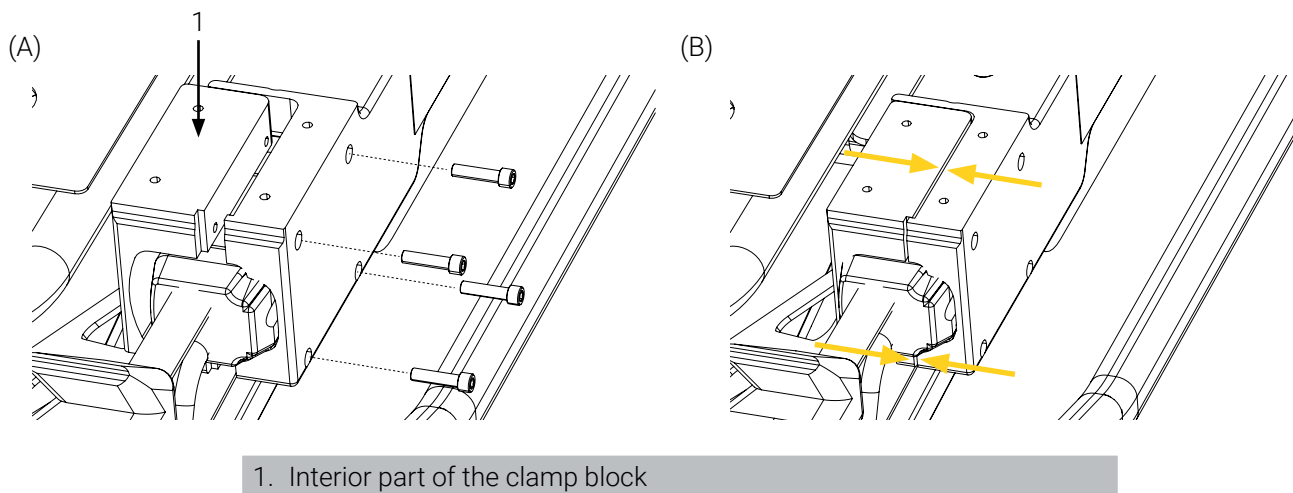

**Figure 17:** Installation of the interior part of the clamp block

9. Repeat steps 2 to 8 on patient right, with the clamp block included in the complete clamp block assembly 1620-11-PFXT-RHS (Figure 18).

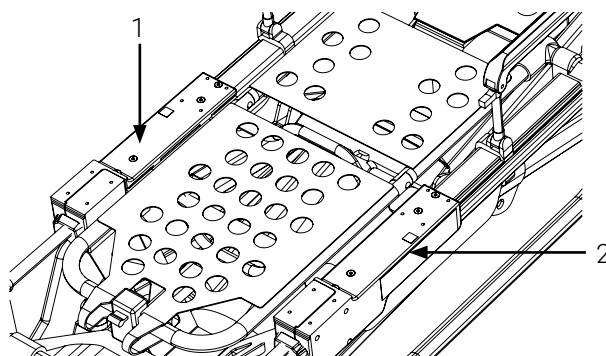

- |  |   |
|--|---|
| 1. Clamp block patient right<br>(1620-11-PFXT-RHS) | 2. Clamp block patient left<br>(1620-11-PFXT-LFS) |
|--|---|

**Figure 18:** Clamp blocks installed

10. On patient left first (without slot), reinstall the Power-LOAD system that was removed previously when loosening the system, using the two (2) of the four (4) socket head screws, ¼ - 20 in. with two (2) washers and Allen key 3/16 in. (Figure 19 A).
11. Reinstall the remaining two (2) socket head screws, ¼ - 20 in. and washers on patient right, using an Allen key 3/16 in. (Figure 19 B).

**NOTE:** Do not reinstall the two (2) Power-LOAD system stretcher spacers.

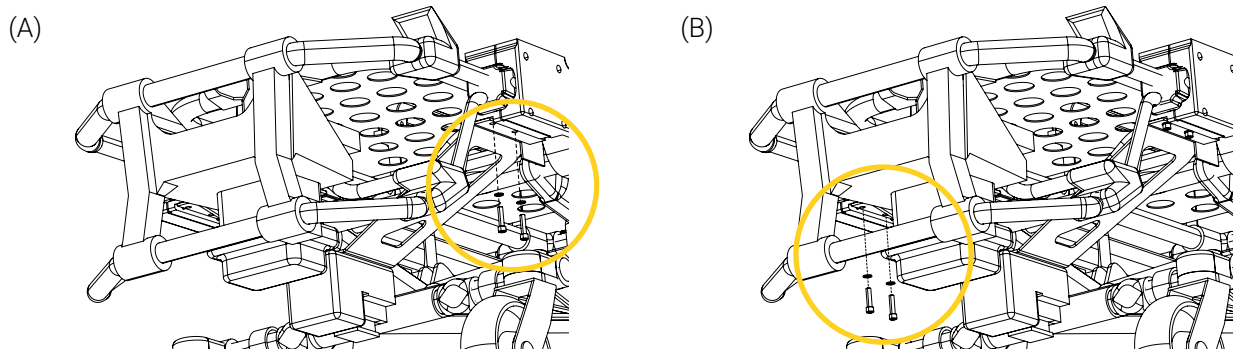

**Figure 19:** Re-installation of the Power-LOAD system (1 of 2)

12. Tighten the four (4) socket head screws, ¼ - 20 on each side of the Power-LOAD system using an Allen key 3/16 in. (Figure 20 A).
13. Tighten the two (2) nuts on either side of the Power-LOAD system that were previously loosened, if required (Figure 20 B).

**NOTE:** Ensure that the Power-LOAD system is properly installed for loading in an ambulance.

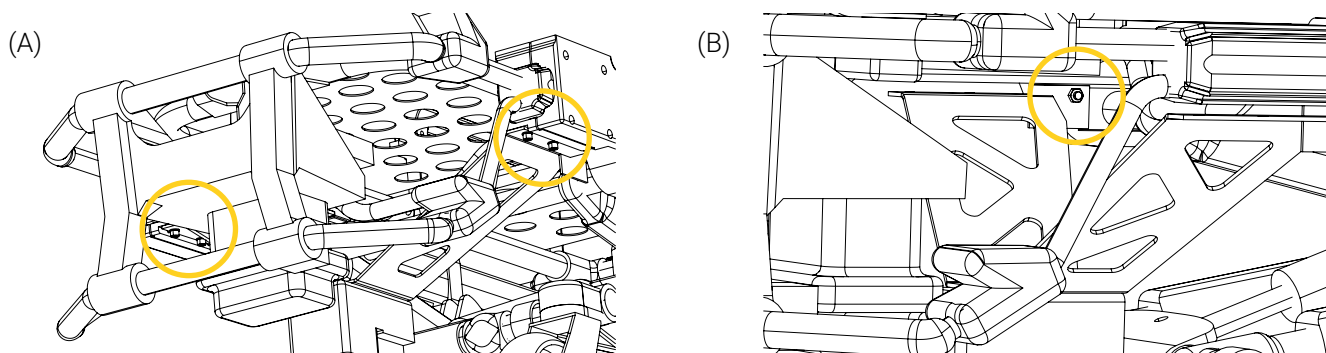

**Figure 20:** Re-installation of the Power-LOAD system (2 of 2)



## 6.7. Install the Rail Systems

**NOTE:** Two (2) rail systems are provided for this installation. Ensure to install the rail system included in the complete clamp block assembly 1620-11-PFXT-LFS on patient left and the rail system included in the complete clamp block assembly 1620-11-PFXT-RHS on patient right.

1. Identify the rail system components included in the complete clamp block assembly 1620-11-PFXT-LFS (Figure 21); the rail system will be installed on patient left.

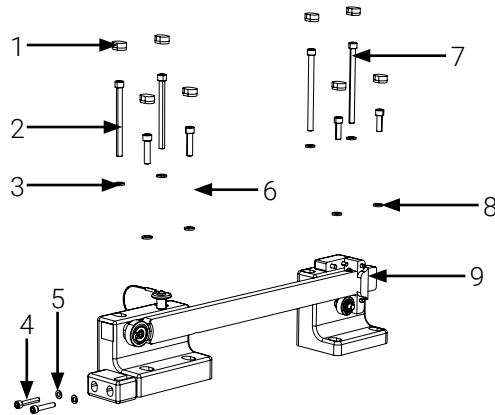

1. Caps (8X)	6. Socket head screw, ¼ - 20 x 1 in. (2X)
2. Socket head screw, ¼ - 20 x 3 in. (2X)	7. Socket head screw, ¼ - 20 x 3.5 in. (2X)
3. Washer for ¼ screws (8X)	8. Socket head screw, ¼ - 20 x ¾ in. (2X)
4. Socket head screw, 1 - 32 x 1 in. (2X)	9. Rail system (patient left)
5. Washer for #10 screws (2X)	

**Figure 21:** Rail system parts (installation for patient left shown here)

2. Position the rail system on the clamp block, ensuring that the screw holes are aligned and that the rail system is facing outwards (Figure 22).

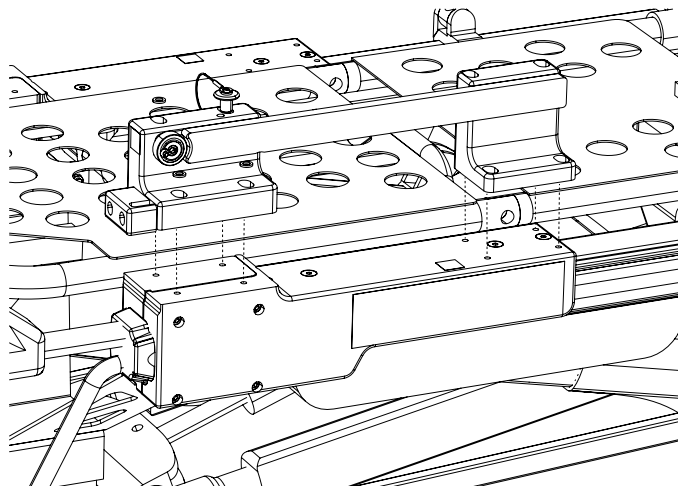

**Figure 22:** Rail system position on clamp block



3. Partially tighten the eight (8) screws and eight (8) washers on both sides, but do not tighten. The screws will be tightened in another step.
  - Towards the foot end (Figure 23 A), screw:
    - Two (2) socket head screws,  $\frac{1}{4}$  - 20 x 3 in. with two (2) washers for  $\frac{1}{4}$  screws using an Allen key  $\frac{3}{16}$  in.
    - Two (2) socket head screws,  $\frac{1}{4}$  - 20 x 1 in. with two (2) washers for  $\frac{1}{4}$  screws using an Allen key  $\frac{3}{16}$  in.
  - Towards the head end (Figure 23 B), screw:
    - Two (2) socket head screws,  $\frac{1}{4}$  - 20 x 3.5 in. with two (2) washers for  $\frac{1}{4}$  screws using an Allen key  $\frac{3}{16}$  in.
    - Two (2) socket head screws,  $\frac{1}{4}$  - 20 x  $\frac{3}{4}$  in. with two (2) washers for  $\frac{1}{4}$  screws using an Allen key  $\frac{3}{16}$  in.

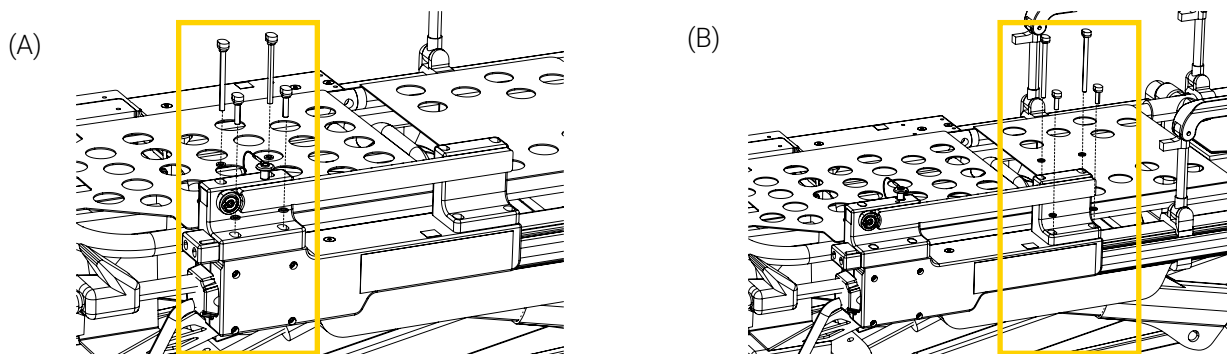

**Figure 23:** Installation of the clamp the rail system

4. Loosen the small block located at the front of the rail system to adjust the rail system using an Allen key  $\frac{5}{32}$  in., if required (Figure 24).

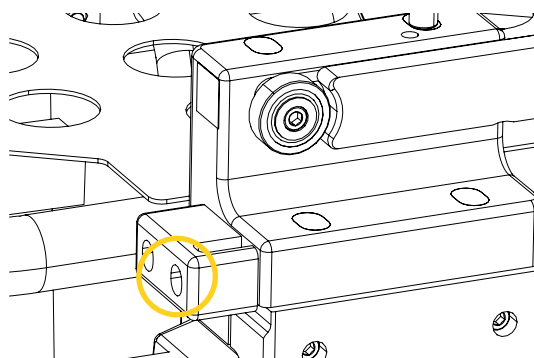

**Figure 24:** Rail system adjustment

5. Repeat steps 2 to 4 on patient right, with the rail system included in the complete clamp block assembly 1620-11-PFXT-RHS.

## 6.8. Install the Mobile Structure

1. Adjust the height of the stretcher to a comfortable position to install the mobile structure using the mechanisms (Figure 25).

**NOTE:** Refer to the stretcher operation manual for proper use and recommendations.

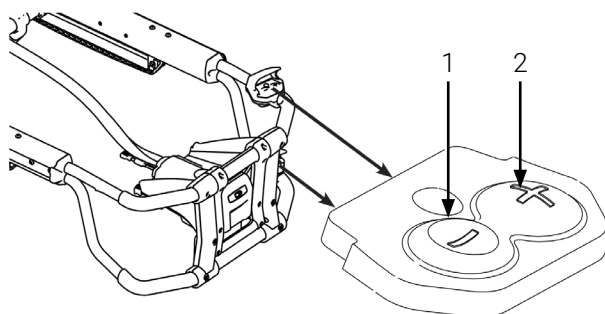

1. Lower the stretcher

2. Raise the stretcher

**Figure 25:** Mechanisms to lift and lower the stretcher

2. Remove the lock pins from the clamp blocks on the both sides of the stretcher, if required (Figure 26).

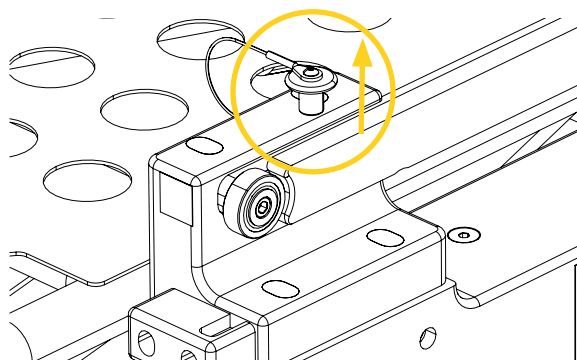

**Figure 26:** Lock pin removal

3. Lift the mobile structure.



**CAUTION - Two (2) person lift**

Trained EMS personnel are required to safely lift, install and remove the mobile structure.

4. Align the mobile structure with the rails, then insert onto the rail system (Figure 27 A).
5. Push the mobile structure all the way to the end of the rail system until it locks (Figure 27 B).

**NOTE:** It is possible to feel some resistance while inserting the mobile structure onto the rail system the first time. This is normal, as this step is to ensure the proper alignment of the mobile structure on the rail system. Once the screws have been tightened following the installation, the insertion and removal of the structure should be smoother.

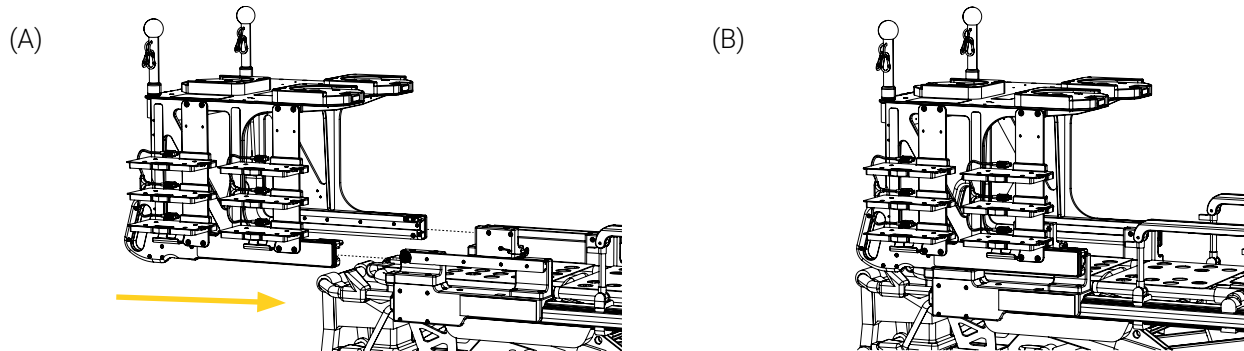

**Figure 27:** Mobile structure installation

6. Tighten the three (3) accessible screws located on the top of each rail (Figure 28), using an Allen key 3/16 in. The fourth screw will be tightened at a later step.

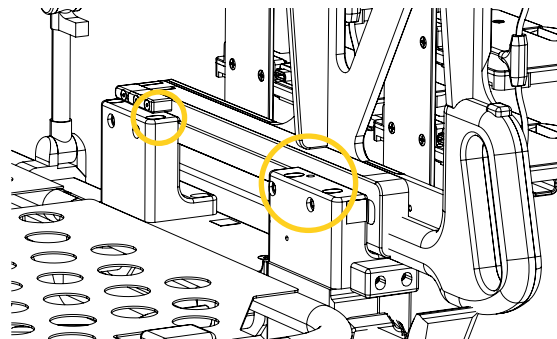

**Figure 28:** Rail system hardware adjustment

7. Grab the mobile structure handles, then press and hold the red quick release mechanisms (Figure 29).

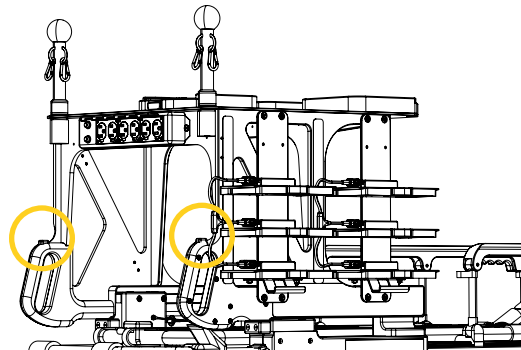

**Figure 29:** Mobile structure red quick release mechanisms

8. Pull the mobile structure towards the patient foot end, until it has been removed (Figure 30).

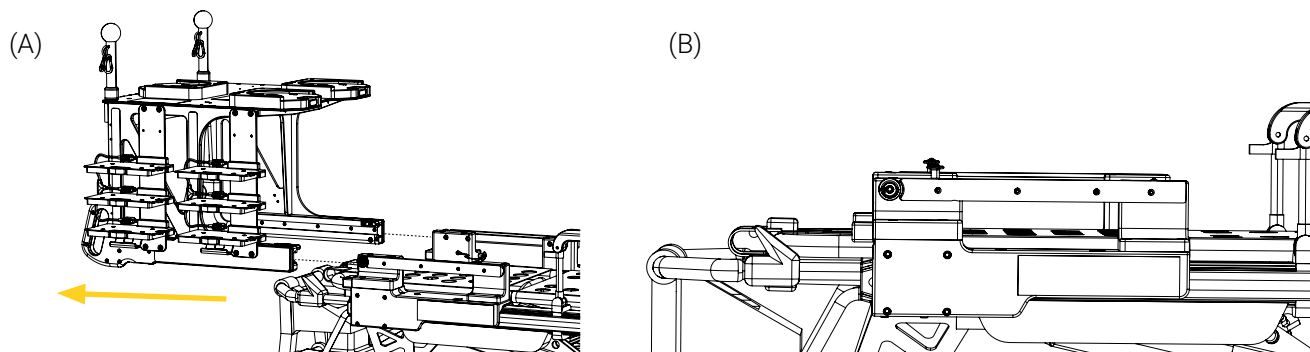

**Figure 30:** Mobile structure removal

9. Tighten the screw (located on the top of each rail) that was not accessible in the previous step, using an Allen key 3/16 in. (Figure 31).

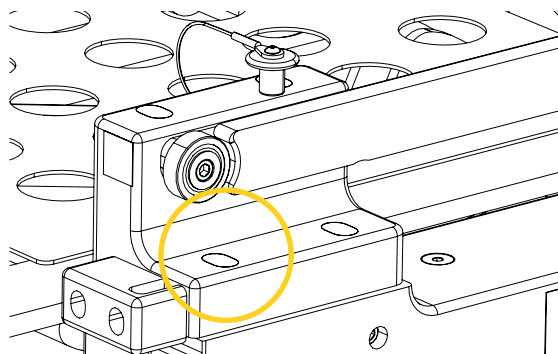

**Figure 31:** Tightening the screw on top of the rail system

10. Tighten the remaining eight (8) screws of the rail system, using an Allen key 3/16 in.
11. Reinstall the mobile structure to ensure that the mobile structure easily glides on the rail system. If not, repeat steps 3 to 10.
12. Tighten the small blocks at the end of each rail, using an Allen key 3/16 in. (Figure 32 A). Leave a gap between 1/32 - 1/16 in. between the blocks and the end of the rail system (Figure 32 B).

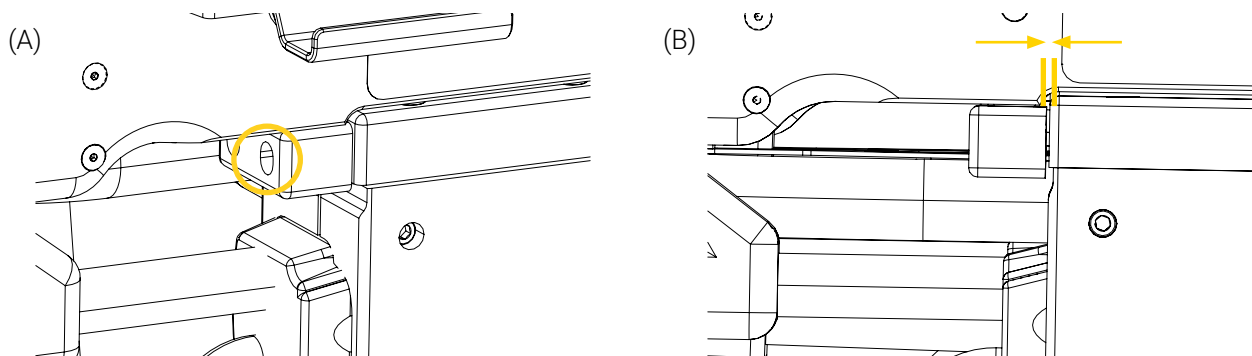

**Figure 32:** Rail system blocks

13. Ensure that all the screws are properly tightened, but **do not** over tighten.

14. Reinstall the lock pins on the clamp blocks on the both sides (Figure 33), making sure that the lock pins are properly inserted.

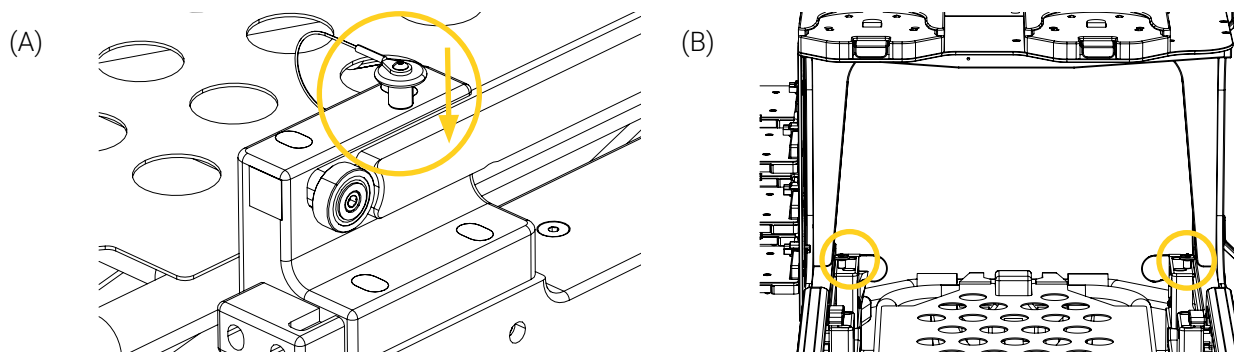

**Figure 33:** Lock pins installed

15. Place a Safe Working Load (SWL) label between the mobile structure and rail system, on both sides of the stretcher (Figure 34).

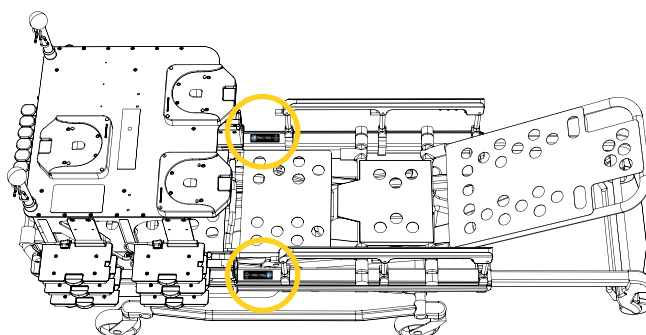

**Figure 34:** Safe Working Load (SWL) labels installation

The Xtension Pro Assistant - CCT/ECMO System is now ready for use and transport (Figure 35).

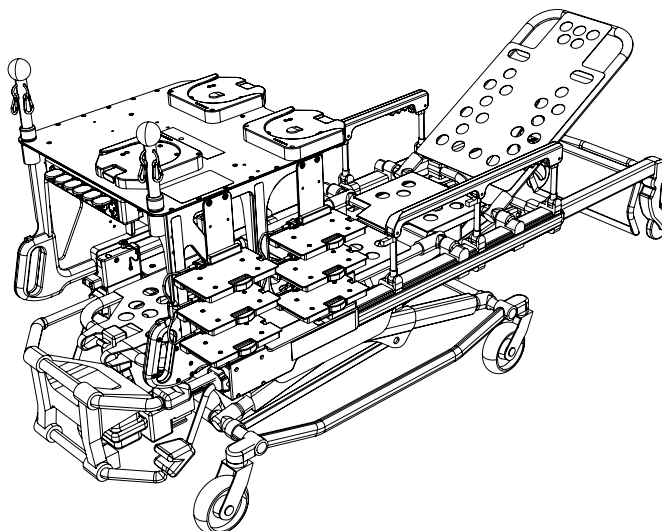

**Figure 35:** Xtension Pro Assistant - CCT/ECMO installed

## 6.9. Install the Push Bars Into the Clamp Blocks at the Patient Head End (optional)

1. Identify the push bar clamp block parts (Figure 36).

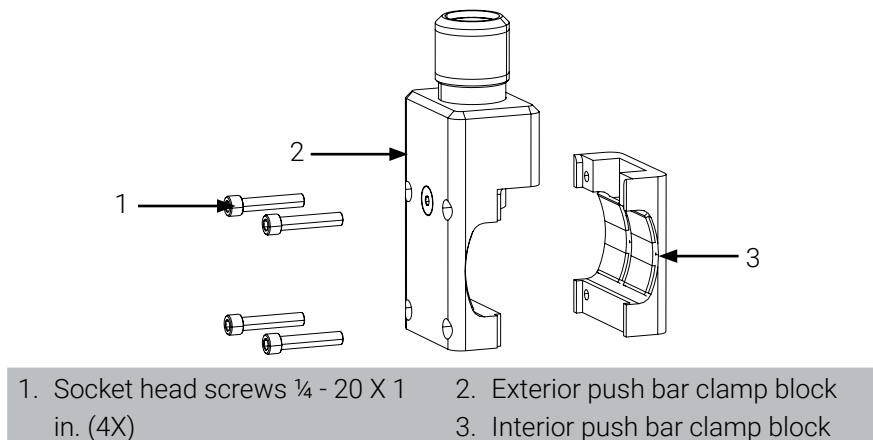

**Figure 36:** Push bar clamp block parts

2. Lift the backrest of the stretcher upright to allow space for the installation of the clamp blocks.
3. Position the exterior clamp block on the outside of the stretcher frame, then the interior clamp block on the inside of the stretcher frame (Figure 37 A). Leave a 3/4 in. space between the clamp block and the end of the stretcher.
4. Insert and tighten the four (4) flat head hex drive screws 1/4 - 20 X 1 in. using an Allen key 5/32 in., alternating screw heads (Figure 37 A).
5. Repeat steps 3 and 4 on the other side of the stretcher to install the second clamp block (Figure 37 B).

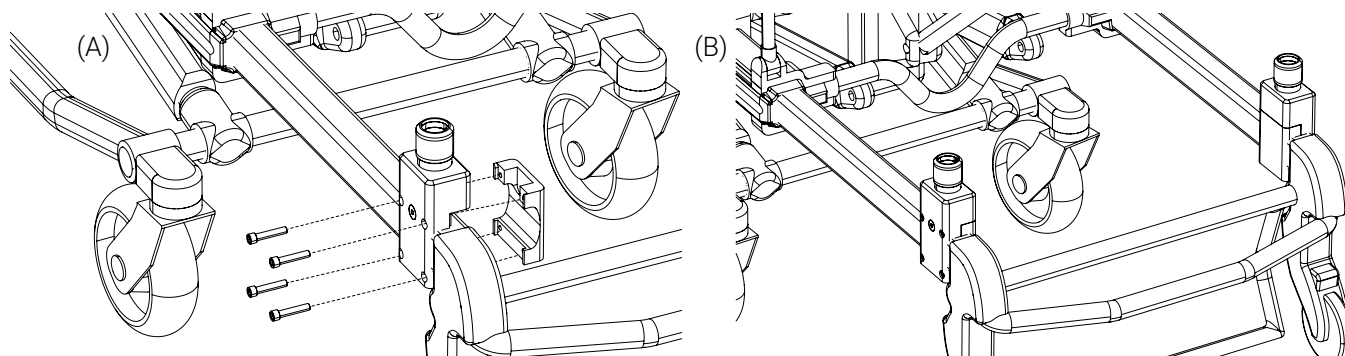

**Figure 37:** Clamp block installation - Push bar, patient head end

6. Loosen the clamp block collar by rotating counter clockwise, about a quarter of a turn, then insert a push bar into the clamp block (Figure 38 A).
7. Tighten the collar (Figure 38 B), ensuring the push bar is secured.
8. Repeat steps 6 and 7 for the installation of the second head end push bar.

**NOTE:** Use a carabiner to hold the IV bag(s). The maximum weight capacity for transport is 2 L or 2 kg (67.63 fl oz or 4.4 lbs) per push bar.

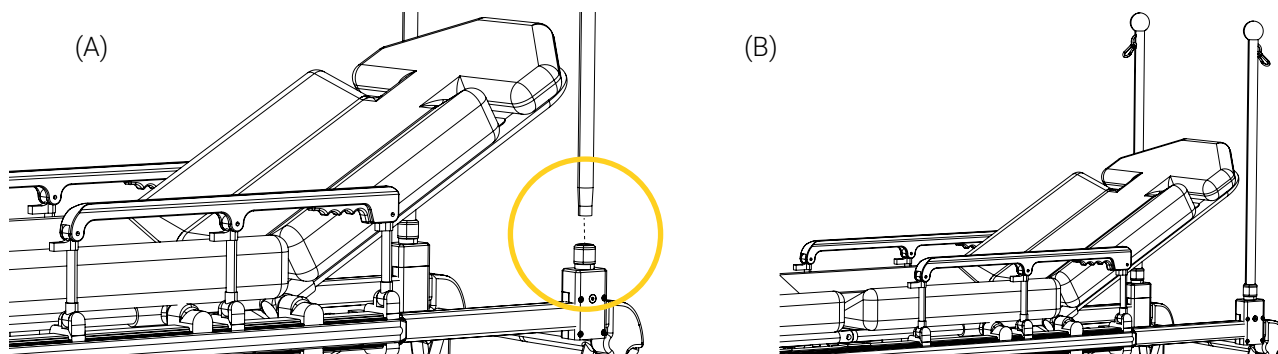
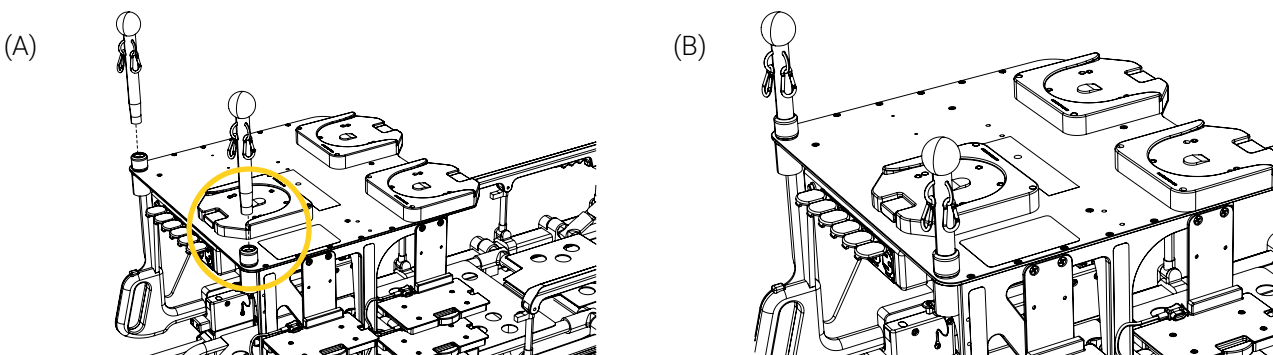

**Figure 38:** Push bar installation - Patient head end

#### 6.10. Install the Push Bars on the Mobile Structure (optional)

1. Loosen the clamp block collar by rotating counter clockwise, about a quarter of a turn, then insert a push bar into the clamp block (Figure 39 A).
2. Tighten the collar (Figure 39 B), ensuring the push bar is secured.
3. Repeat steps 1 to 2 for the installation of the second push bar.

**NOTE:** Use a carabiner to hold the IV bag(s). The maximum weight capacity for transport is 1 L or 1 kg (33.81 fl oz or 2.2 lbs) per push bar.



**Figure 39:** Push bar installation - Patient foot end

### 6.11. Install the Power Bar (optional)

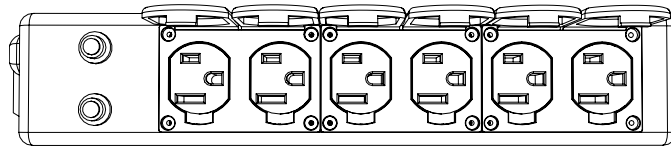

**Figure 40:** Power bar

1. Remove the two (2) nuts and two (2) washers from the back of the mobile structure plate, using a Philips screwdriver #2 (Figure 41 A).
2. Insert the power bar holes in the screws (Figure 41 B).
3. If required, insert a second power bar back-to-back, ensuring that the plug sockets are accessible.
4. Reinsert the two (2) nuts and two (2) washers, then tighten using a Philips screwdriver #2 (Figure 41 B).

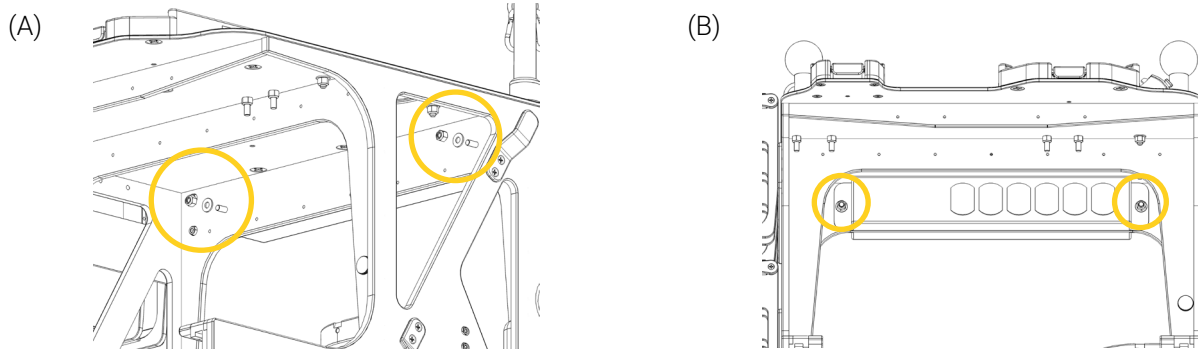

**Figure 41:** Power bar installation



## 6.12. Install the Techni-IV Pole (optional)

**NOTE:** The Techni-IV pole is approved for ambulance transport. The maximum weight capacity approved for transport is 1.5 L or 1.5 kg (50 fl oz or 3.3 lb).

1. Identify the Techni-IV pole parts (Figure 42).

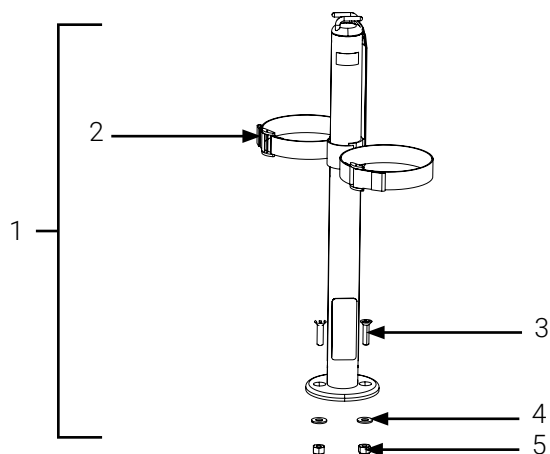

1. Techni-IV pole	3. Washers (2X)
2. Flat head Philips drive screws ¼ - 20 X 1 in. (2X)	4. Nylon-insert locknuts ¼ - 20 (2X)

**Figure 42:** Techni-IV pole parts

2. Locate the two (2) holes on the mobile structure top plate intended for the installation of the Techni-IV pole (Figure 43 A).
3. Place the Techni-IV pole on the mobile structure top plate aligning the screw holes, then insert the two (2) screws (Figure 43 B).
4. From under the mobile structure top plate, insert a washer and locknut on each screw, then tighten the screws while holding the locknuts using a key 7/16 in. and Philips screwdriver #2 (Figure 43 B).

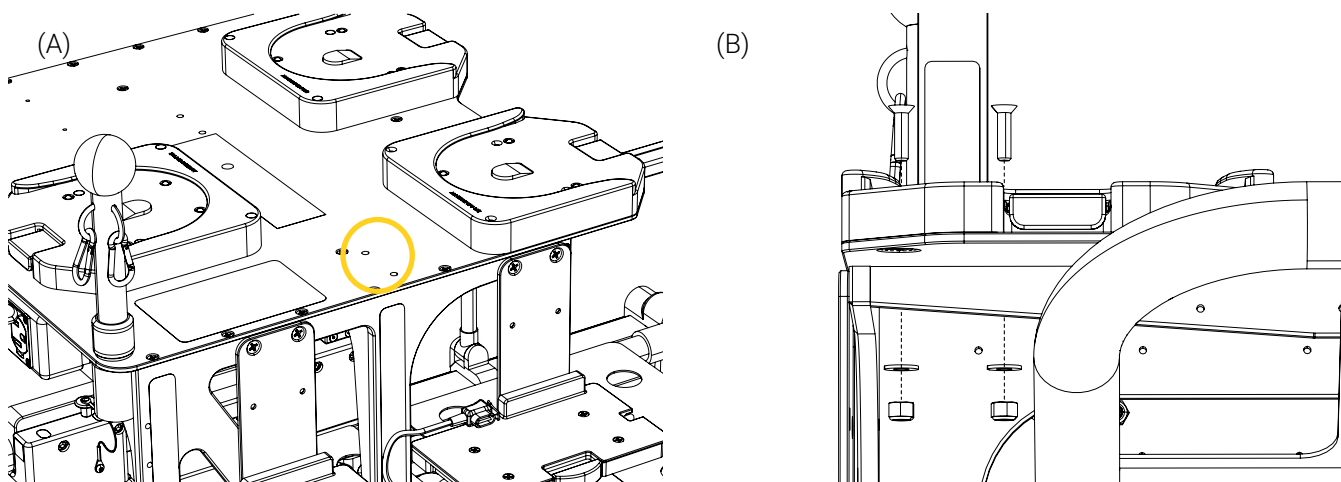

**Figure 43:** Techni-IV pole installation

5. Insert the center loop of the strap on the Techni-IV pole (Figure 44 A).
6. Hook the eyelet at the end of the strap into one of hooks located at the top of the Techni-IV pole to install (Figure 44 B).

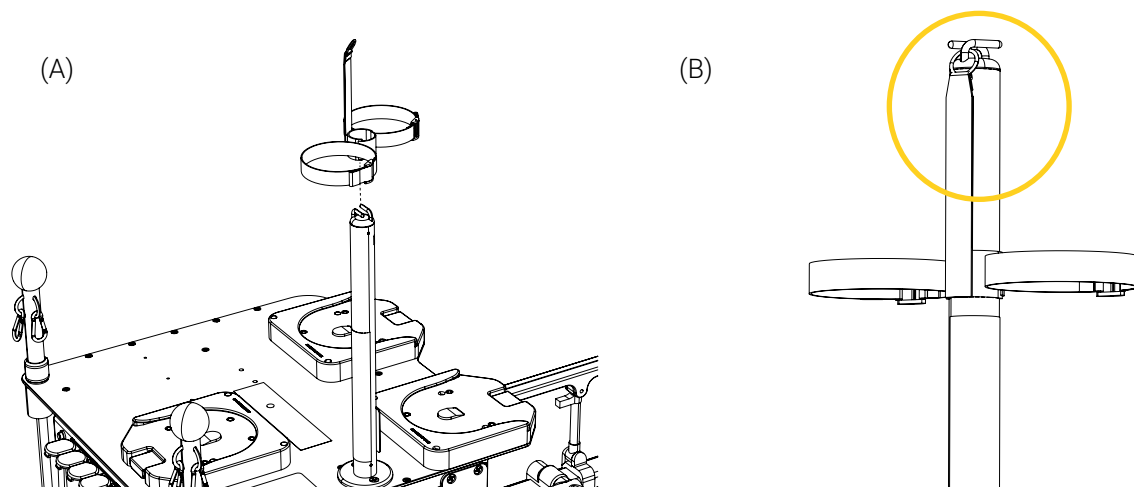

**Figure 44:** Strap installation

7. Use the strap buckles to adjust the size of the strap on the Techni-IV pole, depending on the size of the IV bags used to complete the installation (Figure 45).

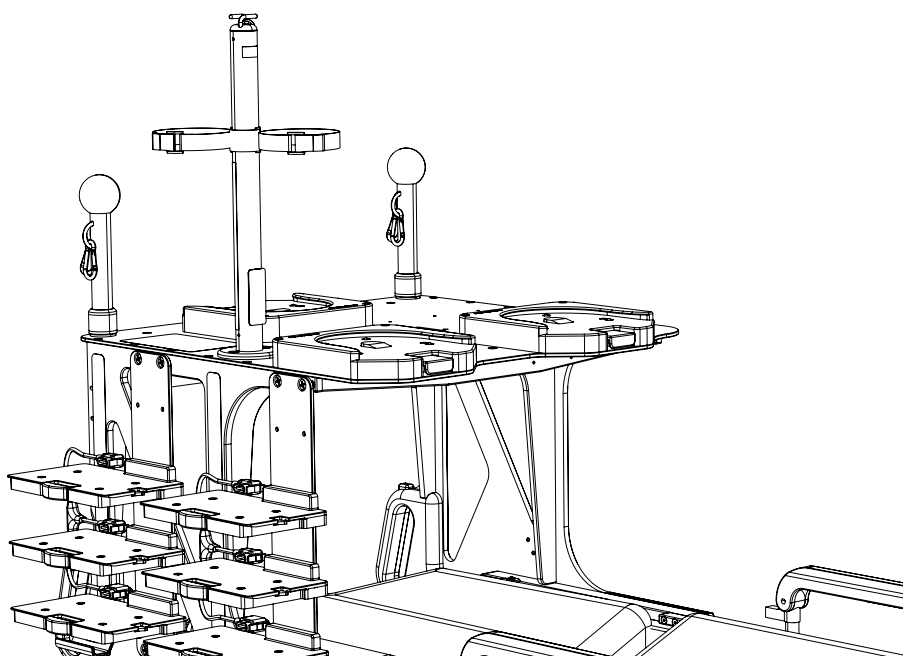

**Figure 45:** Techni-IV pole installed

## 7. Maintenance

Daily safety checks (refer to the Xtension Pro Assistant - CCT/ECMO Operating Guide) and a condition-based maintenance plan (section 7.2) are required and should be established for all Technimount devices. Factors such as weather, environment, geographical location and individual usage will necessitate different needs. For the maintenance of the Xtension Pro Assistant - CCT/ECMO, follow the guidelines listed in the user manual, operating guide and in accordance with your service's current maintenance practices and protocols.

**NOTE:** Always keep records of your all maintenance activities and immediately remove defective or expired products from your inventory.

Please contact Technical Support at [techsupport@technimount.com](mailto:techsupport@technimount.com) for replacement parts or repair related issues.



### **WARNING** - General Warning

- **Do not** perform maintenance on Technimount products, before receiving proper training.
- Perform maintenance operations, as described in this user manual. Failing to follow the recommended maintenance plan or its guidelines could cause premature damage to the product.
- Use only Technimount parts, maintenance procedures, cleaning solutions and lubricants, as described in this user manual. Using unapproved modified parts or procedures for the installation, operation, or maintenance of the Technimount product may cause the device to be unstable and could cause injury to the patients or EMS personnel and void the product warranty.
- Replace damaged or worn-out parts if past their expected service life or when damaged (refer to the Technical Specifications in Chapter 3 of this user manual). Recycle damaged parts or dispose according to the environmental laws that apply to your jurisdiction and consult the safety data sheets (SDS).



### **WARNING** - Part Breakage

**Do not** use powered tools to screw the hardware during installation, as there is a potential risk of damage to the threads. All the provided hardware has been previously prepped with thread locking adhesive and is ready to be used as is.



### **CAUTION** - Safe Handling and Operation

- **Do not** steam clean or use ultrasonic cleaners on the system or any of its components.
- **Do not** immerse the metal parts/components in water.
- To spot clean, the maximum water temperature should not exceed 180° F/82° C. The maximum water pressure should not exceed 1500 psi/103.5 BAR. If using a pressure washer to clean the unit, the pressure nozzle must be kept a minimum of 24 in. (61 cm) from the unit.
- Always rinse and dry the mounting systems properly after using cleaning products. Certain types of cleaners may leave a corrosive residue on the surface of the product and could cause the premature corrosion of critical components. Refer to the product Safety Data Sheets (SDS) for chemical information or handling, storage and emergency measures in case of accident.

**CAUTION - Corrosion**

- Some cleaning products are corrosive in nature and may cause damage to the product if used improperly. When cleaning, always use appropriate personal protection device (PPE) based on established protocols (e.g., gloves, eyewear, etc.).
- Dispose of corrosive wastes according to the environmental laws that apply to your jurisdiction and consult the safety data sheets (SDS).

**7.1. Required Tools**

- Clean dry cloth
- Soft brush
- Power washer
- Sodium Thiosulfate solution
- Silicone based lubricant

**7.2. Condition-Based Maintenance Plan**

Condition-based maintenance is carried out by the maintenance supervisor when the safety checks have revealed underlining issues that need immediate attention and/or to prolong the longevity of the system in optimal conditions. The maintenance supervisor should perform condition-based maintenance minimally every three (3) months, or when required. In case of a non-conformity, stop using the product and contact Technical Support at [technicalsupport@technimount.com](mailto:technicalsupport@technimount.com) immediately for a remedial action plan.

CONDITION-BASED MAINTENANCE		DONE	
TASKS		YES	NO
<b>Safety Checks</b>		<input type="checkbox"/>	<input type="checkbox"/>
Perform the safety checks (refer to the Xtension Pro Assistant - CCT/ECMO Operating Guide) to get an overview of the system's current condition.			
<b>Clean the System</b>		<input type="checkbox"/>	<input type="checkbox"/>
<ol style="list-style-type: none"> <li>1. If needed, rough clean the ball-bearings using a soft brush to remove grease and dirt.</li> <li>2. Remove the contaminants collected during the use of the product using a power washer.</li> <li>3. Clean using a solution of 0.13 oz/3.70 ml Sodium Thiosulfate in 1 pt./0.5 L of warm water. For stains, allow the system to soak or allow the solution to stand on the surface. <b>NOTE:</b> Avoid over saturation and ensure that the product does not stay wet longer than the cleaner's manufacturer guidelines for proper disinfecting.</li> <li>4. Thoroughly rinse with clean water, then towel dry all the components before returning to service.</li> </ol>			

Comments and observations:

## 8. Spare Parts

Technimount reserves the right to change part numbers and products without notice. Please contact Customer Service at [customerservice@technimount.com](mailto:customerservice@technimount.com) to ensure product options and availability, or Technical Support at [techsupport@technimount.com](mailto:techsupport@technimount.com) for replacement parts or repair related issues.

PART/KIT NUMBER	PART/KIT DESCRIPTION
1650-10-PFXT-EC	Xtension Pro Assistant - CCT - Mobile structure - ECMO
1620-11-PFXT-RHS	Xtension Pro Assistant - CCT - Complete clamp block assembly (right)
1620-11-PFXT-LFS	Xtension Pro Assistant - CCT - Complete clamp block assembly (left)
1620-14-PFXT-FPB	Xtension Pro Assistant - CCT – 2 head-end push bar kits including clamp blocks, push bars, aluminum collars, plastic rings, screws and carabiners
1620-15-PFXT-BPB	Xtension Pro Assistant - CCT – 2 mobile structure push bar kits including support blocks, push bars, aluminum collars, plastic rings, screws and carabiners
1620-16-PFXT-BXIQ-GR3	Xtension Pro Assistant - CCT - Baxter Spectrum® IQ 3-pump bracket
1620-17-PFXT-BBRK-GR3	Xtension Pro Assistant - CCT - B. Braun Infusomat® Space®/Perfusor® Space® 3-pump bracket
1620-18-PFXT-IV	Xtension Pro Assistant - CCT - Techni-IV pole
860-00-IV-HLD	IV Techni-Holder for IV bag
989-00-PFXT	Stainless steel carabiner for push bars (qty 1)
981-00-PFXT	Screw caps for clamp block (kit of 16 caps)
982-00-PFXT	Lock pin with wire rope lanyard and screw
100-20-UN	Standard Surface Base
3000-00-PS-607-INV	Medical grade power bar with surge protection, 7 ft cord
100-12-XZ-HD	Technimount Bracket Pro Serie® ZOLL X Series®
700-12-HMSD	Technimount Bracket Pro Serie® HAMILTON-T1™
2410-10-MQCH	Technimount Bracket Pro Serie® Getinge Cardiohelp™ System
Contact Customer Service	Technimount Bracket Pro Serie® mounting systems







# TECHNIMOUNT

EMS™

Technimount EMS offers mounting solutions that can be installed on ambulance counters, walls and stretchers which allows for the device to follow the patient throughout the continuum of care. Our unparalleled level of flexibility allows for maximum operability in EMS, hospital and military environments.

Technimount EMS is driven to offer innovative solutions that respond to the unique device management needs of emergency and Critical Care Transport (CCT) teams for ground and air ambulances. Safety is at the core of our values, all Technimount systems are tested in compliance with the highest industry standards for impact resistance. Technimount EMS is committed to developing innovative solutions as healthcare practices evolve.

**TECHNIMOUNT E.M.S. HOLDING INC.**

3770 Jean Marchand Street, Suite 100-C  
Quebec (QC) G2C 1Y6  
Canada  
T + 1 581.700.6613  
TF + 1 888.639.2758 (North America)

**[technimount.com](http://technimount.com)**