



TECHNIMOUNT
EMS™

TECHNI-HARNESS

OPERATING GUIDE

**SAFETY AND FLEXIBILITY
WHERE IT MATTERS MOST**



Copyrights

Copyright 2023 Technimount E.M.S. Holding Inc. (Technimount EMS) is an affiliated company of Technologies CGC Inc. All Rights Reserved. No part of this publication may be reproduced, transmitted, transcribed, stored in a retrieval system, translated in any language, modified in any form or by any means, without the written permission of Technimount or its affiliate companies.

Trademarks

- Technimount EMS™ is a trademark of Technologies CGC Inc.
- Power-PRO™ is a trademark of Stryker Corporation.

Product and medical equipment manufacturer names are Trademarks™ or Registered Trademarks® of their respective holders. Technimount does not have a commercial relationship with these medical equipment manufacturers.

For any issues with your Technimount product, its components, or for any technical questions during the installation, operation, or maintenance, please contact Technical Support at techsupport@technimount.com.

Contact Information

Technimount E.M.S. Holding Inc.

C/O: Regulatory Affairs

3770 Jean Marchand Street, Suite 100-C

Quebec (QC) G2C 1Y6

Canada

customerservice@technimount.com

techsupport@technimount.com

legal@technimount.com

www.technimount.com

T + 1 581.700.6613

TF + 1 888.639.2758

Table of Contents

| | |
|---|-----------|
| Copyrights | ii |
| Trademarks | ii |
| Contact Information | ii |
| 1. Safety Guidelines..... | 4 |
| 2. Operate the Techni-Harness..... | 5 |
| 2.1. Install a Type D or E Gas Cylinder in the Techni-Harness | 5 |
| 2.2. Install the Techni-Harness on the Power-PRO XT Siderail..... | 6 |
| 2.3. Remove the Techni-Harness from the Power-PRO XT Siderail..... | 8 |
| 3. Perform the Daily Safety Checks | 9 |
| 3.1. Required Tools..... | 9 |
| 3.2. Daily Safety Checks | 9 |
| 3.3. Illustrated Inspections Points | 11 |

1. Safety Guidelines



WARNING - General warning

- **Do not** perform safety checks on Technimount products, before receiving proper training.
- Perform the safety checks, as prescribed in this operating guide. Failing to follow the recommended guidelines could cause premature damage to the product.



CAUTION - Safe handling and operation

- This device is intended to support a gas cylinder during intra-hospital transport. This product is NOT intended to secure a gas cylinder during ambulance transport.
- This device allows for horizontal use of small size gas cylinders. Per OSHA and safety regulations, this position is not adequate for use with liquefied gas.
- This mounting solution is intended for horizontal installation; one (1) gas cylinder per siderail.
- Improper use of the Technimount product may damage the equipment or cause injury to the patients or EMS personnel.



CAUTION - Safe practice

- Always pay close attention to the condition of the safety mechanisms and fixation points, to prevent undue risk to the equipment, patients and EMS personnel. Follow the recommended guidelines prescribed in this document.
- Keep this document with the product at all times.



CAUTION - Working load/Load balance

The Safe Working Load (SWL) is 10 lbs (4.5 kg). Do not overload the system.



CAUTION - Follow instructions for use

- Always read and abide by all the safety guidelines identified, as well as follow the instructions provided within this document.
- Refer to the manufacturer's user manual for safety precautions and user instructions for the safe use of the Type E or D gas cylinder.
- Refer to the stretcher's user manual for safety precautions and user instructions for the safe use of the Stryker Power-PRO XT.

2. Operate the Techni-Harness

This Operating Guide is used to help EMS personnel effectively use the Techni-Harness to safely handle and transport type D or E gas cylinders horizontally on the Stryker Power-PRO XT stretcher siderail during intra-hospital transfers. For detailed product information that is not user related, refer to your supervisor or the user manual when required.

NOTE: Always perform the Safety checks BEFORE using the Techni-Harness. Refer to the "Daily Safety Checks" on page 9 for before each use.

NOTE: Technimount continually seeks advancements in product design and quality. While this operating guide contains the most updated product information available at the time of printing, it may contain minor differences with the current version. For more information, please contact Customer Service at customerservice@technimount.com.

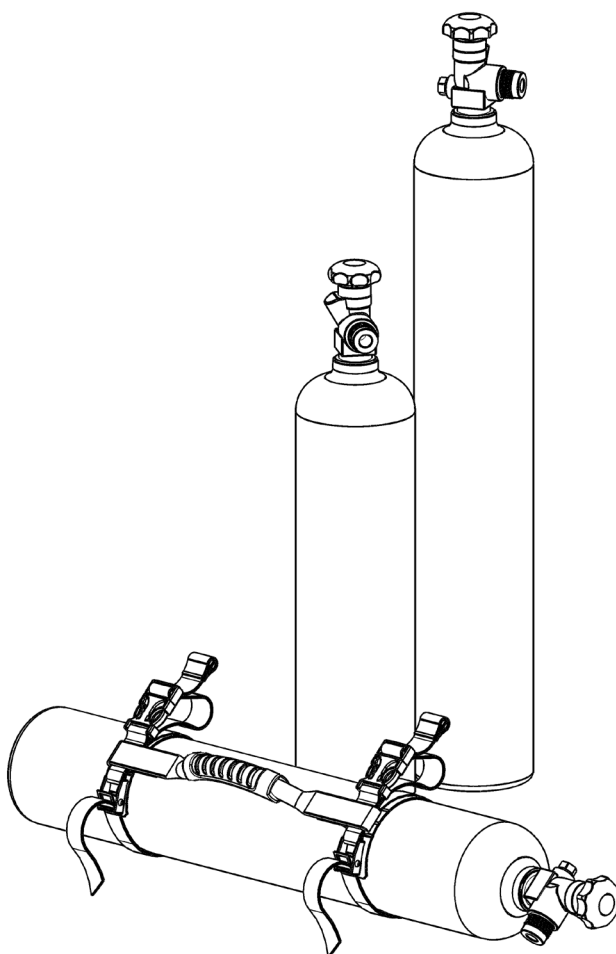

Figure 1: Techni-Harness for type D or E gas cylinders

2.1. Install a Type D or E Gas Cylinder in the Techni-Harness

1. Insert the bottom-end of the gas cylinder through the loops of the harness. If needed, enlarge the loops by pressing down on the cam buckle lever and pulling on the straps to loosen (Figure 2).
2. Center the harness on the gas cylinder (Figure 2).
3. Tighten the first strap loop over the tank by pushing down on the cam buckle lever, then pulling the strap until the strap loop is tight around the gas cylinder (Figure 2).
4. Repeat with the second strap loop (Figure 2).

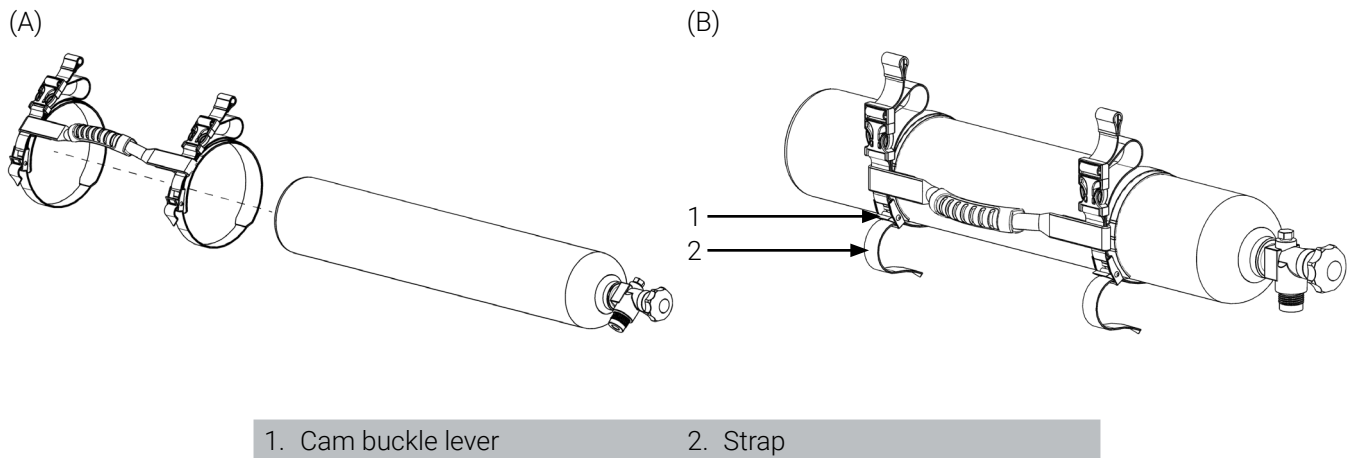

Figure 2: Installing the gas cylinder in the Techni-Harness

2.2. Install the Techni-Harness on the Power-PRO XT Siderail

1. If needed, open the side release buckles of the harness by pinching the sides of the male-end of the buckle to free it from the female side of the buckle (Figure 3).

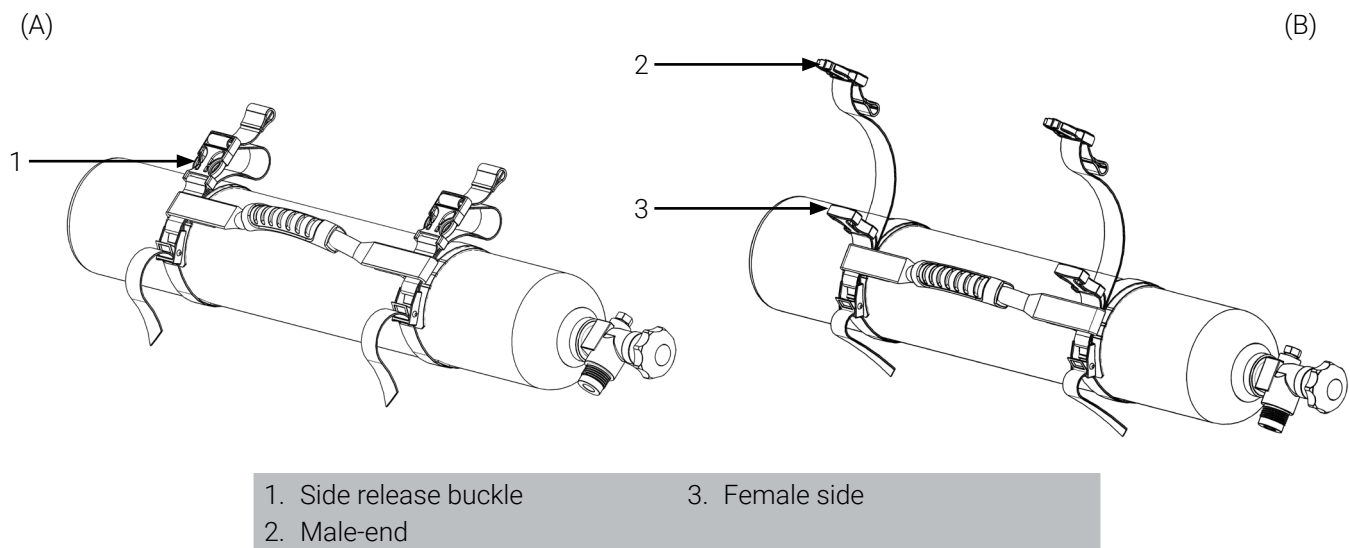
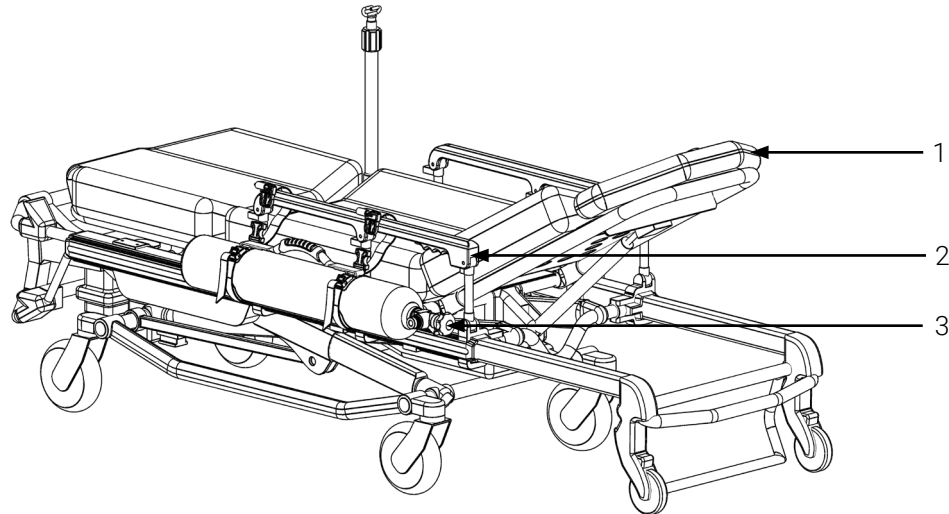

Figure 3: Installing the Techni-Harness on the stretcher siderail (1 of 4)

2. Firmly hold and lift the gas cylinder using the harness handle, then bring it next to the stretcher (Figure 4).

NOTE: The head-end of the gas cylinder must face the head-end of the stretcher (Figure 4) when installed.



- | | |
|------------------------------|---------------------------------|
| 1. Head-end of the stretcher | 3. Head-end of the gas cylinder |
| 2. Siderail | |

Figure 4: Installing the Techni-Harness on the stretcher siderail (2 of 4)

3. Wrap one of the side release buckles under and over the stretcher siderail, then insert the male-end of the buckle in the female side of the buckle to attach both ends (Figure 5).
4. Repeat with the second side release buckle (Figure 5).

(A)

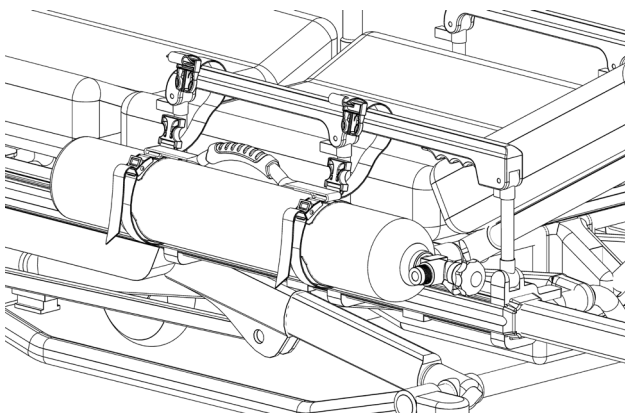

(B)

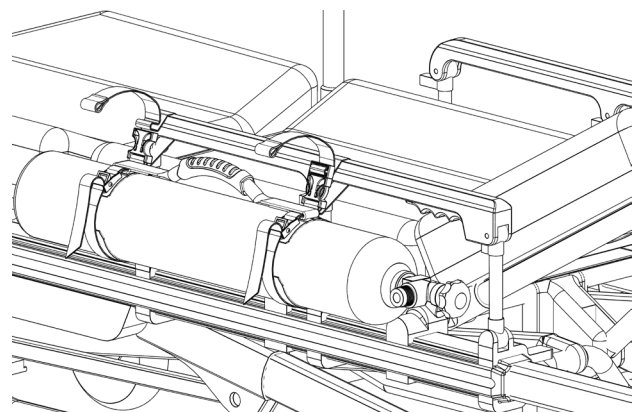

Figure 5: Installing the Techni-Harness on the stretcher siderail (3 of 4)

5. Pull the harness handle upwards a few times to make sure the installation is secure, then release the handle.

6. Pull on the loose ends of the side release buckle straps (Figure 6) to adjust the tension tightly against the stretcher siderail to complete the installation.

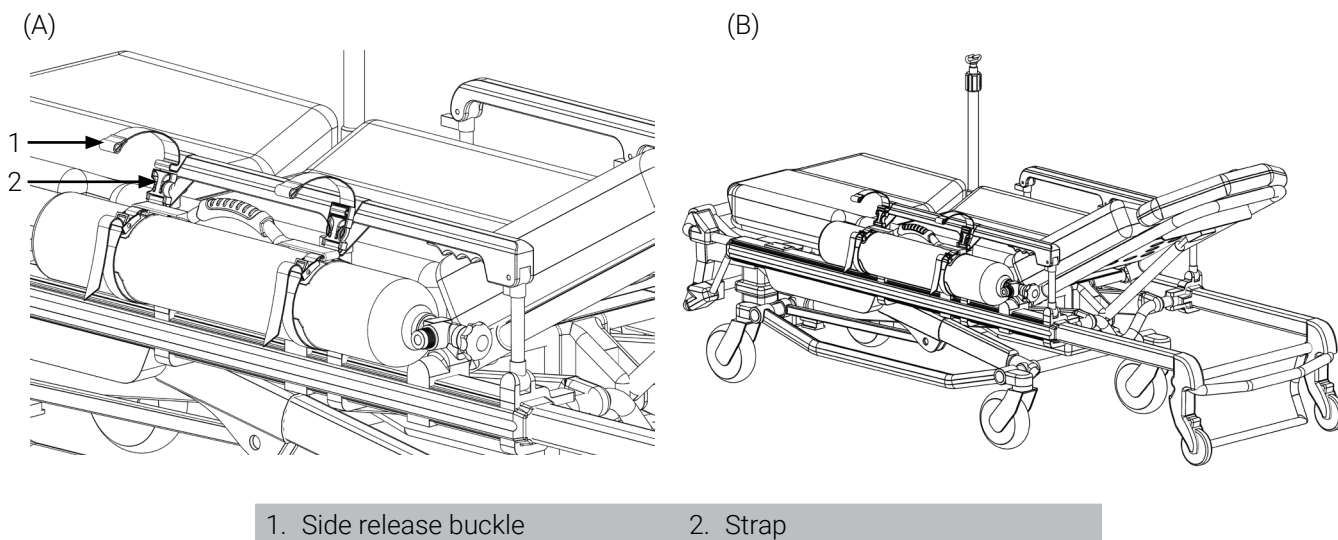

Figure 6: Installing the Techni-Harness on the stretcher siderail (4 of 4)

2.3. Remove the Techni-Harness from the Power-PRO XT Siderail

1. Firmly hold the harness handle with one hand.
2. With the other hand, pinch the sides of the male-end of the side release buckle to free it from the female side of the buckle.
3. Repeat with the second side release buckle.

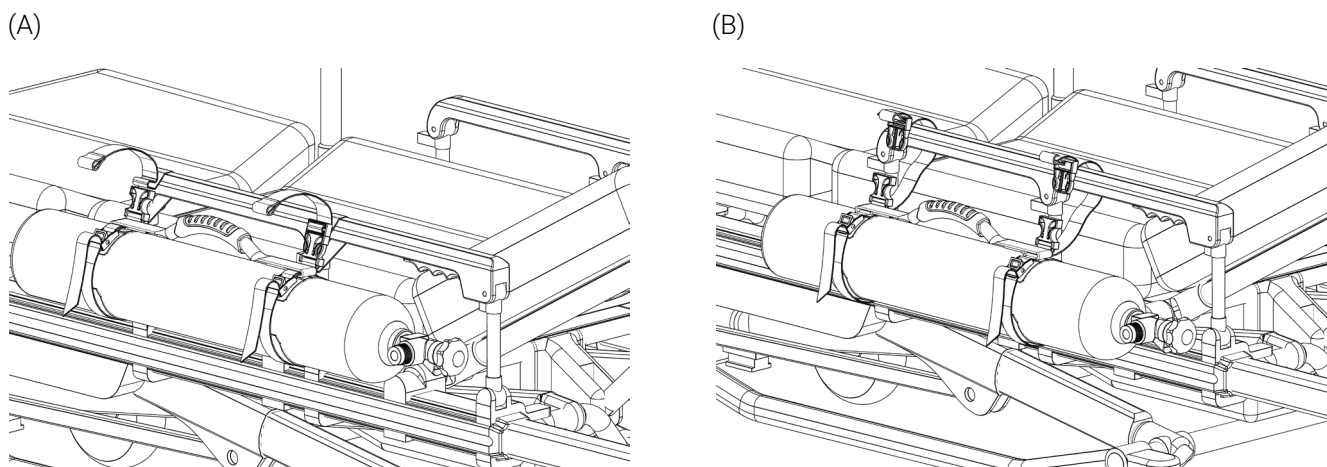

Figure 7: Removing the Techni-Harness from the stretcher siderail

4. Set aside the gas cylinder on the stretcher or a clean flat surface.

3. Perform the Daily Safety Checks

Daily safety checks on Technimount products are recommended to keep them in good condition and avoid failure or injury to the patient or EMS personnel. EMS personnel should perform the daily safety checks at the beginning of each work shift.

NOTE: Always keep records of your all maintenance activities and immediately remove defective or expired products from your inventory.

Please contact Technical Support at techsupport@technimount.com for replacement parts or repair related issues.

3.1. Required Tools

- Clean dry cloth

3.2. Daily Safety Checks

Refer to the illustrated inspection points (Figure 8), if needed.

NOTE: In case of a non-conformity, alert the maintenance supervisor of all non-compliances and immediately cease use.

| DAILY SAFETY CHECKS | | COMPLIANT | |
|---|--|--------------------------|--------------------------|
| INSPECTIONS | | YES | NO |
| Techni-Harness (Figure 8) | | | |
| - Visually inspect the harness to ensure that the handle, strap and seams are in good condition. | | <input type="checkbox"/> | <input type="checkbox"/> |
| Cam buckles (Figure 8) | | | |
| - Visually inspect the components of each buckle to ensure there is no damage or chemical attack and that the hardware is in good condition. | | <input type="checkbox"/> | <input type="checkbox"/> |
| - Ensure there are no particles lodged in the buckles. If so, immediately remove using a clean dry cloth. | | <input type="checkbox"/> | <input type="checkbox"/> |
| - Inspect the lever of each cam buckle; push down on the lever and pull the strap, then release the lever and pull the strap again to ensure proper functioning. If the locking mechanism is defective, immediately cease using the harness and alert the maintenance supervisor. | | <input type="checkbox"/> | <input type="checkbox"/> |
| Side release buckles (Figure 8) | | | |
| - Visually inspect the components of each buckle to ensure there is no damage or chemical attack and that the hardware is in good condition. | | <input type="checkbox"/> | <input type="checkbox"/> |
| - Ensure there are no particles lodged in the buckles. If so, immediately remove using a clean dry cloth. | | <input type="checkbox"/> | <input type="checkbox"/> |
| - Inspect the side release of each buckle; pinch the side of the male-end of the buckle to free it from the female side of the buckle, then insert the male-end in the female side of the buckle to ensure proper functioning. If the locking mechanism is defective, immediately cease using the harness and alert the maintenance supervisor. | | <input type="checkbox"/> | <input type="checkbox"/> |



COMPLIANT

Daily Safety Checks completed on (dd/mm/yyyy) , by

Comments and observations:

3.3. Illustrated Inspections Points

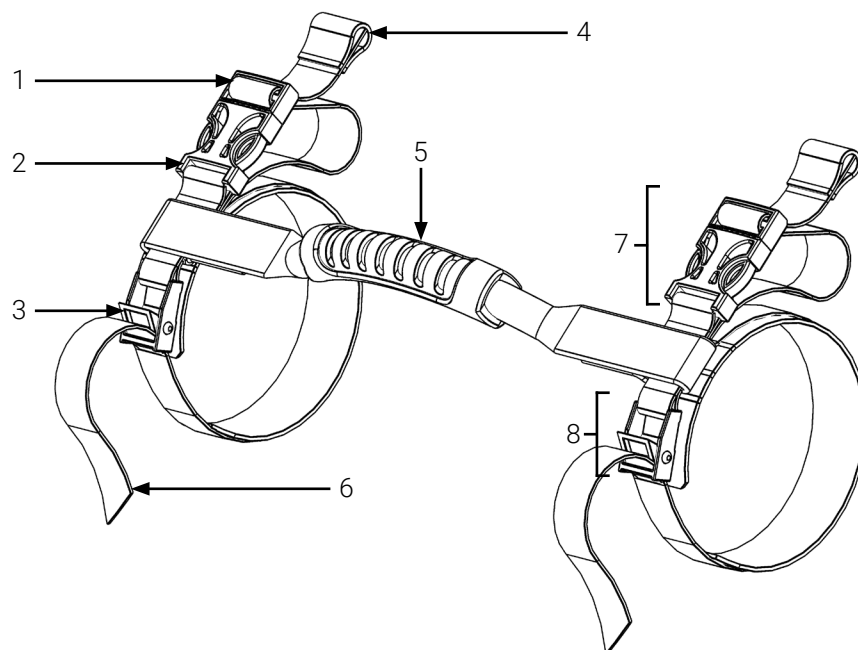

- | | |
|---|--------------------------------|
| 1. Male-end of the side release buckle | 4. Strap (side release buckle) |
| 2. Female side of the side release buckle | 5. Handle |
| 3. Cam buckle lever | 6. Strap (cam buckle) |
| | 7. Side release buckle |
| | 8. Cam buckle |

Figure 8: Techni-Harness inspection points



TECHNIMOUNT

EMS™

Technimount EMS offers mounting solutions that can be installed on ambulance counters, walls and stretchers which allows for the equipment to follow the patient throughout the continuum of care. Our unparalleled level of flexibility allows for maximum operativity in EMS, hospital and military environments.

Technimount EMS is driven to offer innovative solutions that respond to the unique device management needs of emergency and Critical Care Transport (CCT) teams for ground and air ambulances. Safety is at the core of our values, all Technimount systems are tested in compliance with the highest industry standards for impact resistance. Technimount EMS is committed to evolving its solutions as healthcare practices evolve.

TECHNIMOUNT E.M.S. HOLDING INC.

3770 Jean Marchand Street, Suite 100-C
Quebec (QC) G2C 1Y6
Canada
T + 1 581.700.6613
TF + 1 888.639.2758

technimount.com

